

NOTES:

BASED ON THE CONFIRMED GROUNDWATER IMPACT IN THE PROJECT AREA, ANY DEWATERING ACTIVITIES THAT MAY OCCUR WITHIN THE KNOWN EXTENTS OF DISSOLVED HYDROCARBONS HAS THE POTENTIAL TO DRAW CONTAMINATION FROM AN OFF-SITE/ON-SITE SOURCE. IF DEWATERING IS REQUIRED, URS CORPORATION RECOMMENDS A GROUNDWATER SAMPLE SHALL BE COLLECTED PRIOR TO START-UP OF DEWATERING ACTIVITIES IN ORDER TO EVALUATE PERMITTING OPTIONS AND TO DETERMINE PROPER DISPOSAL METHODS FOR THE DISCHARGED GROUNDWATER...

- THE CONTRACTOR IS RESPONSIBLE FOR THE PROPER DISPOSAL OF CONTAMINATED GROUNDWATER, IF ENCOUNTERED.

- UNDER NO CIRCUMSTANCES SHALL CONTAMINATED GROUNDWATER BE DISCHARGED TO STORM SEWERS, SURFACE WATERS OR WETLANDS PRIOR TO ADEQUATE TREATMENT.

- FOR CONTAMINATION CONCENTRATIONS AT THE MONITORING WELL LOCATIONS, PLEASE SEE REPORT PROVIDED BY URS CORPORATION (ANY QUESTIONS PLEASE CONTACT URS CORPORATION-JACKSONVILLE AT (904)281-9251).

- THE CONTRACTOR IS RESPONSIBLE FOR REVIEWING THE ST. JOHNS RIVER WATER MANAGEMENT DISTRICT (SJRWMD) PERMIT (PERMIT NO. 42-031-37252-2) PRIOR TO CONSTRUCTION AND SHALL ADHERE TO ALL CONDITIONS WITHIN THE PERMIT AS WELL AS ALL RULES AND REGULATIONS SET FORTH BY THE SJRWMD.

- THE CONTRACTOR SHALL COORDINATE WITH URS CORPORATION FOR THE REMOVAL, RELOCATION AND/OR PRESERVATION OF THE EXISTING ONSITE MONITORING WELLS DURING CONSTRUCTION.

LEGEND

- X TREES TO BE REMOVED
□ TREES TO REMAIN

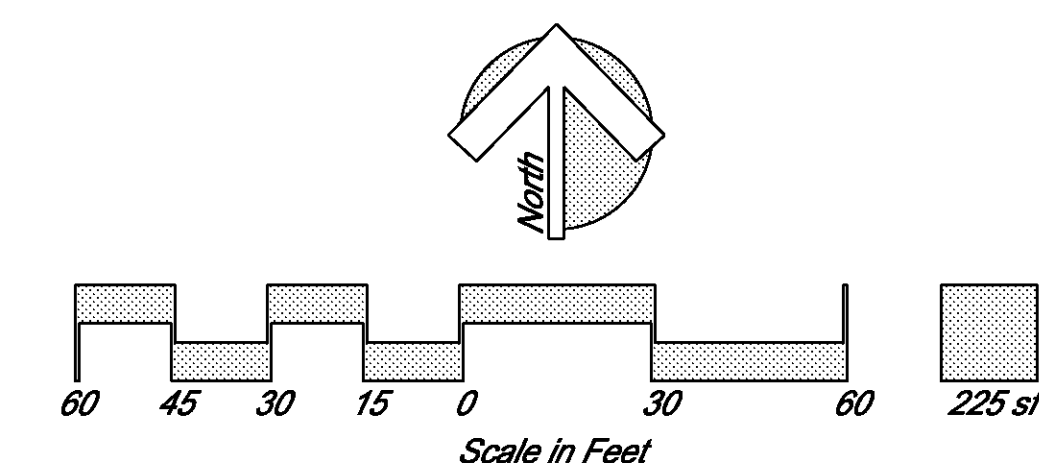

UTILITIES

- 1. CONTRACTOR SHALL COORDINATE WITH JEA FOR ON-SITE OVERHEAD ELECTRIC LINE AND UTILITY POLE REMOVAL OR RELOCATION. JEA CONTACT - GABOR ACS AT (904) 665-7728.
2. CONTRACTOR SHALL COORDINATE WITH JEA FOR ANY RELOCATION OF ANY EXISTING WATER METERS.
3. UNDERGROUND UTILITIES, INCLUDING POTABLE WATER, GRAVITY SEWER, FORCE MAIN, AND STORM WATER PIPING, DO EXIST ON THIS SITE...

SITE DEMOLITION AND CLEARING

- 1. CLEAR AND GRUB THE SITE AREAS SHOWN IN THE PLANS TO BE CLEARED AND GRUBBED. REMOVE AND DISPOSE OF ALL TREES, STUMPS, ROOTS AND OTHER SUCH PROTRUDING OBJECTS, BUILDINGS, STRUCTURES, APPURTENANCES, EXISTING FLEEBLE AND RIGID ASPHALT PAVEMENT, AND OTHER FACILITIES NECESSARY TO PREPARE THE AREA FOR THE PROPOSED CONSTRUCTION.
2. IN ALL BUILDING FOOTPRINT AND HARDSCAPE AREAS THE CONTRACTOR SHALL REMOVE ROOTS, OTHER DEBRIS, AND ORGANIC SOILS TO A DEPTH OF 12 INCHES BELOW THE GROUND SURFACE OR AS DIRECTED BY THE GEOTECHNICAL ENGINEERING CONSULTANT...

REMOVAL OF BUILDINGS AND EXISTING STRUCTURES

- 1. THE CONTRACTOR SHALL NOTIFY THE FLORIDA DEPARTMENT OF ENVIRONMENTAL PROTECTION (FDEP) USING FDEP FORM 62-257 900(1) "NOTICE OF ASBESTOS RENOVATION OR DEMOLITION" AT LEAST 10 WORKING DAYS PRIOR TO THE DEMOLITION OR REMOVAL OF ANY STRUCTURES, EVEN IF ASBESTOS IS NOT FOUND ON THE PROJECT.
2. THE CONTRACTOR SHALL COMPLETELY REMOVE ALL PARTS OF THE BUILDINGS AND EXISTING STRUCTURES, INCLUDING UTILITIES, PLUMBING, FLOORING, STAIRS, CONCRETE SIDEWALKS OR OTHER PAVEMENT, SEPTIC TANKS, DRAIN FIELDS AND ANY OTHER APPURTENANCES, BY ANY PRACTICAL MANNER WHICH IS NOT DETRIMENTAL TO OTHER PROPERTY AND IMPROVEMENTS...

UNIDENTIFIED AREAS OF CONTAMINATION

- 1. WHEN ENCOUNTERING OR EXPOSING ANY ABNORMAL CONDITION INDICATING THE PRESENCE OF A HAZARDOUS OR TOXIC WASTE, OR CONTAMINANTS, CEASE OPERATIONS IMMEDIATELY IN THE VICINITY AND IMMEDIATELY NOTIFY THE OWNER AND THE ENGINEER.
2. MAKE EVERY EFFORT TO MINIMIZE THE SPREAD OF CONTAMINATION INTO UNCONTAMINATED AREAS. IMMEDIATELY PROVIDE FOR THE HEALTH AND SAFETY OF ALL WORKERS AT THE JOB SITE AND MAKE PROVISIONS NECESSARY FOR THE HEALTH AND SAFETY OF THE PUBLIC...

- 3. IF HAZARDOUS MATERIALS WASTE ARE ENCOUNTERED THEN THE CONTRACTOR SHALL BE RESPONSIBLE FOR HANDLING, TRANSPORT AND DISPOSAL OF THE HAZARDOUS MATERIALS IN ACCORDANCE WITH ALL LOCAL, STATE AND FEDERAL REQUIREMENTS INCLUDING THE FOLLOWING:
(A) SPSC GUIDE
(B) FEDERAL WATER POLLUTION CONTROL ACT AND
(C) RESOURCE CONSERVATION AND RECOVERY ACT (RCRA)...

ASBESTOS CONTAINING MATERIALS (ACM) NOT IDENTIFIED PRIOR TO THE WORK

- 1. WHEN ENCOUNTERING OR EXPOSING ANY CONDITION INDICATING THE PRESENCE OF ASBESTOS, CEASE OPERATIONS IMMEDIATELY IN THE VICINITY AND IMMEDIATELY NOTIFY THE OWNER AND THE ENGINEER.
2. THE CONTRACTOR SHALL MAKE EVERY EFFORT TO MINIMIZE THE DISTURBANCE OF THE ACM. IMMEDIATELY PROVIDE FOR THE HEALTH AND SAFETY OF ALL WORKERS AT THE JOB SITE AND MAKE PROVISIONS NECESSARY FOR THE HEALTH AND SAFETY OF THE PUBLIC...

ABANDONMENT OF ASBESTOS PIPE

- 1. ABANDONMENT OF ASBESTOS PIPING SHALL BE BY GROUT FILLING. WHILE CUTTING ASBESTOS PIPE THE OPERATOR MUST WEAR A HEPA TYPE PARTICLE MASK AND ADHERE TO ALL APPLICABLE SAFETY STANDARDS FOR HANDLING ASBESTOS CONTAINING MATERIAL.
2. THE CONTRACTOR SHALL INITIATE AND MAINTAIN THE FDOT APPROVED MAINTENANCE OF TRAFFIC PLAN AT ALL TIMES WHEN WORK IS OCCURRING WITHIN THE RIGHT-OF-WAY.
3. BITUMINOUS PAVEMENT SHALL BE REMOVED TO CLEAN STRAIGHT LINES BY SAW CUTTING, WHERE BITUMINOUS PAVEMENT ADJOINS A TRENCH, THE EDGES ADJACENT TO THE TRENCH WILL BE TRIMMED TO NEAT STRAIGHT LINES BEFORE RESURFACING TO ENSURE THAT ALL AREAS TO BE RESURFACED ARE ACCESSIBLE TO ROLLERS OR TAMERS USED TO COMPACT THE SUB-GRADE OR PAVING MATERIALS...

NOTE:

CONTRACTOR TO ADHERE TO ALL ASPECTS OF URS CORPORATION DECONTAMINATION GUIDELINES

NOTE:

- 1. EX. PONDS ARE TO BE CLEARED OF ALL MUCK MATERIAL AND FILLED WITH SUITABLE MATERIAL IN MAX. 12" LIFTS COMPACTED TO 95% DENSITY.
2. CONTRACTOR SHALL COORDINATE WITH URS CORPORATION FOR THE REMOVAL/RELOCATION OF ALL EX. MONITORING WELLS ON-SITE.
3. A PORTION OF THIS PROPERTY IS IMPACTED WITH PETROLEUM AND CHLORINATED COMPOUNDS, SOIL AND GROUNDWATER HAVE BEEN IMPACTED. CONTRACTOR(S) SHALL HAVE ANY AND ALL CERTIFICATIONS AND QUALIFICATIONS NECESSARY TO WORK WITH AND HANDLE IMPACTED MEDIA...

CONSTRUCTION SEQUENCE FOR STORMWATER SYSTEM CONSTRUCTION AND DEMOLITION

- 1) REPLACEMENT PIPING AND CONTECH CHAMBERMAXX SYSTEMS (SEE PAVING, GRADING AND DRAINAGE PLAN) MUST BE IN PLACE PRIOR TO THE REMOVAL OF THE EXISTING PONDS (EX. SWMF-1 AND EX. SWMF-2) AND ASSOCIATED STORM PIPE AND DRAINAGE STRUCTURES. FLOODING WILL OCCUR IF THE PROPOSED STORMWATER CONVEYANCE SYSTEM IS NOT IN PLACE.
2) DRAINAGE PATTERNS MUST BE MAINTAINED ONSITE AT ALL TIMES TO ENSURE CONVEYANCE OF STORMWATER TO DESIGNATED TREATMENT FACILITIES AND THAT NO ADVERSE IMPACTS/FLOODING OCCURS ON OFFSITE PROPERTIES.

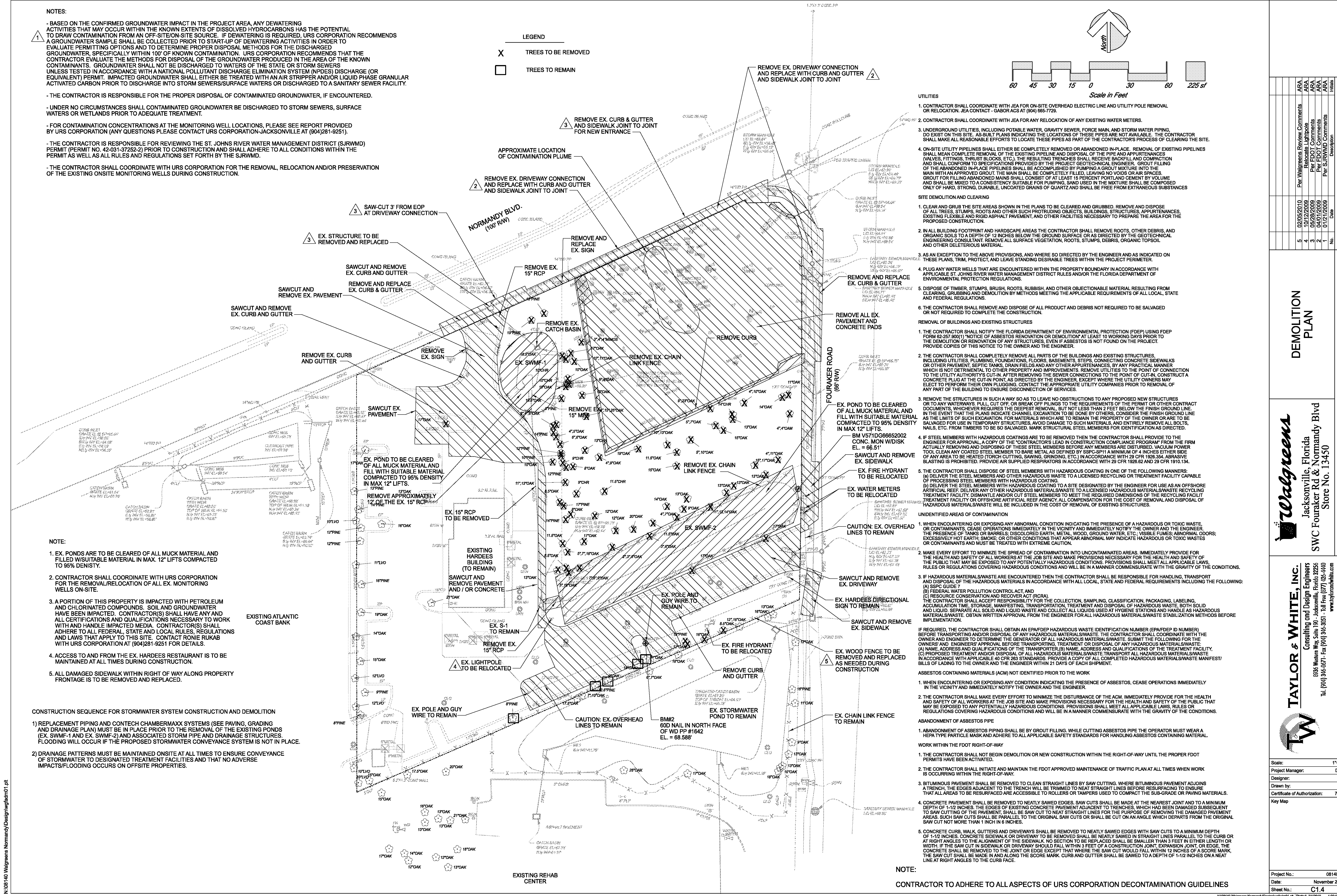

Professional Engineer information, Demolition Plan title, Walgreens logo, Taylor & White, Inc. logo, and project details including scale, manager, designer, and sheet number.