

LEGEND

[Pattern]	STANDARD PAVEMENT SECTION
[Pattern]	STANDARD CONCRETE SECTION
[Pattern]	HEAVY DUTY PAVEMENT SECTION
[Pattern]	HEAVY DUTY CONCRETE SECTION

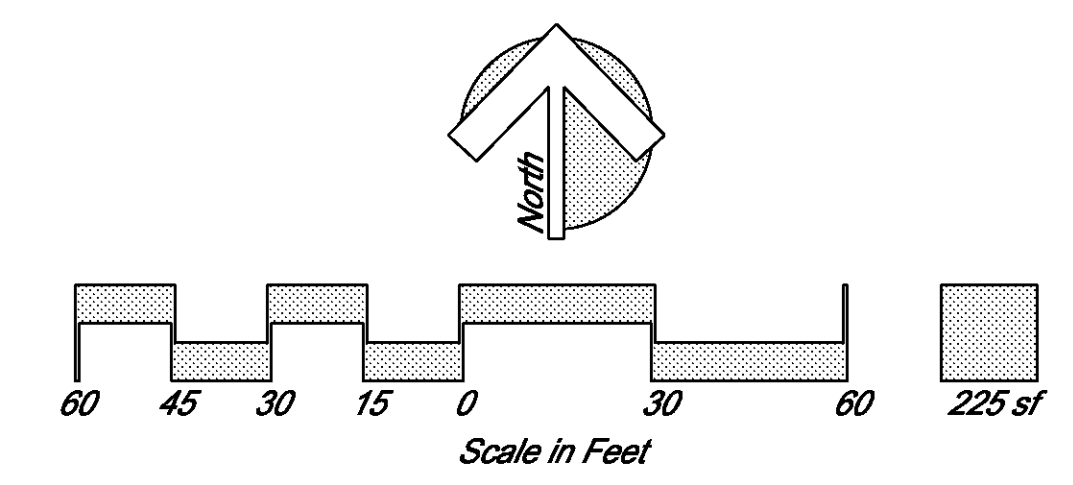

- NOTES:
- 1) USE OF MANUFACTURED SOILS, SANDS, OR FILTER MEDIA IS PROHIBITED FOR UNDERDRAIN BACKFILL.
  - 2) IF INDIGENOUS SOIL IS NOT AVAILABLE IMPORTED FILL MAY BE UTILIZED WITH THE FOLLOWING PARAMETERS:
    - MINIMUM PERCOLATION RATE OF 20 ft/day
- CAUTION: EXISTING UNDERGROUND UTILITIES EXIST WITHIN THE NORMANDY BLVD. AND FOURAKER RD. RIGHT-OF-WAY. CONTRACTOR IS TO PERFORM SOFTSIGGS TO DETERMINE THE EXACT LOCATIONS PRIOR TO PROPOSED CONSTRUCTION. CONTRACTOR SHALL NOTIFY ENGINEER OF RECORD IMMEDIATELY IF ANY DISCREPANCIES ARE FOUND.
- IF GROUNDWATER IS ENCOUNTERED DURING FDOT DRAINAGE CONNECTION CONTRACTOR IS TO CEASE WORK IMMEDIATELY AND PROVIDE A TRENCH BOX AND/OR DEWATERING PLAN.
- FOR ROOF DRAIN CONNECTION AND PIPE INFORMATION REFER TO DRAINAGE PLAN SHEET C2.2.
- △ - SITE LOCATED WITHIN FLOOD ZONE "X"

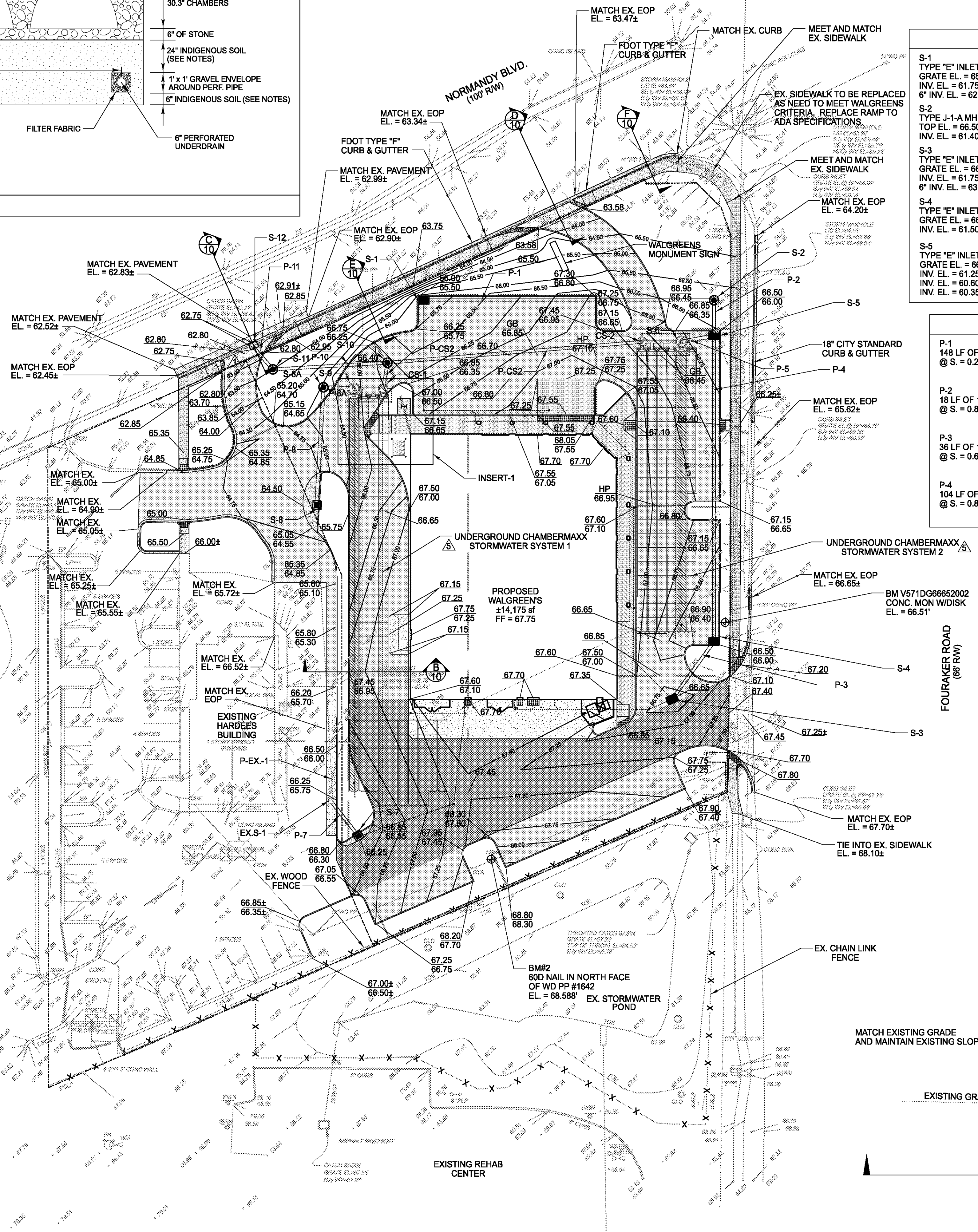

STRUCTURES

S-1 TYPE "E" INLET GRATE EL. = 65.50 INV. EL. = 61.75 6" INV. EL. = 62.75	S-6 MODIFIED J-1-A MH TOP EL. = 66.30 INV. EL. = 60.25 (18")E,W INV. EL. = 60.25 (24")S	S-9 MODIFIED J-1-A MH TOP EL. = 66.00 INV. EL. = 60.25 (18")E INV. EL. = 59.30 (24")W WEIR EL. = 62.10	EX. S-1 EX. GRATE EL. = 65.75 EX. INV. EL. = 62.73 (E) EX. INV. EL. = 62.44 (N) MAINTAIN EX. (N) INVERT PLUG EX. (E) INVERT CORE NEW (S) INVERT INV. EL. = 62.50 (15")S
S-2 TYPE J-1-A MH TOP EL. = 66.50 INV. EL. = 61.40	S-7 36" CURB INLET GRATE EL. = 66.25 6" INV. EL. = 62.60	S-10 TYPE J-1-A MH TOP EL. = 66.40 INV. EL. = 56.10	CS-1 MODIFIED J-1-A MH TOP EL. = 66.25 INV. EL. = 60.25 (18")S,W INV. EL. = 56.20 (15")N INV. EL. = 56.50 (6") UNDERDRAIN 1.50' WEIR EL. = 62.50
S-3 TYPE "E" INLET GRATE EL. = 66.65 INV. EL. = 61.75 6" INV. EL. = 63.00	S-8 36" CURB INLET GRATE EL. = 64.35 INV. EL. = 59.55 (15", 24")	S-11 TYPE J-1-A MH TOP EL. = 63.50± INV. EL. = 55.90	CS-2 MODIFIED J-1-A MH TOP EL. = 66.70 INV. EL. = 60.25 (18")S, E INV. EL. = 56.40 (15")N INV. EL. = 56.50 (6") UNDERDRAIN 1.00' WEIR EL. = 62.60
S-4 TYPE "E" INLET GRATE EL. = 66.00 INV. EL. = 61.50	S-8A TYPE J-1-A MH TOP EL. = 66.00 INV. EL. = 59.40	S-12 (EX. S-2) FDOT TYPE "F" GUTTER INLET GRATE EL. = 62.58 TOP EL. = 66.00 INV. EL. = 55.80 36"(SW) INV. EL. = 55.80 15"(SE) MAINTAIN EX. 36" PIPE INVERTS AT CONNECTION	
S-5 TYPE "E" INLET GRATE EL. = 66.00 INV. EL. = 61.25 (15")N INV. EL. = 60.80 (15")S INV. EL. = 60.35 (18")W			

PIPES

P-1 148 LF OF 15" RCP @ S. = 0.24%	P-5 16 LF OF 18" A2000 @ S. = 0.63%	P-8A 12 LF OF 24" A2000 @ S. = 0.83%	P-11 16 LF OF 15" RCP @ S. = 0.63%
P-2 18 LF OF 15" RCP @ S. = 0.83%	P-7 24 LF OF 15" RCP @ S. = 0.42%	P-CS1 12 LF OF 15" RCP @ S. = 0.83%	
P-3 36 LF OF 15" RCP @ S. = 0.69%	P-EX.1 148 LF OF 15" RCP @ S. = 1.95%	P-CS2 128 LF OF 15" RCP @ S. = 0.23%	
P-4 104 LF OF 15" RCP @ S. = 0.87%	P-8 60 LF OF 24" RCP @ S. = 0.25%	P-10 60 LF OF 15" RCP @ S. = 0.33%	

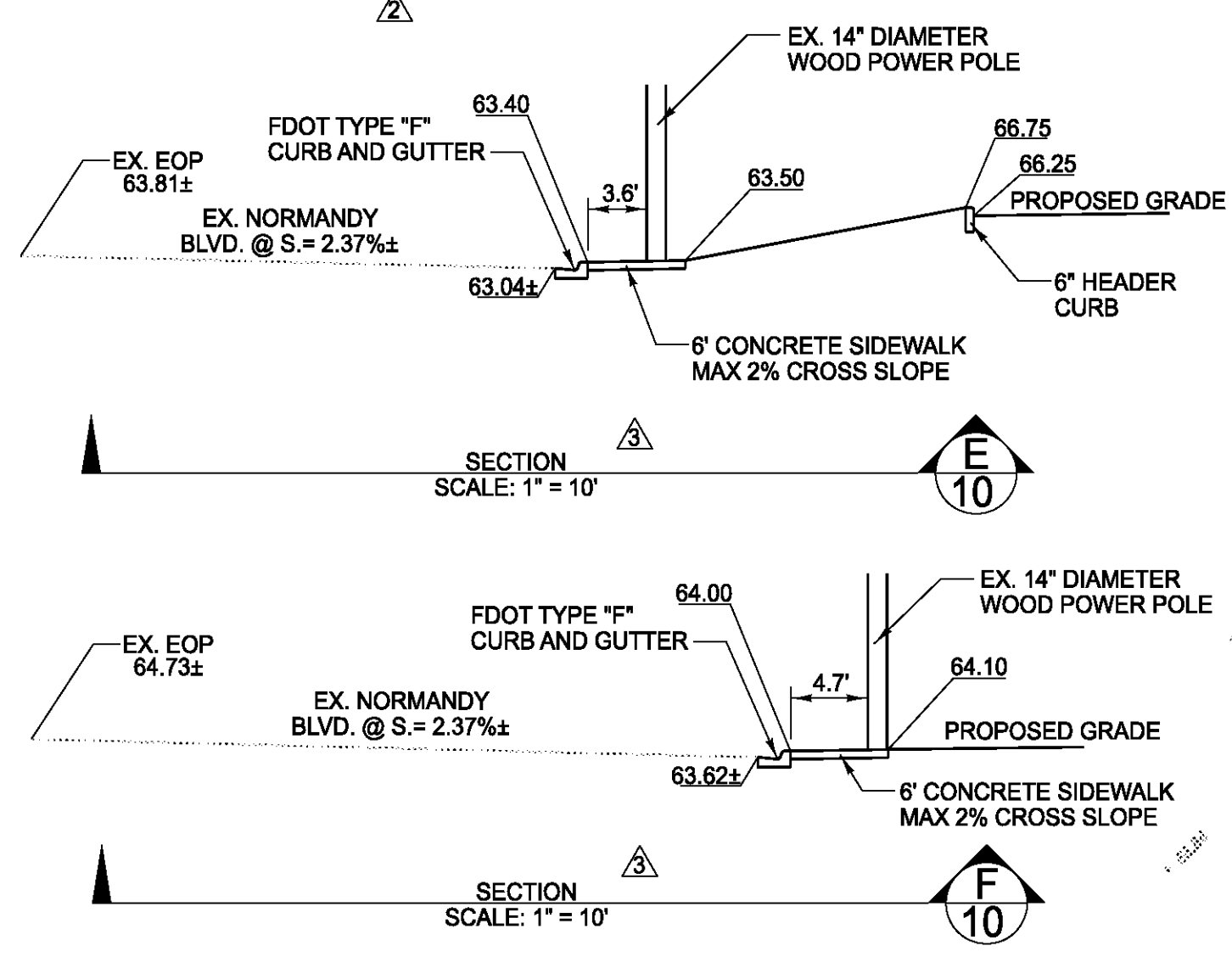
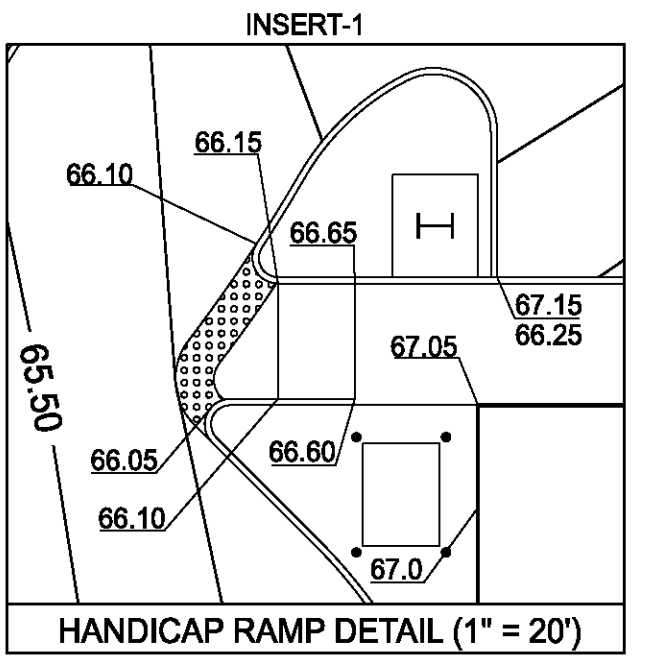
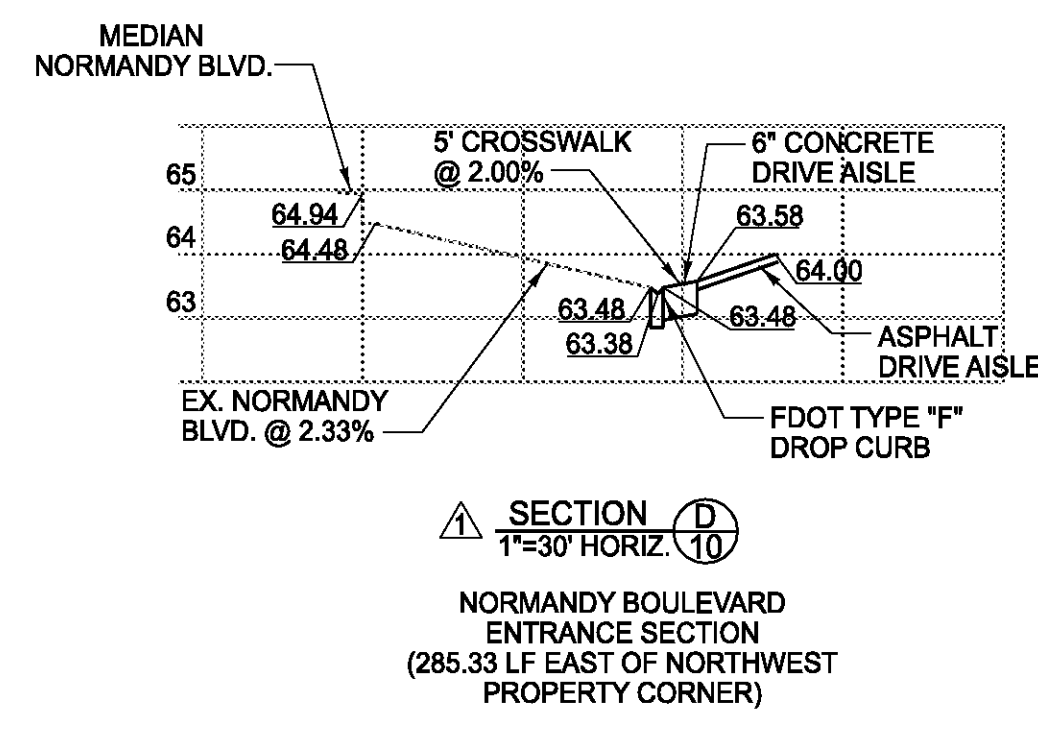
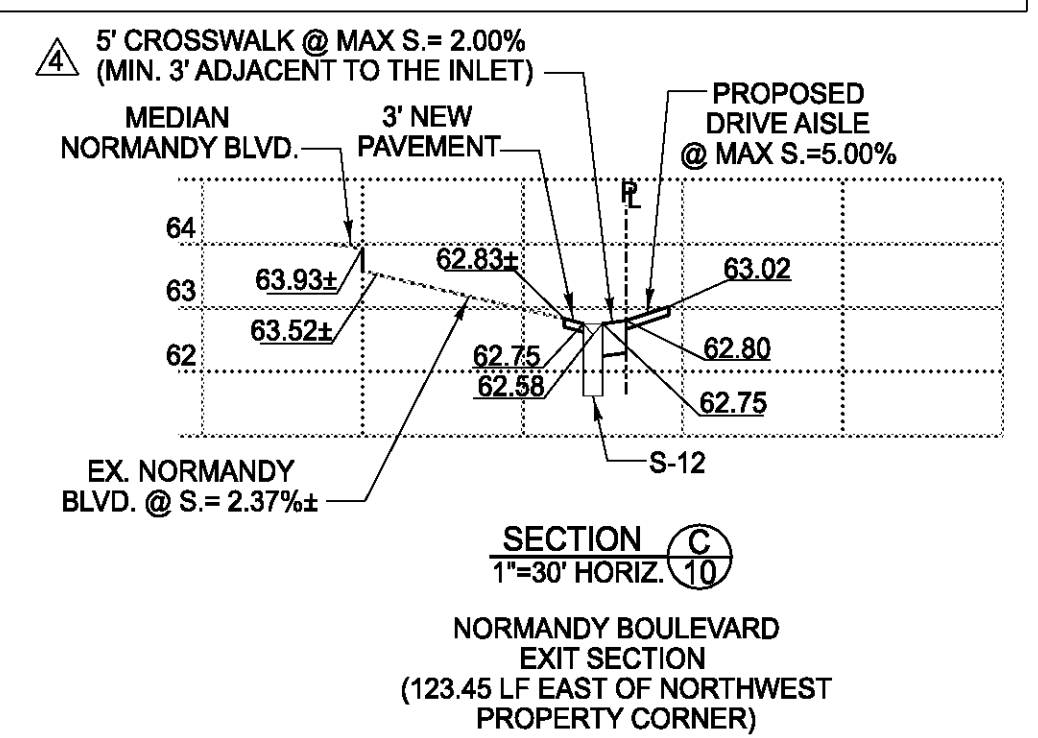

**Walgreens**  
Jacksonville, Florida  
SWC Fouraker Rd & Normandy Blvd  
Store No. 13450

**TAYLOR & WHITE, INC.**  
Consulting and Design Engineers  
8936 Mainway, Suite 100 - Jacksonville, Florida 32255  
Tel. (904) 346-0071 Fax (904) 346-3051 Toll Free (877) 426-4440  
www.taylorandwhite.com

REVISIONS

No.	Date	Description	Initials
1	02/05/2010	Per Walgreens Review Comments	
2	01/19/2009	Revised per Walgreens Architect	
3	02/28/2009	Revised per FDOT Comments	
4	04/01/2009	Per FDOT Comments	
5	03/20/2009	Per COJ Comments	
6	01/15/2009	Per FDOT Comments	

Scale: 1"=30'  
Project Manager: DGT  
Designer: AA  
Drawn by: AA  
Certificate of Authorization: 7298  
Key Map

Project No.: 08140.07  
Date: November 2008  
Sheet No.: C2.1

NOT FOR CONSTRUCTION