

NOTES:

- ALL WORK PERFORMED WITHIN THE FLORIDA DEPARTMENT OF TRANSPORTATION RIGHT OF WAY SHALL CONFORM TO THE FOLLOWING.
 - STANDARD SPECIFICATIONS FOR ROAD AND BRIDGE CONSTRUCTION (CURRENT ENGLISH EDITION)
 - FDOT STANDARDS INDEX (CURRENT ENGLISH EDITION)
 - FDOT PLANS PREPARATION MANUAL (CURRENT EDITION)
 - FDOT FLEXIBLE PAVEMENT DESIGN MANUAL FOR NEW CONSTRUCTION AND PAVEMENT REHABILITATION
- SHOULD A CONFLICT ARISE BETWEEN THE DETAILS SHOWN IN THE PLANS AND THE DEPARTMENT OF TRANSPORTATION STANDARDS THE CONTRACTOR SHALL NOTIFY THE ENGINEER AND THE ENGINEER/PERMITEE SHALL IMMEDIATELY CONFER WITH THE DEPARTMENT'S ENGINEER IN ORDER TO RESOLVE THE DISCREPANCY. IN NO CASE WILL ANYTHING LESS THAN THE DEPARTMENT'S MINIMUM STANDARD BE ALLOWED.
- A DEPARTMENT DRAINAGE CONNECTION PERMIT DOES NOT EXEMP THE PERMITEE FROM MEETING ALL OTHER APPLICABLE REGULATIONS AND ORDINANCES FOR STORMWATER MANAGEMENT.
- ALL WORK DONE IN CONJUNCTION WITH THE DRAINAGE CONNECTION PERMIT SHALL MEET AND ADHERE TO ALL GENERAL AND SPECIFIC CONDITIONS AND REQUIREMENTS CONTAINED ON THE PERMIT.
- WITHIN 15 DAYS AFTER COMPLETION OF THE WORK AUTHORIZED BY AN APPROVED DRAINAGE CONNECTION PERMIT, THE APPLICANT SHALL NOTIFY THE DEPARTMENT IN WRITING OF THE COMPLETION; AND FOR ALL DESIGN WORK THAT ORIGINALLY REQUIRED CERTIFICATION BY AN ENGINEER, THIS NOTIFICATION SHALL CONTAIN THE CERTIFICATION. THE CERTIFICATION SHALL STATE THE WORK HAS BEEN COMPLETED IN SUBSTANTIAL COMPLIANCE WITH THE DRAINAGE CONNECTION PERMIT.
- THE PERMITEE WILL BE REQUIRED TO REIMBURSE THE DEPARTMENT FOR ANY EXPENSES (FEES, FINES, PENALTIES, ABATEMENT COSTS, CLEAN UP, ETC.) INCURRED IN THE EVENT THE PERMITEE'S DISCHARGE FILS TO MEET THE APPLICABLE WATER QUALITY STANDARDS OR MINIMUM DESIGN AND PERFORMANCE STANDARDS CONTRARY TO THE PERMITEE'S ASSURANCES PROVIDED IN SUBSECTION 14-86.003(3), F.A.C.
- ALL DISTURBED AREA WITHIN THE DEPARTMENT OF TRANSPORTATION RIGHT OF WAY WILL BE RESTORED TO ORIGINAL OR BETTER CONDITION BY GRADING AND SODDING THE AREA DISTURBED (BERMUDA IN RURAL, CENTIPEDE IN UTILITY STRIPS).
- ALL CURB AND GUTTER AND SIDEWALK WILL BE REMOVED AND REPLACED JOINT TO JOINT.
- CONSTRUCT ALL PAVEMENT MARKINGS IN ACCORDANCE WITH FDOT DESIGN STANDARDS INDEX #17346.
- ALL TRAFFIC STRIPING AND MARKINGS ARE TO BE LEAD-FREE, NON-SOLVENT BASED THERMOPLASTIC.
- REMOVAL OF EXISTING STRIPING SHALL BE ACCOMPLISHED USING THE "HYDRO-BLAST" METHOD. IF THE PROCESS DAMAGES/SCARS PAVEMENT, THEN THE PAVEMENT SHALL BE MILLED AND RESURFACED PER FDOT STANDARDS.

CONSTRUCTION RESTRICTIONS:

- ALL WORK TO BE PERFORMED AS PART OF THIS PHASE OF CONSTRUCTION SHALL BE COMPLETED DURING WEEKEND HOURS ONLY. ALL LANES OF TRAFFIC SHALL BE OPENED AND OPERATIONAL BY THE FOLLOWING MONDAY MORNING AT 6:00 AM.
- ACCESS TO AND FROM ALL ADJACENT PARCELS SHALL BE MAINTAINED AT ALL TIMES.

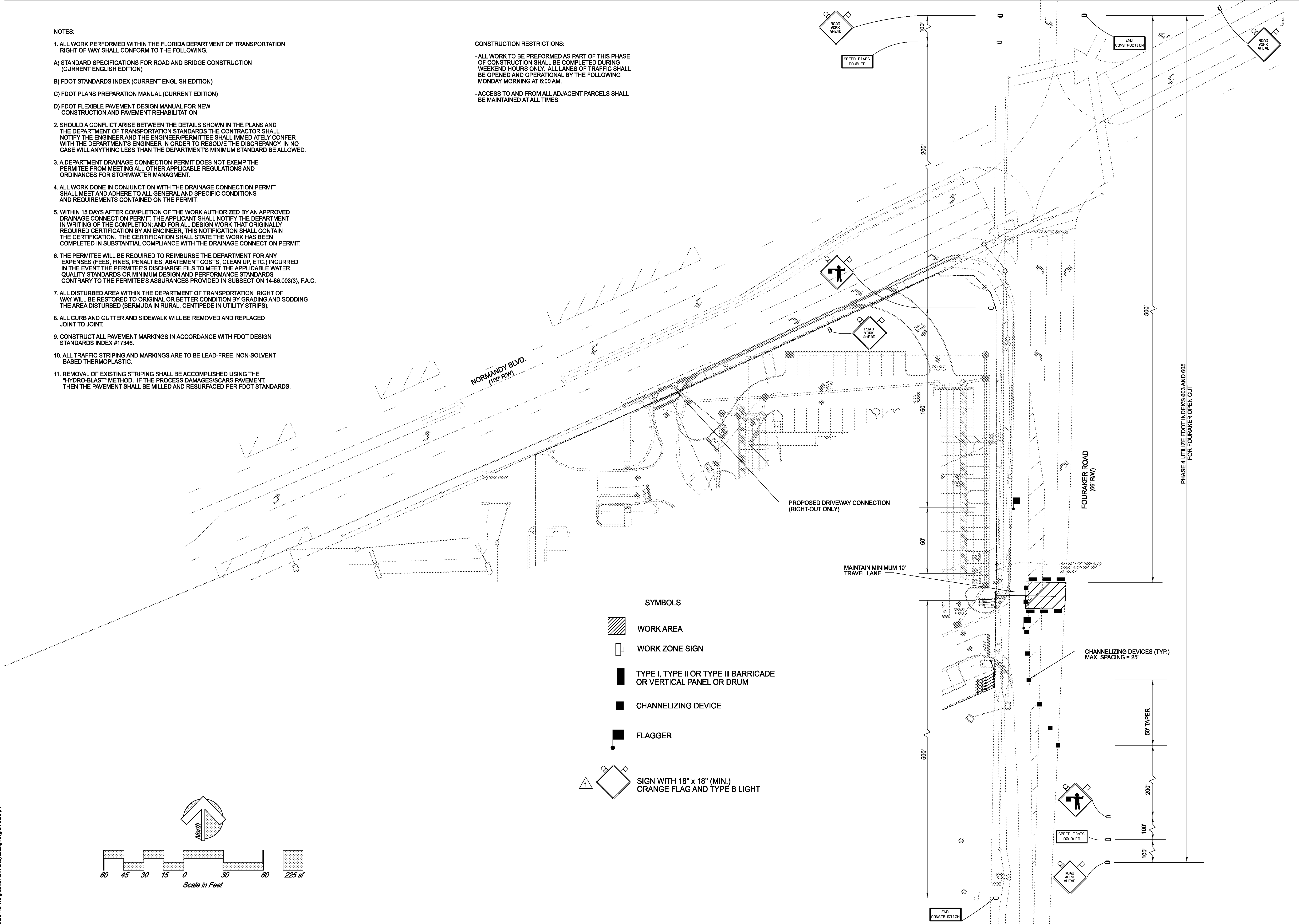

- SYMBOLS
- WORK AREA
 - WORK ZONE SIGN
 - TYPE I, TYPE II OR TYPE III BARRICADE OR VERTICAL PANEL OR DRUM
 - CHANNELIZING DEVICE
 - FLAGGER
 - SIGN WITH 18" x 18" (MIN.) ORANGE FLAG AND TYPE B LIGHT

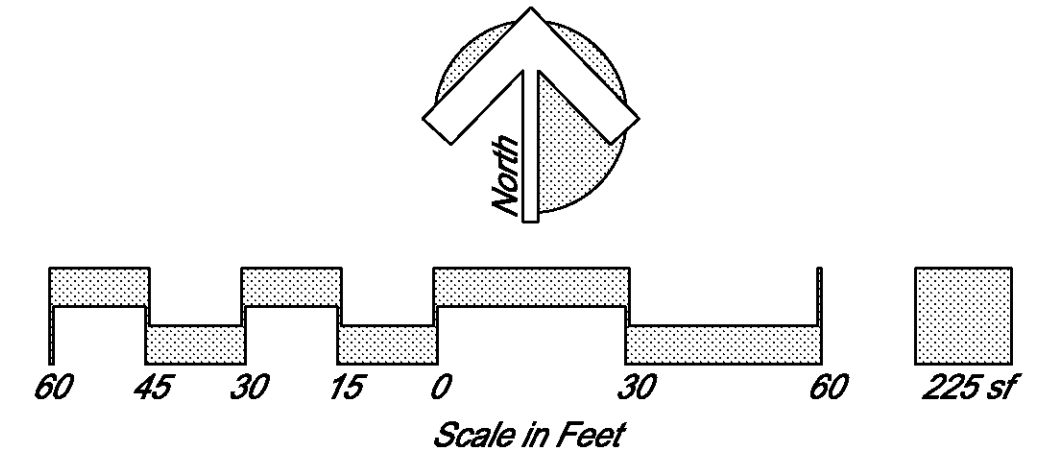

MAINTENANCE OF TRAFFIC PLAN	
Walgreens Jacksonville, Florida SWC Fouraker Rd & Normandy Blvd Store No. 13450	Professional Engineer
Taylor & White, Inc. Consulting and Design Engineers 8936 Meridian Way, Suite 100 - Jacksonville, Florida 32255 Tel: (904) 346-0071 - Fax: (904) 346-3051 - Toll Free (877) 426-4440 www.taylorandwhite.com	Professional Engineer
Scale: 1"=30'	Project No.: 08140.07
Project Manager: DGT	Date: November 2008
Designer: AA	Sheet No.: C3.3
Drawn by: AA	
Certificate of Authorization: 7298	
Key Map	

DO NOT SCALE THIS DRAWING - DIMENSIONS AND NOTES TAKE PREFERENCE

NOT RELEASED FOR CONSTRUCTION