

Speed	Spacing (ft.)		
	A	B	C
40 mph or less	200	200	200
45 mph	250	250	250

* 500' beyond the ROAD WORK AHEAD sign or midway between signs whichever is less.

Speed (mph)	Max. Distance Between Devices (ft.)		Type I or Type II Cones or Tubular Markers	Type I or Type II Barricades or Vertical Panels or Drums
	Taper	Tangent		
25	25	50	25	50
30 to 45	25	50	30	50

Speed (mph)	Lateral Transition (ft.)		Notes
	L	W	
25	125		L = WS ² 60'
30	180		
35	245		
40	320		
45	400		

For lateral transitions other than 12', use formula for L shown in the notes column. Where:
L = Length of taper in feet
W = Width of lateral transition in feet
S = Posted speed limit (mph)

2008 FDOT Design Standards
MULTILANE WORK NEAR INTERSECTION MEDIAN OR OUTSIDE LANE
 Last Revision: 07/01/07
 Index No: 616
 Sheet No: 1 of 3

2008 FDOT Design Standards
MULTILANE WORK NEAR INTERSECTION MEDIAN OR OUTSIDE LANE
 Last Revision: 07/01/07
 Index No: 616
 Sheet No: 2 of 3

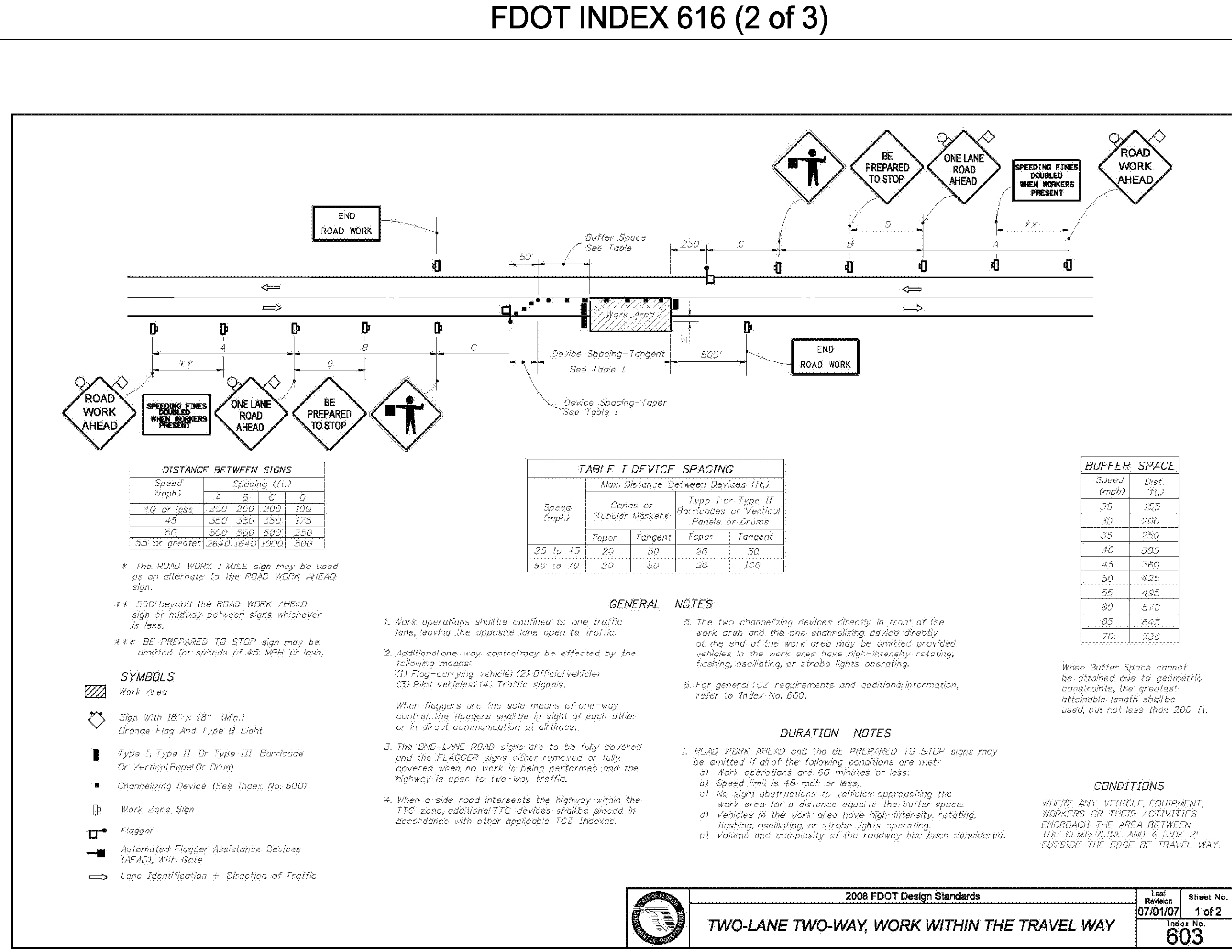

Speed	Spacing (ft.)		
	A	B	C
40 mph or less	200	200	200
45 mph	250	250	250

* 500' beyond the ROAD WORK AHEAD sign or midway between signs whichever is less.

Speed (mph)	Max. Distance Between Devices (ft.)		Type I or Type II Cones or Tubular Markers	Type I or Type II Barricades or Vertical Panels or Drums
	Taper	Tangent		
25	25	50	25	50
30 to 45	25	50	30	50

Speed (mph)	Lateral Transition (ft.)		Notes
	L	W	
25	125		L = WS ² 60'
30	180		
35	245		
40	320		
45	400		

For lateral transitions other than 12', use formula for L shown in the notes column. Where:
L = Length of taper in feet
W = Width of lateral transition in feet
S = Posted speed limit (mph)

Speed	Spacing (ft.)		
	A	B	C
40 or less	200	200	200
45	250	250	250
50	300	300	300
55 or greater	350	350	350

Speed (mph)	Max. Distance Between Devices (ft.)		Type I or Type II Cones or Tubular Markers	Type I or Type II Barricades or Vertical Panels or Drums
	Taper	Tangent		
25 to 45	25	50	25	50
50 to 70	25	50	30	100

Speed (mph)	Buffer Space (ft.)	
	S	D
25	150	150
30	200	200
35	250	250
40	305	305
45	360	360
50	425	425
55	495	495
60	570	570
65	645	645
70	720	720

When Buffer Space cannot be obtained due to geometric constraints, the smallest allowable length should be used, but not less than 200 ft.

2008 FDOT Design Standards
MULTILANE WORK NEAR INTERSECTION MEDIAN OR OUTSIDE LANE
 Last Revision: 07/01/07
 Index No: 616
 Sheet No: 3 of 3

2008 FDOT Design Standards
TWO-LANE TWO-WAY, WORK WITHIN THE TRAVEL WAY
 Last Revision: 07/01/07
 Index No: 603
 Sheet No: 1 of 2

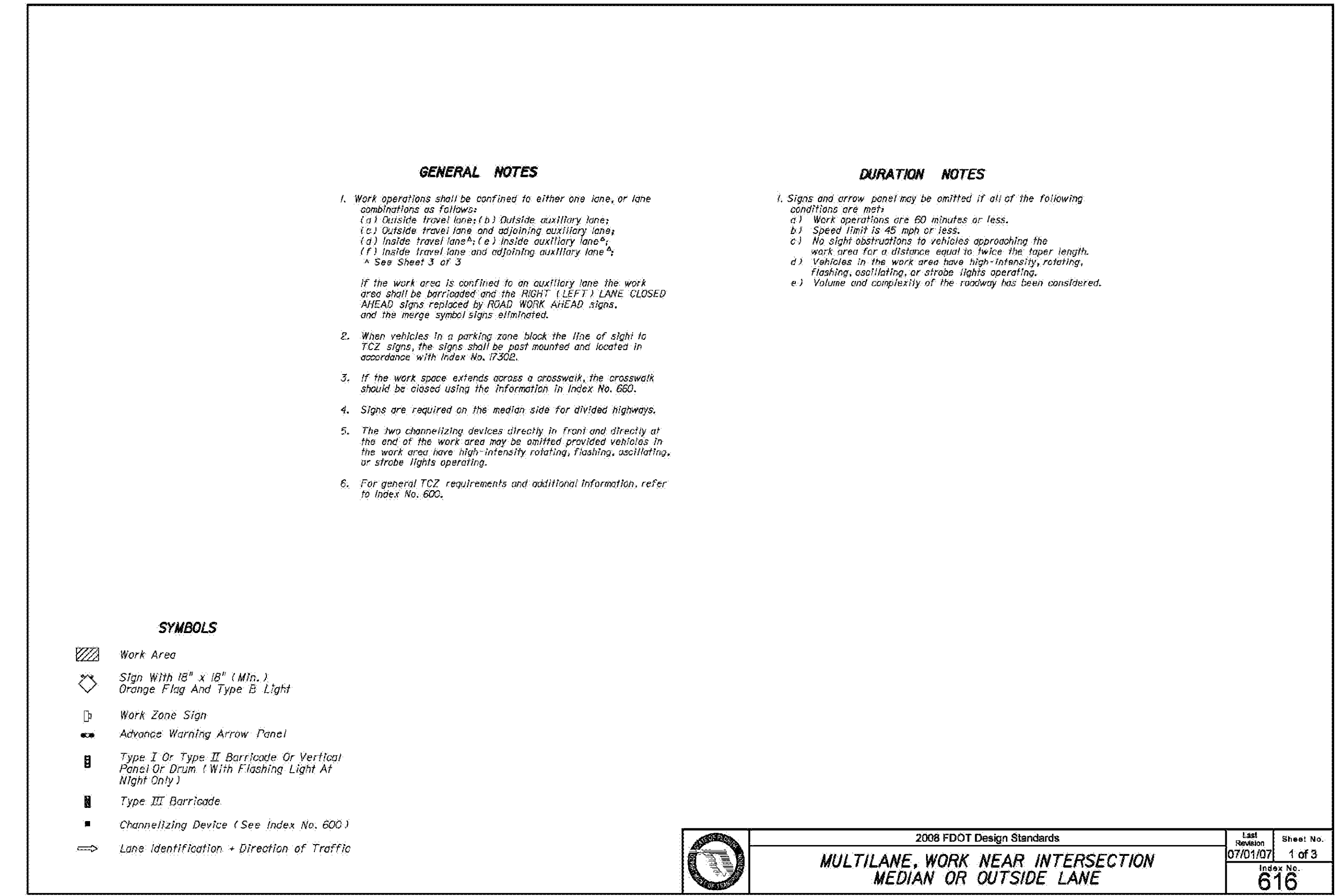

GENERAL NOTES

- Work operations shall be confined to either one lane, or lane combinations as follows:
 (a) Outside travel lane; (b) Outside auxiliary lane;
 (c) Outside travel lane and adjoining auxiliary lanes;
 (d) Inside travel lane; (e) Inside auxiliary lane;
 (f) Inside travel lane and adjoining auxiliary lane.
 - See Sheet 3 of 3
- If the work area is confined to an auxiliary lane the work area shall be barricaded and the RIGHT (LEFT) LANE CLOSED AHEAD signs replaced by ROAD WORK AHEAD signs, and the merge symbol signs eliminated.
- When vehicles in a parking zone block the line of sight to T2Z signs, the signs shall be post mounted and located in accordance with Index No. 1730E.
- If the work space extends across a crosswalk, the crosswalk should be closed using the information in Index No. 660.
- Signs are required on the median side for divided highways.
- The two channelizing devices directly in front and directly at the end of the work area may be omitted provided vehicles in the work area have high-intensity rotating, flashing, oscillating, or strobe lights operating.
- For general T2Z requirements and additional information, refer to Index No. 600.

DURATION NOTES

- Signs and arrow panels may be omitted if all of the following conditions are met:
 a) Work operations are 60 minutes or less.
 b) Speed limit is 45 mph or less.
 c) No sight obstructions to vehicles approaching the work area for a distance equal to twice the taper length.
- Vehicles in the work area have high-intensity rotating, flashing, oscillating, or strobe lights operating.
- Volume and complexity of the roadway has been considered.

SYMBOLS

- Work Area
- Sign with 18" x 18" (Min.) Orange Flag And Type B Light
- Work Zone Sign
- Advance Warning Arrow Panel
- Type I Or Type II Barricade Or Vertical Panel Or Drum With Flashing Light At Night Only
- Type III Barricade
- Channelizing Device (See Index No. 600)
- Lane Identification - Direction of Traffic

2008 FDOT Design Standards
MULTILANE WORK NEAR INTERSECTION MEDIAN OR OUTSIDE LANE
 Last Revision: 07/01/07
 Index No: 616
 Sheet No: 1 of 3

2008 FDOT Design Standards
MULTILANE WORK NEAR INTERSECTION MEDIAN OR OUTSIDE LANE
 Last Revision: 07/01/07
 Index No: 616
 Sheet No: 2 of 3

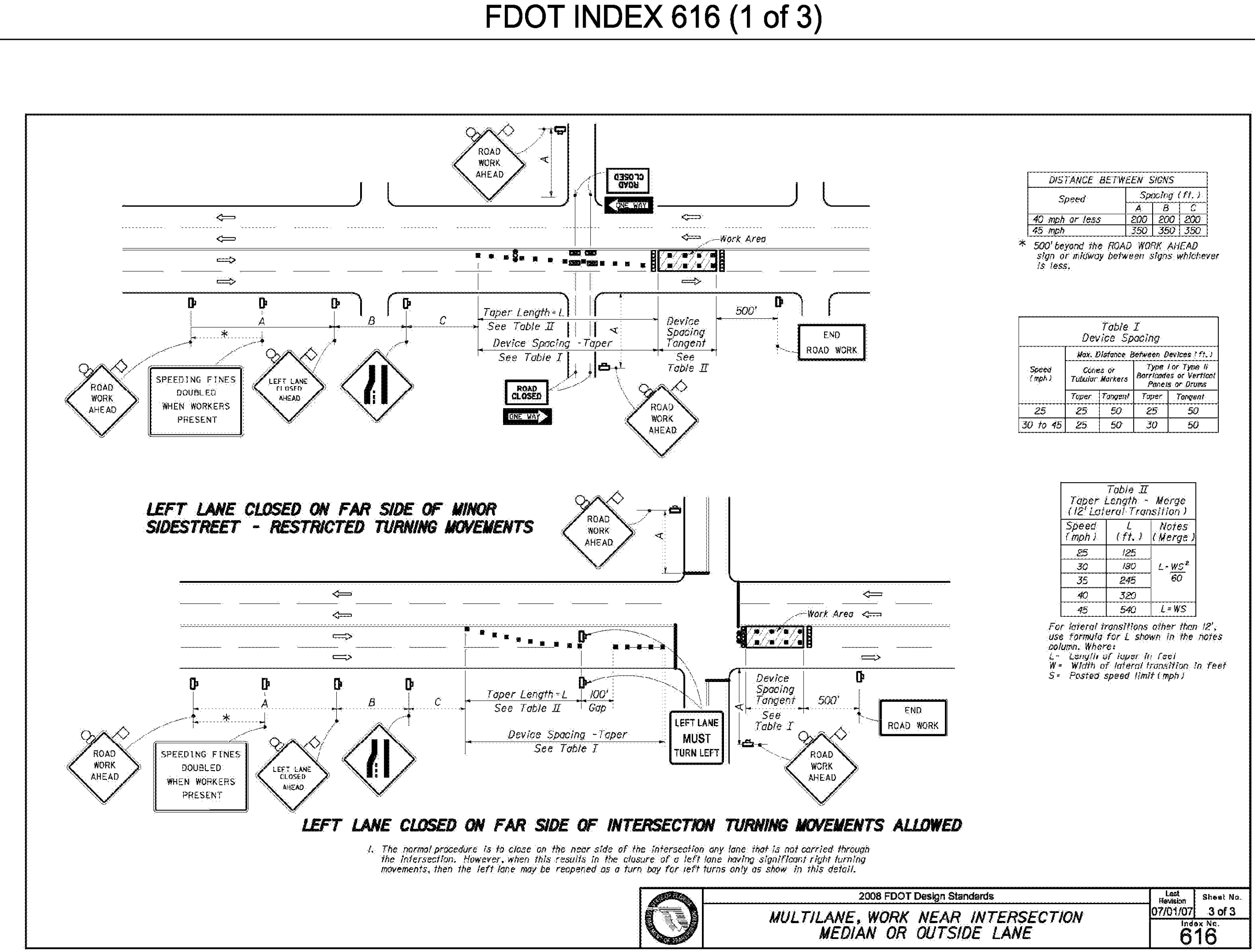

Speed	Spacing (ft.)		
	A	B	C
40 mph or less	200	200	200
45 mph	250	250	250

* 500' beyond the ROAD WORK AHEAD sign or midway between signs whichever is less.

Speed (mph)	Max. Distance Between Devices (ft.)		Type I or Type II Cones or Tubular Markers	Type I or Type II Barricades or Vertical Panels or Drums
	Taper	Tangent		
25	25	50	25	50
30 to 45	25	50	30	50

Speed (mph)	Lateral Transition (ft.)		Notes
	L	W	
25	125		L = WS ² 60'
30	180		
35	245		
40	320		
45	400		

For lateral transitions other than 12', use formula for L shown in the notes column. Where:
L = Length of taper in feet
W = Width of lateral transition in feet
S = Posted speed limit (mph)

Speed	Spacing (ft.)		
	A	B	C
40 or less	200	200	200
45	250	250	250
50	300	300	300
55 or greater	350	350	350

Speed (mph)	Max. Distance Between Devices (ft.)		Type I or Type II Cones or Tubular Markers	Type I or Type II Barricades or Vertical Panels or Drums
	Taper	Tangent		
25 to 45	25	50	25	50
50 to 70	25	50	30	100

Speed (mph)	Buffer Space (ft.)	
	S	D
25	150	150
30	200	200
35	250	250
40	305	305
45	360	360
50	425	425
55	495	495
60	570	570
65	645	645
70	720	720

When Buffer Space cannot be obtained due to geometric constraints, the smallest allowable length should be used, but not less than 200 ft.

2008 FDOT Design Standards
MULTILANE WORK NEAR INTERSECTION MEDIAN OR OUTSIDE LANE
 Last Revision: 07/01/07
 Index No: 616
 Sheet No: 3 of 3

2008 FDOT Design Standards
TWO-LANE TWO-WAY, WORK WITHIN THE TRAVEL WAY
 Last Revision: 07/01/07
 Index No: 603
 Sheet No: 1 of 2

Professional Engineer
 MAINTENANCE OF TRAFFIC DETAILS
 Walgreens
 Jacksonville, Florida
 SWC Fouraker Rd & Normandy Blvd
 Store No. 13450
 TAYLOR & WHITE, INC.
 Consulting and Design Engineers
 896 Western Way, Suite 100 - Jacksonville, Florida 32255
 Tel. (904) 346-0071 - Fax (904) 346-3051 - Toll Free (877) 426-4440
 www.taylorandwhite.com
 Scale: N.T.S.
 Project Manager: DGT
 Designer: AA
 Drawn by: AA
 Certificate of Authorization: 7298
 Key Map
 Project No.: 08140.07
 Date: November 2008
 Sheet No.: C3.6