

**FLOOR PLAN  
ETHERNET SYSTEM**  
SCALE: 1/16" = 1'-0"  
NORTH

PHARMACY COMMUNICATION CABINET CABLING			
CABLE LABEL	CABLE TYPE	FROM	TO
1-1	CAT.5E	Rx COMMUNICATION CABINET	ELECTRICAL EQUIPMENT ROOM (T1)
1-2			ELECTRICAL EQUIPMENT ROOM (T2)
1-3			Rx CONSULTATION WINDOW (CASHIER W/S)
1-4			Rx CONSULTATION WINDOW (VERIFICATION W/S-2)
1-5			FRONT COUNTER (VERIFICATION W/S-1)
1-6			FRONT COUNTER (SCALE 3)
1-7			FRONT COUNTER (SCALE 2)
1-8			FRONT COUNTER (SCALE 1)
1-9			FRONT COUNTER (IN W/S-2)
1-10			FRONT COUNTER (IN W/S-1)
1-11	CAT.5E	Rx COMMUNICATION CABINET	Rx DRIVE THRU (W/S-1)
1-12		OPEN PORT	
1-13	CAT.5E	Rx COMMUNICATION CABINET	Rx ROBOTICS (FUTURE)
1-14			Rx REGISTER 1 (MEET & GREET)
1-15			Rx REGISTER 2 (MEET & GREET)
1-16	CAT.5E	Rx COMMUNICATION CABINET	Rx REGISTER 3 (MEET & GREET)
1-17		OPEN PORT	
1-18		OPEN PORT	
1-19		OPEN PORT	
1-20		OPEN PORT	
1-21		OPEN PORT	
1-22		OPEN PORT	
1-23		OPEN PORT	
1-24		OPEN PORT	
1-25	CAT.5E	Rx COMMUNICATION CABINET	FRONT CASH REGISTER
1-26			FRONT CASH REGISTER
1-27			FRONT CASH REGISTER
1-28	CAT.5E	Rx COMMUNICATION CABINET	COSMETIC CASH REGISTER
1-29		OPEN PORT	
1-30	CAT.5E	Rx COMMUNICATION CABINET	PHOTO CASH REGISTER
1-31			PHOTO CASH REGISTER
1-32			OFFICE DRAWING D-1 #24A
1-33			Rx CASH REGISTER
1-34			Rx CASH REGISTER
1-35			Rx CASH REGISTER
1-36	CAT.5E	Rx COMMUNICATION CABINET	DRIVE-THRU CASH REGISTER
1-37		OPEN PORT	
1-38		OPEN PORT	
1-39		OPEN PORT	
1-40		OPEN PORT	
1-41		OPEN PORT	
1-42		OPEN PORT	
1-43		OPEN PORT	
1-44		OPEN PORT	
1-45		OPEN PORT	
1-46		OPEN PORT	
1-47		OPEN PORT	
1-48		OPEN PORT	
1-49	CAT.5E	Rx COMMUNICATION CABINET	FRONT CASH REGISTER (CATALINA COUPON PRINTER)
1-50			FRONT CASH REGISTER (CATALINA COUPON PRINTER)
1-51			FRONT CASH REGISTER (CATALINA COUPON PRINTER)
1-52	CAT.5E	Rx COMMUNICATION CABINET	COSMETIC CASH REGISTER (CATALINA COUPON PRINTER)
1-53		OPEN PORT	
1-54	CAT.5E	Rx COMMUNICATION CABINET	PHOTO CASH REGISTER (CATALINA COUPON PRINTER)
1-55			PHOTO CASH REGISTER (CATALINA COUPON PRINTER)
1-56			OFFICE COMMUNICATION CABINET (CATALINA STORE CONTROLLER)
1-57			OFFICE COMMUNICATION CABINET (CATALINA STORE CONTROLLER)
1-58			Rx CASH REGISTER (CATALINA COUPON PRINTER)
1-59			Rx CASH REGISTER (CATALINA COUPON PRINTER)
1-60			Rx CASH REGISTER (CATALINA COUPON PRINTER)
1-61	CAT.5E	Rx COMMUNICATION CABINET	DRIVE-THRU CASH REGISTER (CATALINA COUPON PRINTER)
1-62		OPEN PORT	
1-63		OPEN PORT	
1-64		OPEN PORT	
1-65		OPEN PORT	
1-66		OPEN PORT	
1-67		OPEN PORT	
1-68		OPEN PORT	
1-69		OPEN PORT	
1-70		OPEN PORT	

PHARMACY COMMUNICATION CABINET CABLING (CONTD)			
CABLE LABEL	CABLE TYPE	FROM	TO
1-71		OPEN PORT	
1-72		OPEN PORT	
2-1	CAT.5E	Rx COMMUNICATION CABINET	PHOTO PROCESSOR-1
2-2		OPEN PORT	
2-3		OPEN PORT	
2-4	CAT.5E	Rx COMMUNICATION CABINET	SPARE
2-5	CAT.5E	Rx COMMUNICATION CABINET	KIOSK SHELF
2-6		OPEN PORT	
2-7	CAT.5E	Rx COMMUNICATION CABINET	PICTURE CARE PLUS (PHOTO W/S-1)
2-8	CAT.5E	Rx COMMUNICATION CABINET	PICTURE CARE PLUS (PHOTO PRINTER-1)
2-9	CAT.5E	Rx COMMUNICATION CABINET	PHOTO COUNTER - SPARE
2-10		OPEN PORT	
2-11	CAT.5E	Rx COMMUNICATION CABINET	PHOTO COUNTER - SPARE
2-12			PHOTO COUNTER - SPARE
2-13			PICTURE CARE PLUS (PHOTO W/S-2)
2-14			PICTURE CARE PLUS (PHOTO PRINTER-2)
2-15			KIOSK SHELF
2-16	CAT.5E	Rx COMMUNICATION CABINET	KIOSK SHELF
2-17		OPEN PORT	
2-18		OPEN PORT	
2-19		OPEN PORT	
2-20		OPEN PORT	
2-21		OPEN PORT	
2-22		OPEN PORT	
2-23		OPEN PORT	
2-24			FRONT CASH REGISTER
2-25	CAT.5E	Rx COMMUNICATION CABINET	ELECTRICAL EQUIPMENT ROOM (SECURITY/ALARM)
2-26			ELECTRICAL EQUIPMENT ROOM (EMS CONTROLLER)
2-27		OPEN PORT	
2-28			ELECTRICAL EQUIPMENT ROOM (UPS)
2-29			GENERAL STOCK-RECEIVING ROOM (VOP PHONE)
2-30			EMPLOYEE ROOM (VOP PHONE)
2-31	CAT.5E	Rx COMMUNICATION CABINET	SALES-CEILING CENTER (ACCESS POINT)
2-32		OPEN PORT	
2-33	CAT.5E	Rx COMMUNICATION CABINET	ATM
2-34			OFFICE COMMUNICATION CABINET (INDYME CONTROLLER)
2-35			TIME CLOCK
2-36	CAT.5E	Rx COMMUNICATION CABINET	OFFICE COMMUNICATION CABINET (AMS)
2-37		OPEN PORT	
2-38		OPEN PORT	
2-39		OPEN PORT	
2-40		OPEN PORT	
2-41		OPEN PORT	
2-42		OPEN PORT	
2-43		OPEN PORT	
2-44		OPEN PORT	
2-45		OPEN PORT	
2-46		OPEN PORT	
2-47		OPEN PORT	
2-48		OPEN PORT	
2-49	CAT.5E	Rx COMMUNICATION CABINET	OFFICE DRAWING D-1 #22
2-50			OFFICE - SPARE
2-51			OFFICE DRAWING D-1 #24C
2-52			OFFICE COMMUNICATION CABINET (AS400)
2-53			OFFICE COMMUNICATION CABINET (ARLAN)
2-54			OFFICE COMMUNICATION CABINET (DVR)
2-55	CAT.5E	Rx COMMUNICATION CABINET	TRAINING TERM DRAWING D-1 #15C
2-56		OPEN PORT	
2-57	CAT.5E	Rx COMMUNICATION CABINET	OFFICE COMMUNICATION CABINET (IC+)
2-58			OFFICE COMMUNICATION CABINET (CO SERVER)
2-59			OFFICE COMMUNICATION CABINET (IBN SERVER)
2-60			OFFICE COMMUNICATION CABINET (TIB SERVER)
2-61			OFFICE (STORE DISTRICT MANAGER)
2-62			FRONT COUNTER (Rx DISTRICT MANAGER)
2-63	CAT.5E	Rx COMMUNICATION CABINET	OFFICE COMMUNICATION CABINET (AS400 CP. CONTROL)
2-64		OPEN PORT	
2-65		OPEN PORT	
2-66		OPEN PORT	
2-67		OPEN PORT	
2-68		OPEN PORT	

**ETHERNET SYSTEM NOTES**

- ALL WORK SHOWN SHALL COMPLY WITH ALL NATIONAL, STATE AND LOCAL CODES, ORDINANCES, ETC.
- ETHERNET "CATEGORY 5E" CABLES TO BE FURNISHED AND INSTALLED BY WALGREENS' CONTRACTOR (CERTIFIED CATEGORY 5E INSTALLER) AND SHALL FOLLOW EIA/TIA CATEGORY 5E SPECIFICATIONS. THE ETHERNET (CATEGORY 5E) SYSTEM SHALL ALSO BE TESTED WITH A WAIVETECH/WIRESCOPE DEVICE AND REPORT SUBMITTED TO WALGREENS COMPANY.
- CONDUIT BENDS SHALL HAVE A MINIMUM RADIUS OF EIGHT TIMES THE CONDUIT DIAMETER.
- ALL CONDUITS TO BE PROVIDED BY THE ELECTRICAL CONTRACTOR. ELECTRICAL CONTRACTOR TO PROVIDE PULL BOX AT RX COMMUNICATION CABINET LOCATION. ELECTRICAL CONTRACTOR SHALL FURNISH #12 PULL STRING IN EACH CONDUIT.
- IF CABLES ARE ROUTED BELOW FLOOR, THEN USE 1" CONDUIT (MINIMUM).
- IF CABLES ARE ROUTED ABOVE CEILING (SEE DETAIL 7/E4.4 - FOR CONDUIT IN WALL), THEN NO CONDUIT NECESSARY (ABOVE CEILING) WHEN CABLES ARE RATED IN ACCORDANCE TO NATIONAL ELECTRICAL CODE FOR USE ABOVE CEILING, OTHERWISE PROVIDE 3/4" CONDUIT (MINIMUM).
- FOR FURTHER INFORMATION CONTACT FACILITIES MANAGEMENT DEPARTMENT AT WALGREENS'. (MANAGER OF FACILITIES TECHNOLOGY).

PHARMACY COMMUNICATION CABINET CABLING (CONTD.)			
CABLE LABEL	CABLE TYPE	FROM	TO
2-69		OPEN PORT	
2-70		OPEN PORT	
2-71		OPEN PORT	
2-72		OPEN PORT	

MISCELLANEOUS CABLING			
CABLE LABEL	CABLE TYPE	FROM	TO
A	CAT.5E	OFFICE COMMUNICATION CABINET	OFFICE DRAWING D-1 #24B
B1	CAT.5E	ELECTRICAL EQUIPMENT ROOM	Rx DRIVE-THRU
B2	CAT.5E	ELECTRICAL EQUIPMENT ROOM	Rx DRIVE-THRU
I	CAT.5E	ELECTRICAL EQUIPMENT ROOM	OFFICE (INDYME AUDIO)
R	CAT.5E	OFFICE	LED READERBOARD
IR	CAT.5E	SALES-CEILING INDYME REMOTE RECEIVER	OFFICE COMMUNICATION CABINET

CONDUIT AND CABLE SCHEDULE	
CONDUIT SIZE	BELDEN 1700A CATEGORY 5e
3/4"	3
1"	5
1 1/4"	8
1 1/2"	15
2"	20

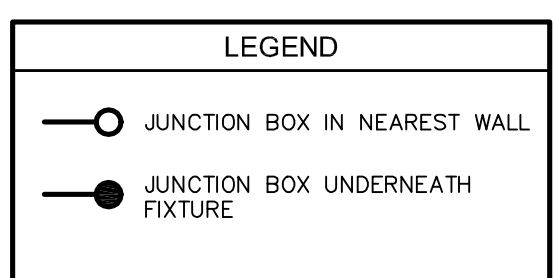

**FWH Architects**  
3336 Grand Blvd. Suite 102  
Holiday, Florida 34690  
Ph. 727. 815. 3336  
Fax 727. 815. 3337

**PROJECT TYPE**

DRAWINGS/SPECIFICATIONS BY:  
 WALGREENS' CONSULTANT  
 LANDLORD'S CONSULTANT

CONSTRUCTION WORK BY: (UNLESS NOTED OTHERWISE)  
 WALGREENS' CONTRACTOR  
 LANDLORD'S CONTRACTOR (TURNKEY CONSTRUCTION)

STORE	BUILDING
NEW..... <input type="checkbox"/>	NEW..... <input type="checkbox"/>
REMODELING... <input type="checkbox"/>	EXISTING..... <input type="checkbox"/>
RELOCATION... <input type="checkbox"/>	NEW SHELL ONLY <input type="checkbox"/>
OTHER..... <input type="checkbox"/>	

**CHEHAYEB & ASSOCIATES, INC.**  
CONSULTING ENGINEERS

3702 AZBEELE ST. TAMPA, FL 33609 (813) 876-1415 (fax) 876-0913

LIC. #49521 SOUHEIL CHEHAYEB 09-97 CERT. #7340

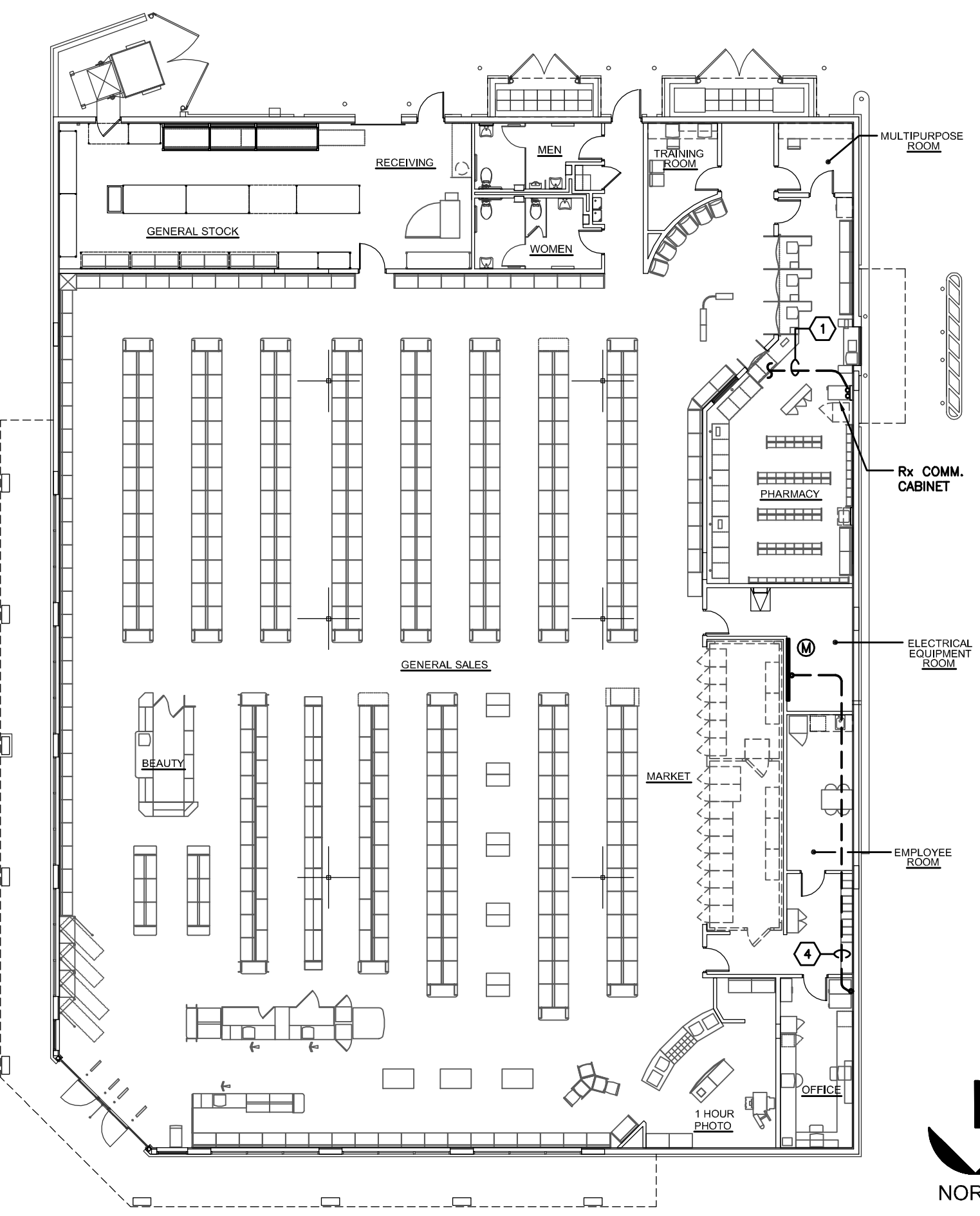

**FLOOR PLAN  
SATELLITE SYSTEM**  
SCALE: 1/16" = 1'-0"  
NORTH

CONDUIT AND CABLE SCHEDULE	
CONDUIT SIZE	BELDEN 9116A COAX RG6
3/4"	1
1"	3
1 1/4"	4
1 1/2"	7
2"	10

**SATELLITE SYSTEM KEYED NOTES**

- (2) COAXIAL DIGITAL INTERFACE UNIT (DIU) CABLE, FURNISHED BY WALGREEN AND INSTALLED BY ELECTRICAL CONTRACTOR. ROUTE TO SATELLITE ANTENNA LOCATION ON ROOF. SEE DETAIL 1/E4.2. PROVIDE 15' OF SLACK CABLE AT EACH END. COIL THE REMAINING CABLE IN THE CEILING. DO NOT CUT CABLE.
- NOT USED
- NOT USED
- CABLE LABELED (M) RG6 - 9116 FURNISHED AND INSTALLED BY WALGREENS. FROM OFFICE COMMUNICATION CABINET TO ELECTRICAL EQUIPMENT ROOM. CONDUIT AND #12 PULL STRING BY ELECTRICAL CONTRACTOR.

**SATELLITE SYSTEM NOTES**

- CABLE ROUTING**  
INTERCONNECTING IFL CABLES (LOW ENERGY) THE INTERCONNECTING IFL CABLES CONSISTS OF TWO (2) COAXIAL DIU/O CABLE.  
A. CABLES ARE TO BE ENCLOSED IN A RACEWAY WHEN ROUTED THRU WALLS.  
B. A MINIMUM BEND RADIUS OF 6" IS REQUIRED FOR ALL CABLES AND A SUITABLE JUNCTION BOX OR OTHER APPROPRIATE ACCESS IS REQUIRED FOR TIGHT BENDS GREATER THAN 60 DEGREES.  
C. CABLES MAY BE RUN EXPOSED IN CEILING SPACE. TWO(2) COAXIAL DIU/O CABLES FURNISHED BY WALGREENS AND INSTALLED BY THE CONTRACTOR.  
D. PROVIDE RACEWAY IN PLENUM CEILING SPACE. HOWEVER, AS AN ALTERNATIVE, USE PLENUM TYPE (TEFLON) CABLES AS ACCEPTED BY THE NATIONAL ELECTRICAL CODE, AS CLASSIFIED BY UNDERWRITERS LABORATORIES, INC. (UL) FOR USE WITHOUT CONDUIT IN RETURN-AIR DUCTS AND PLENUMS, AND AS SPECIFIED BY HUGHES.
- GROUNDING**  
SEE GROUNDING NOTES #1 AND #2 ON DRAWING E2.1.
- GROUNDING TEST**  
THE DC RESISTANCE BETWEEN THE GROUND WIRE (GREEN GROUND WIRE) AND THE ELECTRICAL JUNCTION BOX (EQUIPMENT CHASSIS GROUND OR MECHANICAL GROUND) SHALL BE:  
A. CONNECTION TO METALLIC COLD WATER PIPE: 2 OHMS OR LESS  
B. CONNECTION TO GROUNDED STRUCTURAL STEEL MEMBER: 2 OHMS OR LESS  
C. CONNECTION TO DRIVEN GROUND ROD: 2 OHMS OR LESS.  
UNDER ADVERSE CONDITIONS WHEN 2 OHMS IS NOT ACHIEVABLE CONTACT WALGREENS CONSTRUCTION SUPERINTENDENT FOR FURTHER DIRECTION.  
NOTE: WHEN TESTING, SEPARATE FROM EXISTING GROUNDING SYSTEM OF SERVICE PANELBOARD.

NO.	DATE	DESCRIPTION
2	02.05.10	REVISED PER WGS FIRST REVIEW COMMENTS

**CERTIFICATION AND SEAL**

I HEREBY CERTIFY THAT THIS PLAN AND SPECIFICATION WERE PREPARED BY ME OR UNDER MY DIRECT SUPERVISION AND THAT I AM A DULY REGISTERED ARCHITECT OR ENGINEER UNDER THE LAWS OF THE STATE OF FLORIDA AS SIGNIFIED BY MY HAND AND SEAL.

PROJECT NAME  
**STORE #13450  
SWC OF FOURAKER & NORMANDY  
JACKSONVILLE, FLORIDA**

DRAWING TITLE  
**FLOOR PLAN - ETHERNET & SATELLITE SYSTEM**

DATE: 11.30.09	WALGREENS STORE NO. 13450	DRAWING NO.
DRAWN BY: P.M.	SCALE: AS SHOWN	<b>E1.3</b>
REVIEWED BY: S.C.	RELEASED TO CONSTRUCTION	FWH PROJECT NO. 0913