

Replacement Trees / Plant Schedule

Qty	Botanical Name	Common Name	Caliper	Subtotal	Shade Tree	Native Species	Mature Height	Mature Spread
8	Ilex attenuata 'Savannah'	Savannah Holly	4	32	Yes	Yes	20-30'	6-10'
14	Lagerstroemia indica	Crape Myrtle	8	112	No	No	15-25'	15-25'
13	Quercus virginiana	Live Oak	6	78	Yes	Yes	55-60'	60-70'
28	Ulmus parvifolia 'Drake'	Drake Elm	4	112	Yes	No	35-40'	20-30'
69				334	76%	33%		
297	Ilex glabra	Inkberry	24" Ht. Min.		VUA Buffer Hedge	Yes		

86% Total Planting Native

Landscape Plant Schedule

Qty	Botanical Name	Common Name	Size	Spacing	Maintained Ht.	Notes
111	Loropetalum chinenses 'Rubra'	Ruby Loropetalum	18 - 24" Ht.	24" o.c.	36" Ht.	Clip as Informal Mass
216	Dianella tasmanica	Var. Blueberry Flax Lily	15 - 18" Ht.	24" o.c.	24" Ht.	Grow to Mass
327	Juniperus chinensis 'Parsonii'	Parson Juniper	15 - 18" Ht.	24" o.c.	24" Ht.	Grow to Mass
As per Plan	Stenotaphrum secundatum	St. Augustine Floratam	18 x 24" piece	solid	2 - 3" Ht.	

Mitigation Summary

Mitigation Required	515
Replacement Tree Inches	334
Mitigation Balance Due COJ	181 X \$103 / inch = \$18,643.00 (to be paid into COJ Tree Bank Fund)

Mitigation Calculations

LANDSCAPE CALCULATIONS		City of Jacksonville	
Zoning	Commercial		
V.U.A. Public Area	35,292 s.f.		
10% V.U.A. Required Landscape Area	3,529 s.f.		
Landscape Area Provided	3,762 s.f.		
25% of 10% V.U.A. Required Shrub Area	881.3 s.f.		
Shrub Area Provided	250 s.f.		
PERIMETER AREA REQUIREMENT BREAKDOWN			
Perimeter Area - North Side (Street Frontage)		265.74 s.f.	
(10 s.f./l.f. = 10 x 265.74 l.f.)	Area Required	2,657.4 s.f.	
	Area Provided	3,500 s.f.	
Perimeter Area - South Side		220 s.f.	
(5 s.f./l.f. = 5 x 220 l.f.)	Area Required	1,100 s.f.	
	Area Provided	2,500 s.f.	
Perimeter Area - East Side		297.89 s.f.	
(10 s.f./l.f. = 10 x 297.89 l.f.)	Area Required	2,978.9 s.f.	
	Area Provided	3,250 s.f.	
Perimeter Area - West Side		271.28 s.f.	
(5 s.f./l.f. = 5 x 271.28 l.f.)	Area Required	1,356.4 s.f.	
	Area Provided	1,750 s.f.	
PERIMETER AND INTERIOR TREE REQUIREMENT BREAKDOWN			
Internal Landscapes		((1 Tree / 4,000 s.f. = 35,292 s.f. / 4,000 s.f.)	
	Trees Required	9	
	Trees Provided	12	
Perimeter Trees - North Side (Street Frontage)		265.74 l.f.	
(1 Tree / 50 l.f.)	Trees Required	5	
	Trees Provided	11	
Perimeter Trees - South Side		220 l.f.	
(1 Tree / 50 l.f.)	Trees Required	4	
	Trees Provided	13	
/In addition to (2) Existing Canopy Trees to Remain			
Perimeter Trees - East Side		297.89 l.f.	
(1 Tree / 50 l.f.)	Trees Required	6	
	Trees Provided	13	
Perimeter Trees - West Side		271.28 l.f.	
(1 Tree / 50 l.f.)	Trees Required	5	
	Trees Provided	14	

REVISIONS	
NO.	DESCRIPTION
1.	01-25-2009 A/C/O/J Dev. Review Comments
2.	05-21-2009 A/C/O/J Dev. Review Comments
3.	08-11-2009 No Existing Paved Improvements
4.	11-25-2009 As per Owner's Archt. Meeting
5.	12-04-2009 Indicate Proposed Line Pole
6.	12-05-2010 Final Revisions as per Owner

THIS DRAWING IS AN INSTRUMENT OF SERVICE AND THE PROPERTY OF SUNSHINE DESIGN AND SHALL REMAIN THEIR PROPERTY. THE USER SHALL BE RESPONSIBLE FOR OBTAINING THE ORIGINAL SITE FOR ALL WORK. THE USER'S PUBLICATION THEREOF IS EXPRESSLY LIMITED TO THIS USE.

Walgreen's
Normandy Blvd. and Fouraker Road
A Development by:
Rock Ventures, LLC
LANDSCAPE PLAN

SUNSHINE DESIGN
Chris Commins ASLA
PMB 366 | 445-26 State Road 13 | Fruit Cove, Florida 32259
PH: 904-233-4809 Email: chris@chriscommins.com

DATE: 12-05-2008
DRAWN BY: JCC/SP
SHEET NO.: **LS-1a**

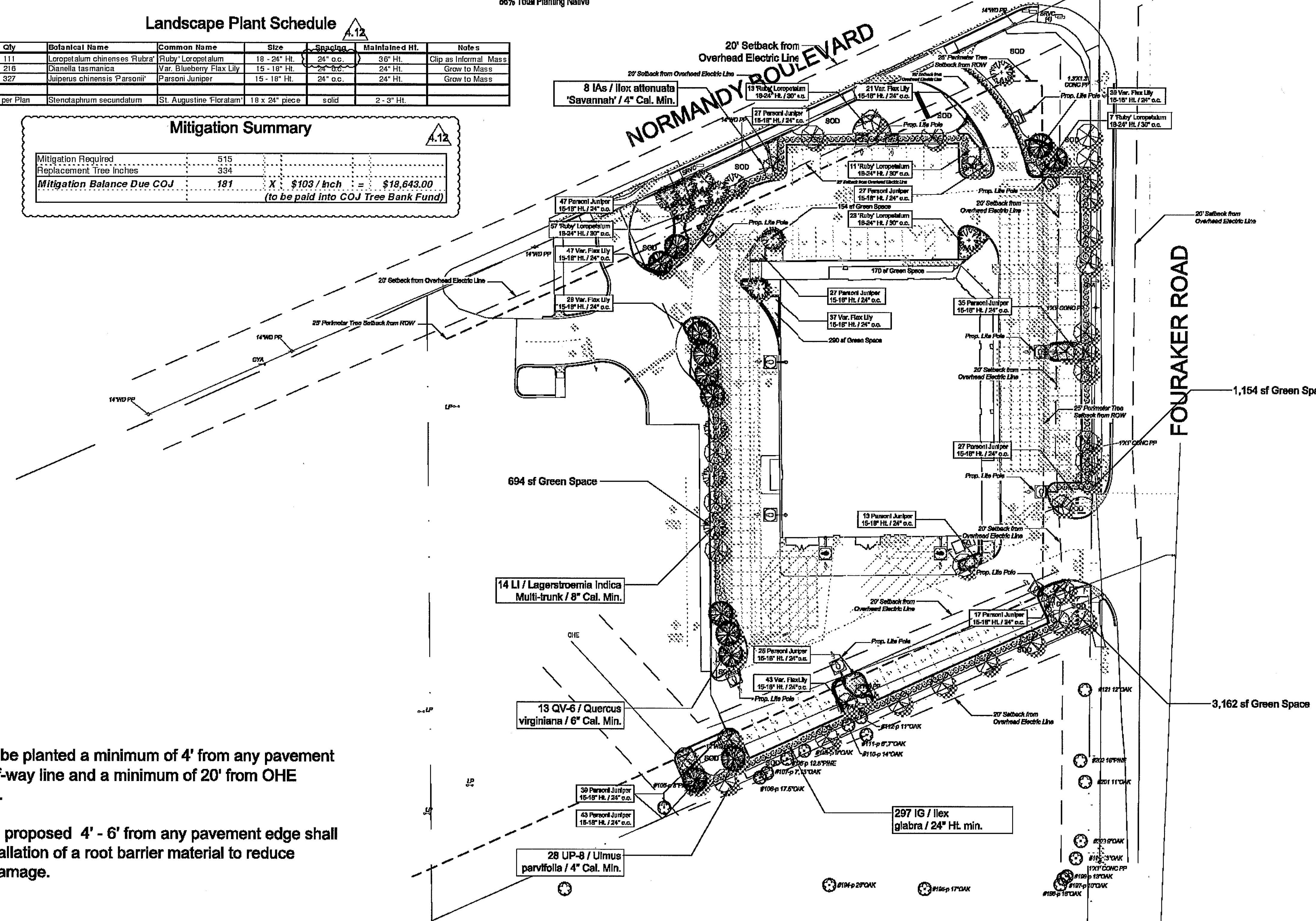

NOTE:

Shade trees to be planted a minimum of 4' from any pavement edge or right-of-way line and a minimum of 20' from OHE (noted on plan).

Any shade tree proposed 4' - 6' from any pavement edge shall require the installation of a root barrier material to reduce potential root damage.

Tree Replacement Note

Actual number of Trees Provided as noted above exceeds the Trees Required calculation due to the additional burden of satisfying the Mitigation Requirements as per the City of Jacksonville Landscape Code.

Due to the large number of Protected Trees removed on site, the Mitigation Calculations (upper left corner) take precedent and require us to plant in excess of the Perimeter Trees Required minimum notations above in order to address the 515' of Mitigation Required.

When Mitigation Requirements exceed the Perimeter Requirements, City of Jacksonville code requires Replacement Tree Plantings above and beyond these minimums based on established size and offset criteria, and when those are met, the applicant can pay the balance in the City Tree Bank Fund to make up any difference.

Green Space Summary
(Min. 10% Req'd as per Section 656.1210)

Total Required: 6,700 sf
Total Provided: 16,040 sf

Landscape Note

Remove or relocate all trees that obstruct view to storefront, building signs and free-standing signs. If not possible, trim off lower branches to preserve sight lines.

Shrubs must be a minimum of 30' away from parking stalls (Typ).

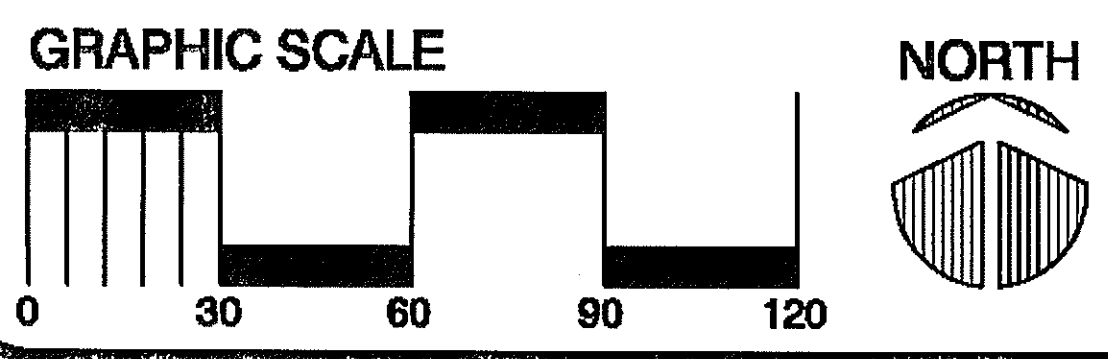

LANDSCAPE PLAN
SCALE: 1" = 30' - 0"