

IRRIGATION USAGE REQUIREMENTS

Growing Season (Daylight Savings Time) Restrictions:

- Non-residential Tuesday and Friday
- Apply less than or equal $\frac{1}{2}$ " each watering day
- System designed to apply .4" per hour. System may be run for 1hr and 15 minutes to not exceed $\frac{1}{2}$ " watering restriction.

Exceptions w/time limits:

- 24 hours after applying chemicals
- Maintenanxce and repair of irrigation system (10 mins/zone)
- New landscape 30 days any time and every other day for 30 additional days

No Watering 10 am to 4 pm

Exceptions - can water any day and time:

- Discharges from air to water heating or cooling units
- Hand-held irrigation using shutoff nozzle
- Micro-irrigation (apply at root) Soak / Drip / Small spray heads

Winter Restrictions:

- December thru February
- Tuesdays Only
- Apply less than or equal $\frac{3}{4}$ " each watering day
- System designed to apply .4" per hour. Sytem may be run for 1hr and 50 minutes to not exceed $\frac{3}{4}$ " watering restriction.

Hours apply but days not limited:

- Retention ponds if not augmented from other sources
- Reclaimed water
- Recycled water (stormwater)

LEGEND

ID.	DESCRIPTION	SPECIFICATION
WS	WATER SOURCE	1/2" Irrigation Only Water Meter
BD	BACKFLOW DEVICE	Wilkins 950XLT-1 1/4" or equal
S	SLEEVING	Schedule 40 PVC, 6/8" AS SPECIFIED
C	CONTROLLER	Hunter series PC-300 (3 Zone) install with Mini-Click rain sensor.
V	SOLENOID VALVE	Hunter series ICV-15G-B (1 1/2" valve)
3I	IRRIGATION HEAD	Hunter series (see schedule for types)
P	PIPE AND PIPE SIZE	SDR 13.5 1/2" and 3/4" lines SDR 26 for all 1" and larger lateral lines
M	MAINLINE	Irrigation mainline, Schedule 40 PVC pipe 2" size

VALVE SCHEDULE

ZONE	GPM	PSI	TYPE
1	35.75	40.0	SHRUB
2	33.18	40.0	SHRUB
3	36.00	40.0	SHRUB

CONTRACTOR TO VERIFY ALL QUANTITIES

SPRINKLER LIST

QUANTITY	ID.	MANUFACTURER	SPECIFICATION	P.S.I.	G.P.M.	RADIUS
SHRUB-RISER						
2	1A	Hunter	INST-06-CV-MP1000-90	40	0.19	ADJUSTABLE
24	1B	Hunter	INST-06-CV-MP1000-90	40	0.39	ADJUSTABLE
1	1C	Hunter	INST-06-CV-MP1000-210	40	0.43	ADJUSTABLE
6	1S	Hunter	INST-06-CV-MPLCS515	40	0.22	LEFT
6	1T	Hunter	INST-06-CV-MPRCS515	40	0.22	RIGHT
35	1U	Hunter	INST-06-CV-MPSS530	40	0.44	SIDE
INST 6" POP-UP ROTOR						
17	2A	Hunter	INST-06-CV-MP1000-90	40	0.19	ADJUSTABLE
11	2B	Hunter	INST-06-CV-MP1000-90	40	0.39	ADJUSTABLE
8	2F	Hunter	INST-06-CV-MP2000-90	40	0.40	ADJUSTABLE
14	2G	Hunter	INST-06-CV-MP2000-90	40	0.74	ADJUSTABLE
1	2H	Hunter	INST-06-CV-MP3000-90	40	0.86	ADJUSTABLE
8	2K	Hunter	INST-06-CV-MP3000-90	40	0.86	ADJUSTABLE
8	2L	Hunter	INST-06-CV-MP3000-90	40	1.86	ADJUSTABLE
3	2P	Hunter	INST-06-CV-MP40	40	0.19	ADJUSTABLE
2	2S	Hunter	INST-06-CV-MPLCS515	40	0.22	LEFT
2	2T	Hunter	INST-06-CV-MPRCS515	40	0.22	RIGHT
1	2U	Hunter	INST-06-CV-MPSS530	40	0.44	SIDE

GRAPHIC SCALE

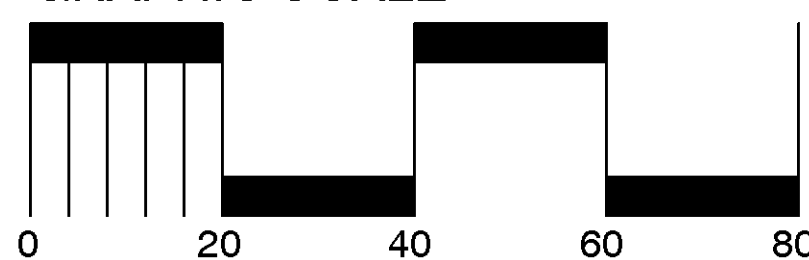

NORTH

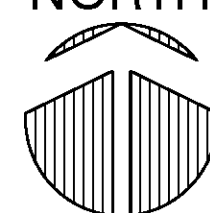

IRRIGATION PLAN

SCALE : 1" = 20' - 0"

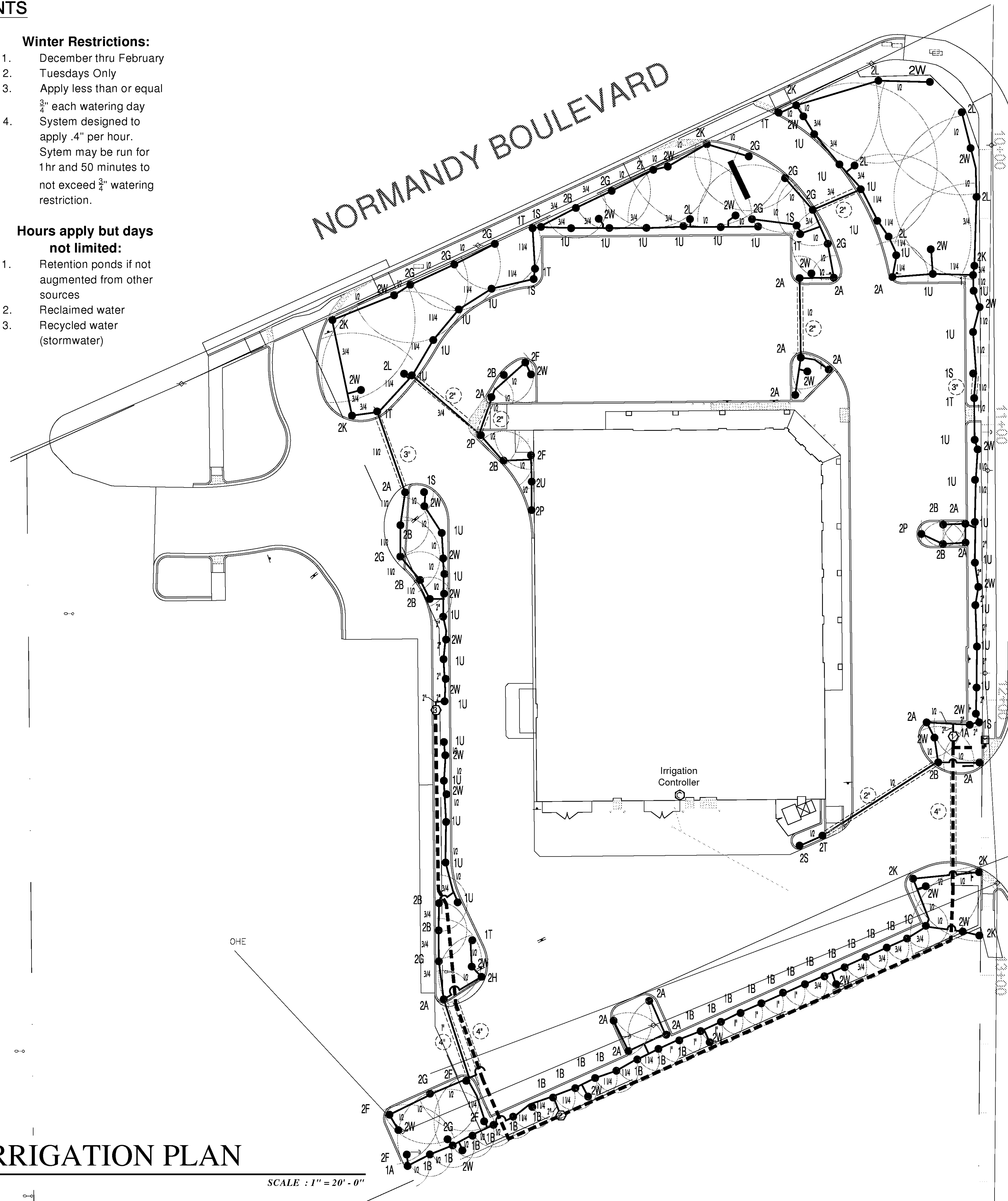

NOTES

- Irrigation Contractor shall be responsible for all applicable fees and permits.
- All Pipe and Wire under paving shall be placed in Schedule 40 P.V.C. Sleeves for the full pavement coverage length and shall be at least 24" below grade.
- Mainlines shall be buried to provide a minimum cover of 18", while all Lateral lines shall have a minimum of 12".
- The Contractor should take care to reroute piping as necessary to avoid plant or tree roots.
- All Sprinklers shall be site adjusted to prevent water overthrow onto building surfaces and walkways.
- All Control Wiring to be 14/1 UF, direct burial. Install a "MiniClick" rain sensor device. Verify location with Owners Representative.
- Install Backflow Preventer in an inconspicuous location such as shrubbery.
- Location shown for graphic clarity purposes only.
- Contractor responsible for 100% Irrigation coverage.
- All Irrigation risers to be painted black.
- Mainline location shown for graphic clarity purposes only.
- Valve box location shown for graphic clarity purposes only.
- Irrigation system designed to not exceed 5 feet per second flow through any piping. Any deviation from design upon installation shall be done so as to not exceed 5' per second through any piping as well.
- Irrigation Rain Sensor to be located on Satellite Mast or Roof - See Architect's Plan / Sheet "A1.4" 14 GA wire and conduit for Irrigation sensor will be provided by and installed by GC's Electrical Sub-Contractor.

NO.	DATE	DESCRIPTION	BY
1.	01-08-2009	As/CDI Dev. Review Comments	JCC
2.	05-21-2009	As/CDI Dev. Review Comments	JCC
3.	08-11-2009	No Existing Pond Improvements	JCC
4.	11-23-2009	As per Owner's Arch's Markup	JCC
5.	12-04-2009	Indicate Proposed Line Poles	JCC
6.	02-03-2010	Final Revisions as per Owner	JCC

THIS DRAWING IS AN INSTRUMENT OF SERVICE AND THE PROPERTY OF SUNSHINE DESIGN, AND SHALL REMAIN THEIR PROPERTY. THE USE OF THIS DRAWING IS RESTRICTED TO THE ORIGINAL SITE FOR WHICH IT IS PREPARED AND PUBLICATION THEREOF IS EXPRESSLY LIMITED TO SUCH USE.

Walgreen's
Normandy Blvd. and Fouraker Road
A Development by:
Rock Ventures, LLC

IRRIGATION PLAN

SUNSHINEDESIGN
Chris Commins ASLA
PMB 368 | 1445-26 State Road 13 | Fruit Cove, Florida 32259
PH: 904-233-4808 Email: chris@chriscommins.com

DATE
12-05-2008
DRAWN BY
JCC / SP
SHEET NO.
LS-2