

REVISIONS	BY
△ CITY REVIEW 1-29-07	RAC
△ SITE ADJUST. 10-16-07	RAC

DRMP
ENGINEERS • SURVEYORS • PLANNERS • SCIENTISTS

1505 East Colonial Drive - Orlando, Florida 32803
Phone: 407.896.0594 Fax: 407.896.4836
Florida Certificate of Authorization No. 2648

Dyer, Riddle, Mills, & Precourt, Inc.

WARNING
IF THIS BAR DOES NOT MEASURE 1" = 30' THIS COPY OF THIS PLAN IS NOT TO SCALE

JAN 17 2008
RANDALL A. CAVE
FLORIDA R.L.#1694

ABC LIQUORS, INC.
8888 S. ORANGE AVE. - ORLANDO, FLA. 32824

ABC FINE WINE & SPIRITS STORE #50
SAWGRASS MILLS, NORTH FLAMINGO ROAD, SUNRISE, FLORIDA

LANDSCAPE PLAN

DRAWN: RAC
CHECKED: RAC
DATE: Sept. 21, 2005
SCALE: 1" = 30'
JOB No: 05-0344.000

SHEET: C6

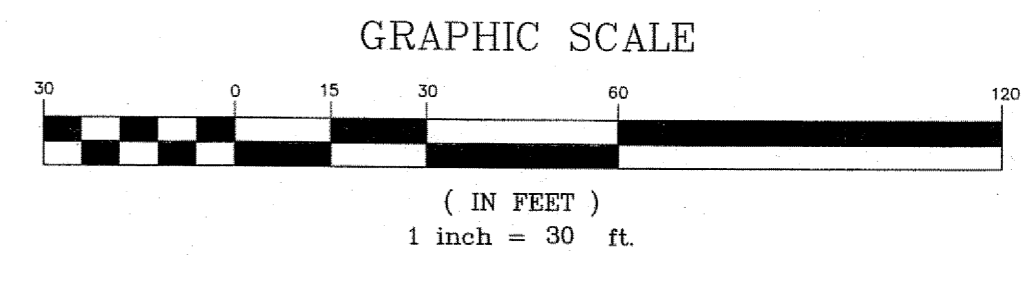
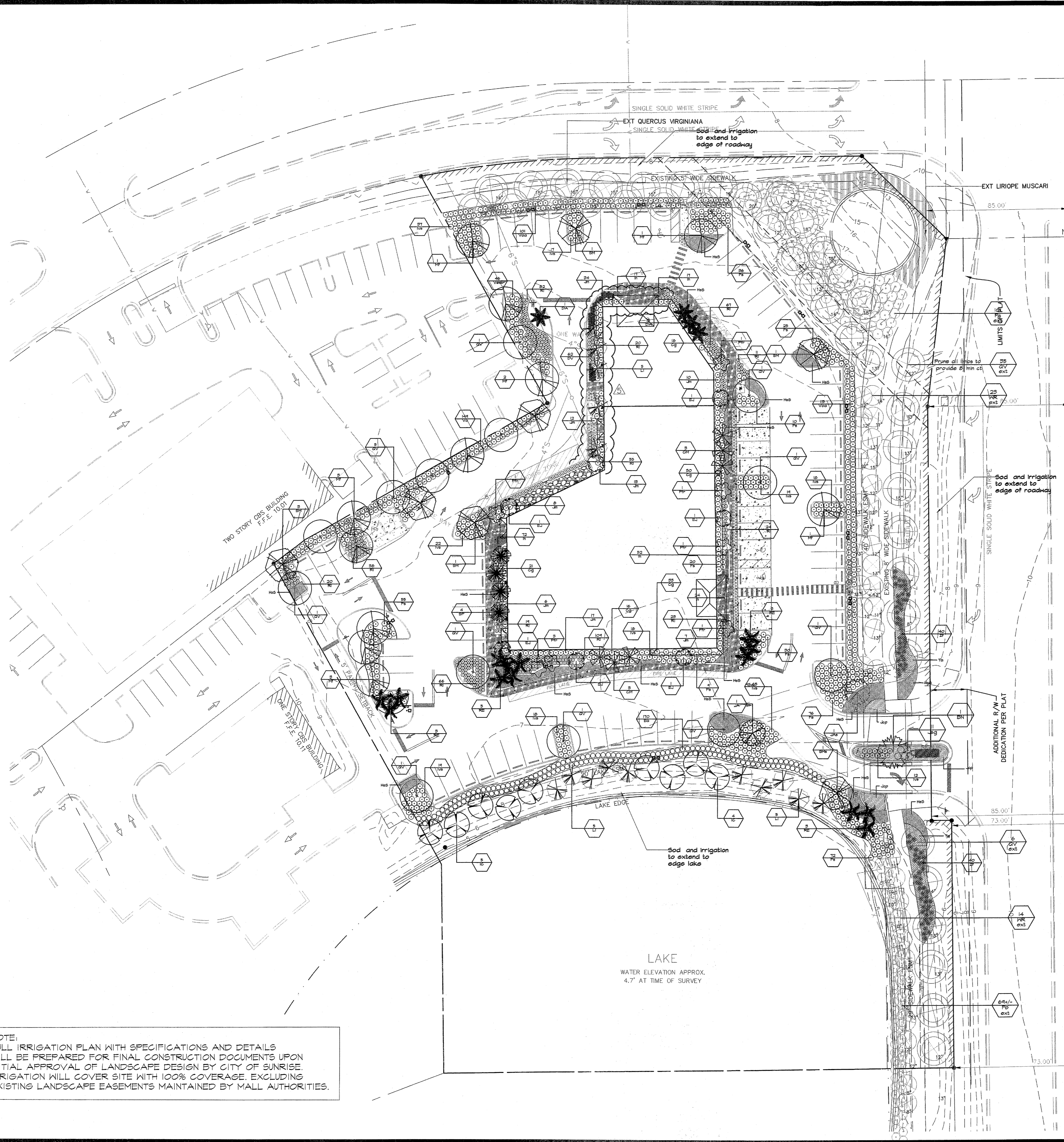

- LANDSCAPE NOTES:**
- THE CITY OF SUNRISE REQUIRES A LANDSCAPE PRE-CONSTRUCTION CONFERENCE A MINIMUM OF TWO MONTHS BEFORE FINAL LANDSCAPE INSPECTION. THE CITY OF SUNRISE WILL REJECT ALL PLANT MATERIAL WHICH IS NOT FLORIDA NUMBER ONE AND ALL FIELD GROWN TREES, WHICH DO NOT HAVE NEW ROOTS GROWING THROUGH THE BURLAP. ALL SPECIES SUBSTITUTIONS OR REVISIONS TO THESE PLANS WILL BE CAUSE FOR REJECTION UNLESS APPROVED BY THE CITY OF SUNRISE IN ADVANCE OF PLANTING.
 - WHERE DISCREPANCIES EXIST, THE CITY OF SUNRISE LAND DEVELOPMENT CODE SECTION 16-161 THROUGH 16-174 SHALL GOVERN.
 - LANDSCAPE TABULAR DATA:
 - TOTAL TREES REQUIRED FOR SITE = 266
 - TOTAL TREES SHOWN = 97 (NOT INCLUDING EXISTING WASHINGTONIA'S or LIVE OAKS)
 - TREES = 72
 - PALMS = 25
 - TOTAL NEW PALMS SHOWN = (26%)
 - 3. DUE TO ORIGINAL DESIGN BUT FORTH IN DEVELOPMENT ORDER, BERM IS NOT ABLE TO BE IMPLEMENTED DUE TO EXISTING SPECIMEN OAKS ALONG R/W AREA.
 - 4. ALL EXISTING OAKS ARE USED IN OVERALL CALCULATIONS TO MEET 28% SPECIMEN REQUIREMENT. HOWEVER, THERE ARE 2 OTHER SPECIMEN TREES USED AT THE ENTRANCE TO THIS PROJECT FOR A TOTAL OF 44 SPECIMEN TREES (24%)
 - LANDSCAPE STRIP ADJACENT TO R/W:
 - REQUIRED = 1 TREE PER 25 LF
 - TOTAL LF = 851
 - TOTAL TREES REQUIRED = 34 TREES
 - TOTAL TREES SHOWN = 16 (41%)
 - TREES = 42 (EXISTING)
 - PALMS = 35 (EXISTING WASHINGTONIA'S) NOT COUNTED TOWARDS ANY REQUIREMENTS
 - LAKE LANDSCAPE:
 - REQUIRED = 1 TREE PER 20 LF
 - TOTAL LF = 280
 - TREES REQUIRED = 14 TREES
 - TOTAL TREES SHOWN = 14 (100%)
 - TREES = 0
 - PALMS = 0
 - ENTRY FEATURE LANDSCAPE:
 - 50' PARALLEL TO R/W (TOTAL 60 LF) @ 1 TREE PER 25 LF (AND FULL LENGTH OF DRIVE PERPENDICULAR TO R/W)
 - TREES REQUIRED = 7
 - TREES SHOWN = 2 (NOT INCL. ANY PALMS SHOWN)
 - MID-SURFACES SHOWN = 20
 - LOW-GROUND COVER = 100% OF REMAINING BED
 - PARKING AREA INTERIOR LANDSCAPING:
 - PARKING SPACES = 74
 - REQUIRED TREES @ 1 PER ISLAND = 10
 - ISLAND TREES SHOWN = 14
 - FOUNDATION AND PEDESTRIAN ZONE LANDSCAPING:
 - PEDESTRIAN ZONE = 456 LF
 - TREES REQUIRED = 15
 - TREES SHOWN = 15
 - LANDSCAPE STRIP = 16-41 LF
 - TREES REQUIRED = 0
 - TREES SHOWN = 7
 - TREE PRESERVATION:
 - ALL EXISTING TREES ON SITE ARE TO BE PRESERVED (SEE SHEET C-62 FOR TREE PRESERVATION PLAN AND DETAIL)
 - ALL EXISTING TREES MUST BE PRUNED TO A MINIMUM OF 6' ABOVE PEDESTRIAN WALK OR BIKE PATH

CITY OF SUNRISE
PLANNING & DEVELOPMENT DEPT.
REVISED FINAL PLANS
APPROVED FOR INSTALLATION EXCEPT AS NOTED
FEB 21 2008

DATE:
ADDITIONAL REQUIREMENTS PRIOR TO CONSTRUCTION:
-PRE-CONSTRUCTION MEETING WITH CITY
-PERMITS FROM APPLICABLE REGULATORY AUTHORITIES AND THE CITY
COMPLETE SET OF APPROVED PLANS MUST BE ON WORK SITE AT ALL TIMES.

PLANT LIST

Quantity	Code Name	Scientific Name	Common Name	Planting Size	Spacing
4	IC	Ilex coccinea	Coconut Holly	12' x 6' minimum	
1	JH	Jacaranda acutata	Jacaranda	16-18" min	Specimen
1	JA	Jacaranda acutata	Jacaranda	12' x 6' minimum	
8	LI	Lagerstroemia indica	Grape Myrtle	12' x 6' minimum	
6	SH	Shorea robusta	Hologany	16-18" min	Specimen
6	SH	Shorea robusta	Hologany	12' x 6' minimum	
Broadleaf Evergreen					
1	LI	Liriodendron chinensis	Liquidambar	14" x 6" SPREAD minimum	
1	SI	Myrsine laevis	Stephan's Stopper	12' x 6' minimum	
2	FR	Flacourtia spp.	Frangipani	16-18" x 6" SPREAD minimum	
15	OV	Ocotea virginiana	Southern live oak	12' x 6' minimum	
40	OV	Quercus virginiana*	Southern live oak	Size vary see Tree Prot. Plan EXISTING	
Ground Cover					
62	DV	Dioscorea sp.	African Iris	1 gal. 3 lbs. 12"x18" min	15' o.c.
248	IV	Ilex vomitoria 'Schillinge Dwarf'	Schillinge Yaspion	50" min. spread	3' o.c.
182	IS	Iris hexagona	Blue Flag	1 gal. 3 lbs. 12"x18" min	1' o.c.
246	JL	Juniperus densata 'Parsoni'	Parson's Juniper	12"x18" min	2' o.c.
592	RI	Rapanea indica	Indian Hawthorn	18" x 18" min	2' o.c.
188	TS	Trochodendron araliifolium	Yellow Star Jasmine	4" pot	15' o.c.
Palm					
1	BN	Bismarckia nobilis	Bismarck Palm	16-18" x 6" SPREAD	
6	CH	Caryota mitis	Parrot Palm	16-18" x 6" SPREAD	
4	DA	Didymopanax album	Hurricane Palm	16-18" x 6" SPREAD	
14	HC	Heptapleuron sp.	Hurricane Palm	16-18" x 6" SPREAD	
4	SP	Subul palm	Subul Palm	16-18" x 6" SPREAD	
36	PR	Washingtonia robusta*	Mexican fan palm	Size vary see Tree Prot. Plan EXISTING	
Perennial					
1880	H6	Hemerocallis spp. 'Stella D'Oro'	Stella Daylily	1-1/2 gal. 3 lbs. 12"x18" min	1' o.c.
Shrub					
101	CG	Cornus grandiflora	Nobis plus	50"x50" min/spacing	3' o.c.
593	PA	Palafoxia latifolia	Princess Palm	50"x24" min/spacing	3' o.c.
244	FB	Ficus benjamina 'Pendula'	Flora	50"x24" min/spacing	EXISTING
109	JN	Juniperus horizontalis	Creeping Juniper	50"x24" min/spacing	3' o.c.
11	JL	Juniperus chinensis 'Blue Green'	Blue Green Juniper	50"x24" min/spacing	3' o.c.
170	SI	Sida acuta	Staggered Row	50"x24" min, staggered row	EXISTING
101	PS	Philodendron selloum*	Big Leaf Philodendron	16-18" x 6" SPREAD	EXISTING
141	VO	Viburnum odoratissimum	Sweet Viburnum	50" x24" min, staggered row	15' o.c.
221	VO	Viburnum odoratissimum 'Aureum'	Golden Viburnum	50" x24" min, staggered row	15' o.c.
80	ZI	Zamia furcata	Cardinal Palm	50"x24" min 1st planting	35' o.c.

NOTE:
FULL IRRIGATION PLAN WITH SPECIFICATIONS AND DETAILS WILL BE PREPARED FOR FINAL CONSTRUCTION DOCUMENTS UPON INITIAL APPROVAL OF LANDSCAPE DESIGN BY CITY OF SUNRISE. IRRIGATION WILL COVER SITE WITH 100% COVERAGE, EXCLUDING EXISTING LANDSCAPE EASEMENTS MAINTAINED BY MALL AUTHORITIES.

05_50_LandscapePlan.dwg