

REVISIONS	BY
△ CITY REVIEW 1-29-07	RAC

**DRMP**  
ENGINEERS • SURVEYORS • PLANNERS • SCIENTISTS

1505 East Colonial Drive - Orlando, Florida 32803  
Phone: 407.896.0594 Fax: 407.896.4836  
Florida Certificate of Authorization No. 2648

Dyer, Riddle, Mills, & Precourt, Inc.

WARNING  
IF THIS BAR DOES NOT MEASURE UP TO THIS DOCUMENT IS NOT TO SCALE

FEB 08 2007  
RANDALL A. CAVE  
FLORIDA R.A. #1694

**ABC LIQUORS, INC.**  
8888 S. ORANGE AVE. - ORLANDO, FLA. 32824

**ABC FINE WINE & SPIRITS STORE #50**  
SAWGRASS MILLS, NORTH FLAMINGO ROAD, SUNRISE, FLORIDA

**LANDSCAPE DETAILS**

DRAWN: RAC  
CHECKED: RAC  
DATE: Sept. 2, 2005  
SCALE:  
JOB No: 05-0344.000  
SHEET:

**C6b**

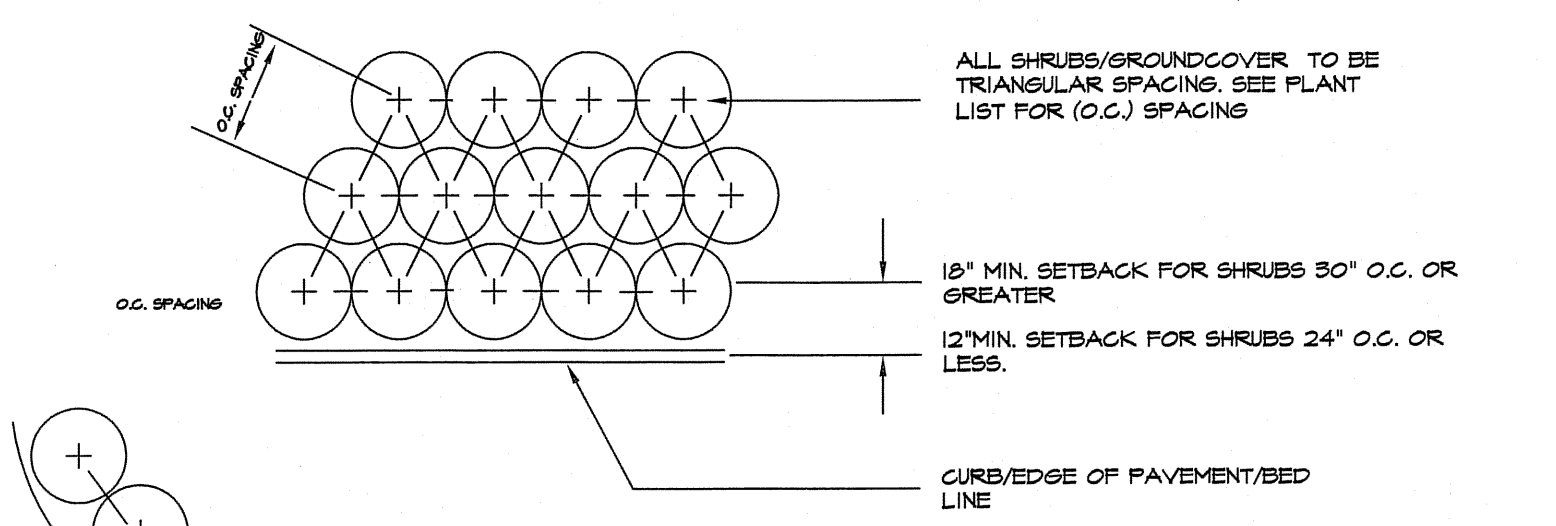

SHRUB SPACING DETAIL

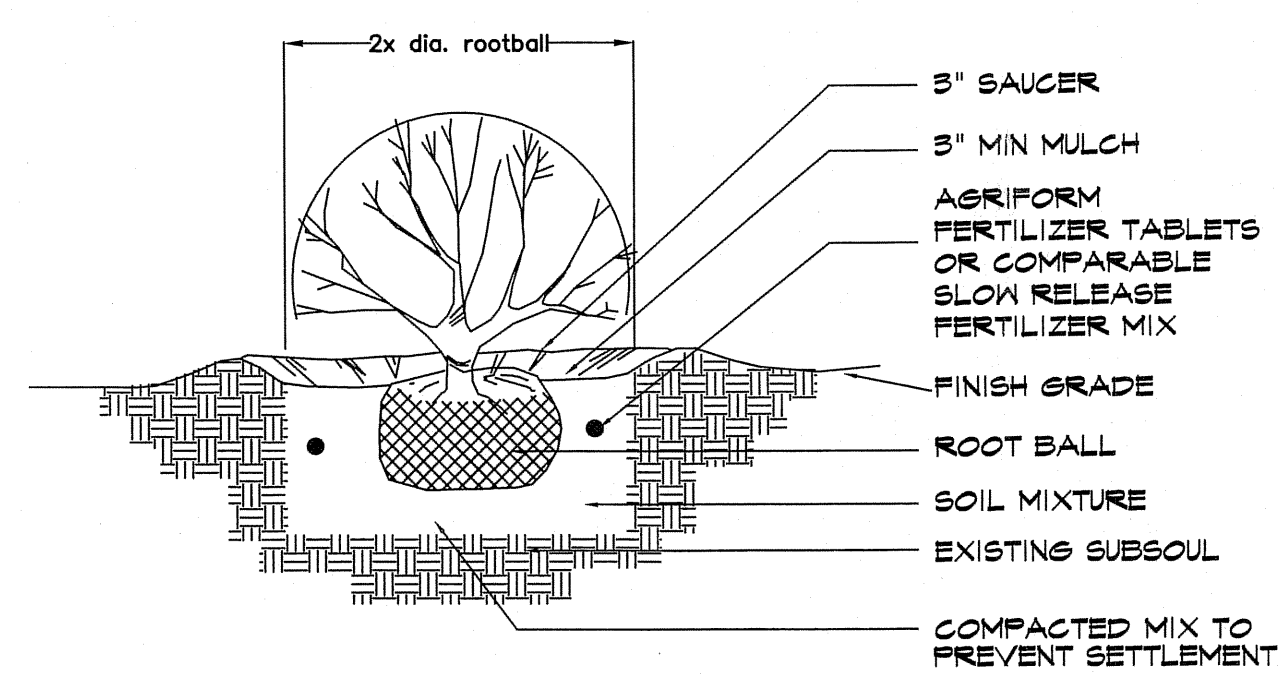

SHRUB PLANTING DETAIL

NOTE:  
1. SEE LANDSCAPE NOTES FOR THE TYPE OF MULCH MATERIAL TO USE.  
2. ALL PLANTING PITS SHALL BE DUG OR TILLED AND LOOSENED TO A MINIMUM OF 2X THE DIAMETER OF THE ROOTBALL.

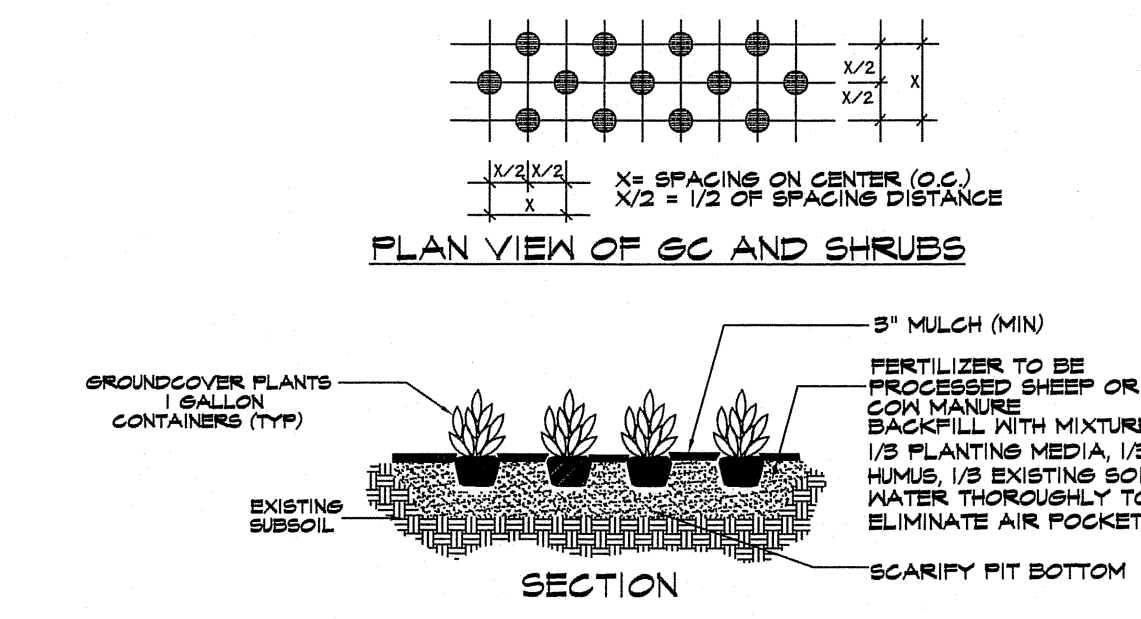

GROUNDCOVER PLANTING DETAIL

NOTE:  
1. SEE LANDSCAPE NOTES FOR THE TYPE OF MULCH MATERIAL TO USE.  
2. ALL PLANTING PITS SHALL BE DUG OR TILLED AND LOOSENED TO A MINIMUM OF 2X THE DIAMETER OF THE ROOTBALL.

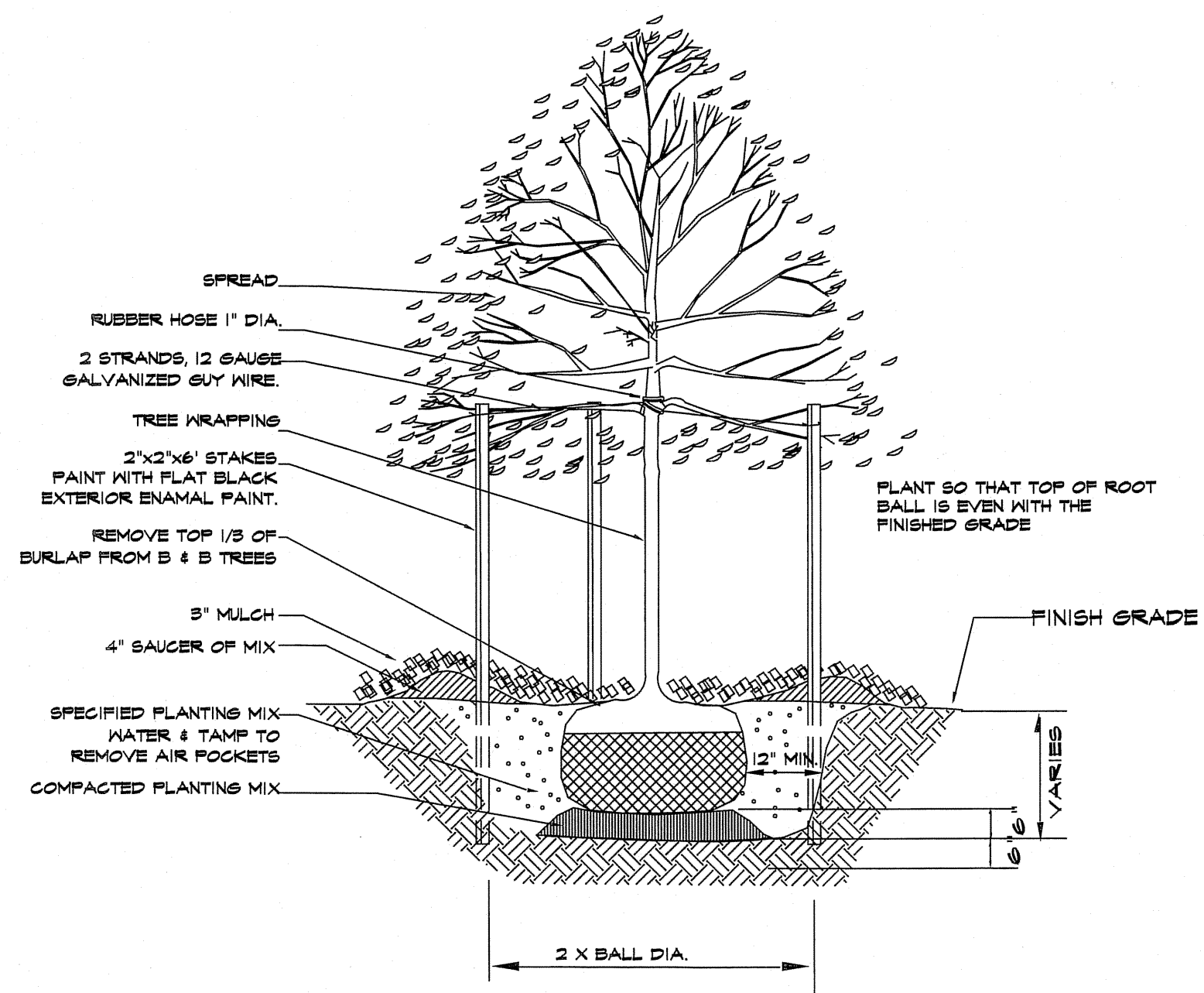

TREE PLANTING DETAIL  
N.T.S.

NOTE:  
1. SEE LANDSCAPE NOTES FOR THE TYPE OF MULCH MATERIAL TO USE.  
2. ALL PLANTING PITS SHALL BE DUG OR TILLED AND LOOSENED TO A MINIMUM OF 2X THE DIAMETER OF THE ROOTBALL.

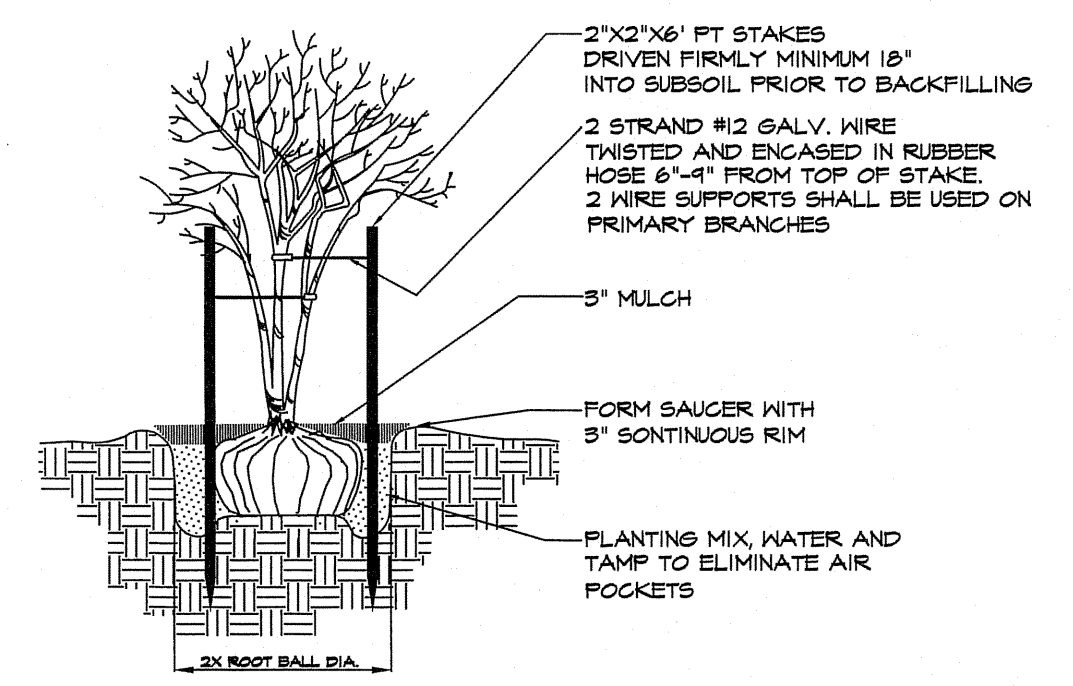

MULTI-TRUNK TREE STAKING - SECTION

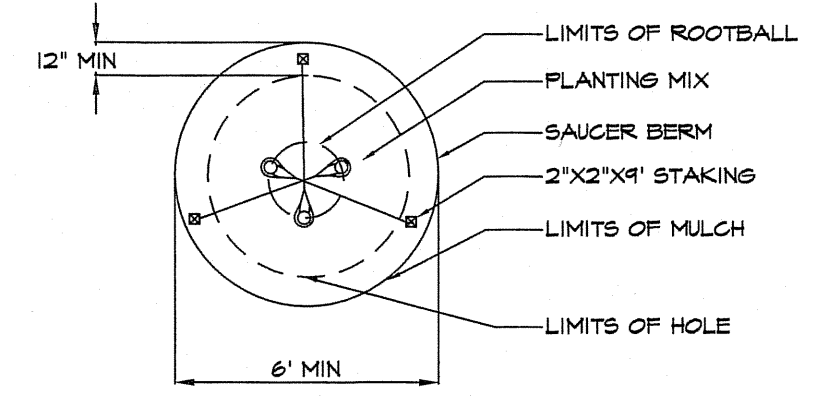

MULTI-TRUNK TREE STAKING - PLAN

NOTE:  
1. SEE LANDSCAPE NOTES FOR THE TYPE OF MULCH MATERIAL TO USE.  
2. ALL PLANTING PITS SHALL BE DUG OR TILLED AND LOOSENED TO A MINIMUM OF 2X THE DIAMETER OF THE ROOTBALL.

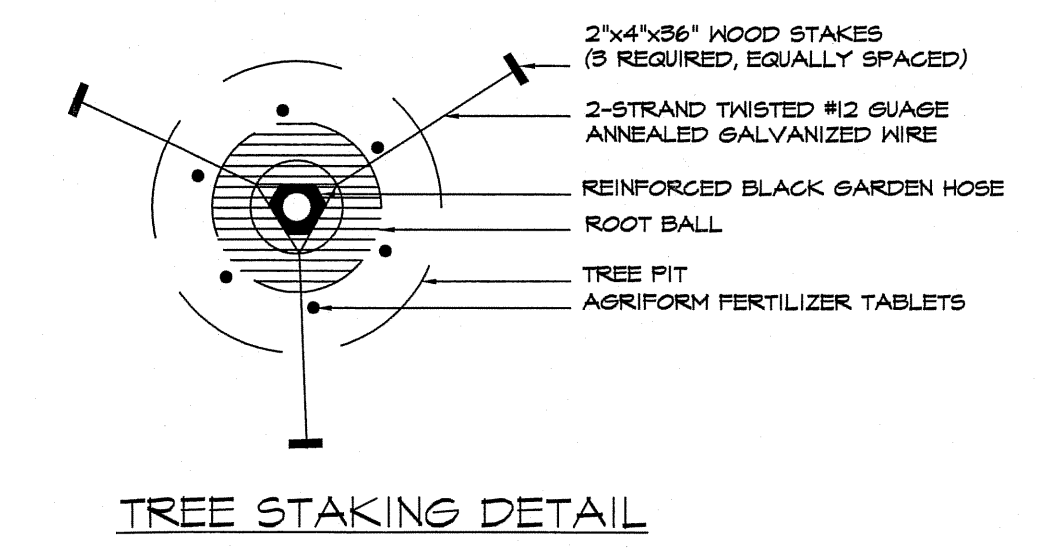

TREE STAKING DETAIL

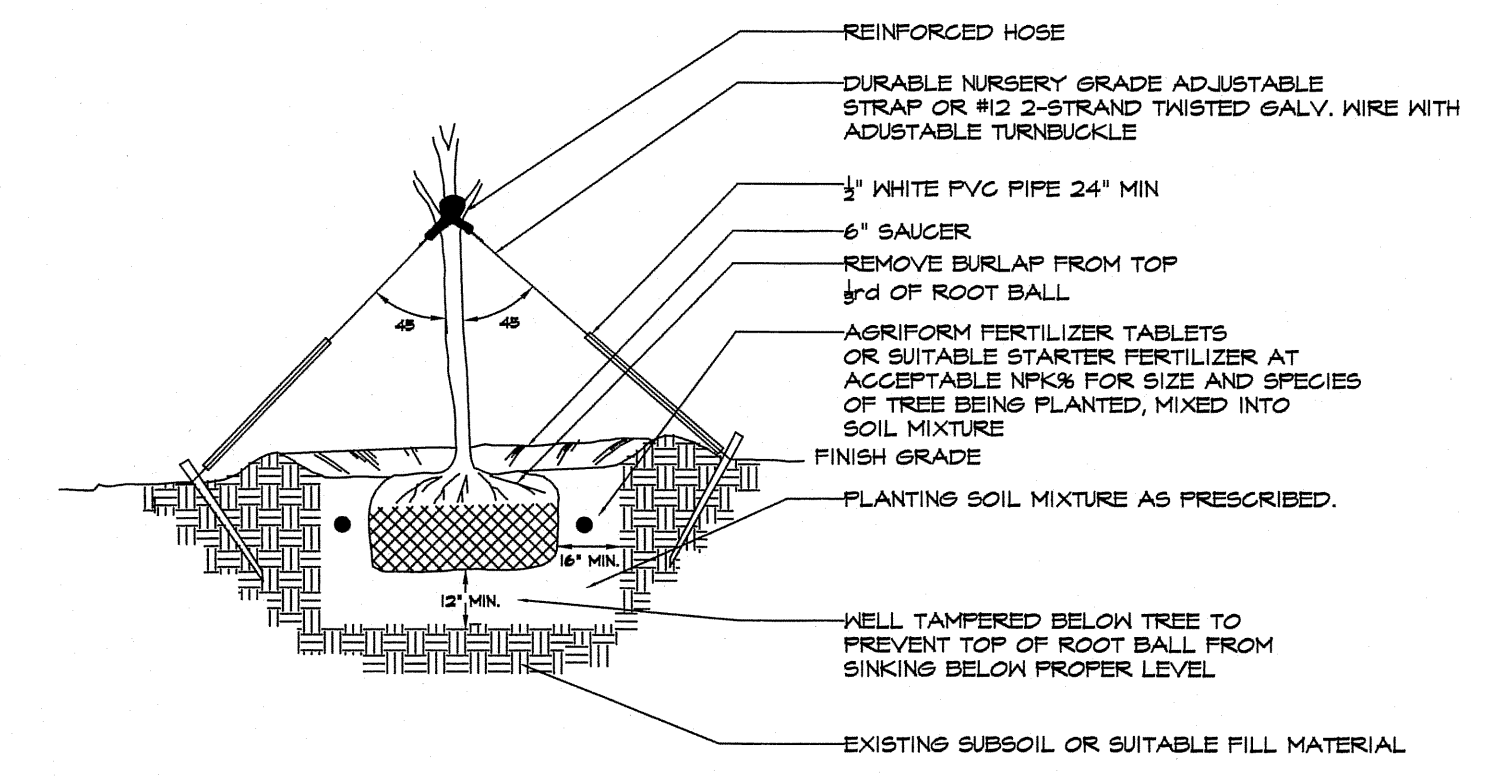

TREE PLANTING DETAIL

NOTE:  
1. SEE LANDSCAPE NOTES FOR THE TYPE OF MULCH MATERIAL TO USE.  
2. ALL PLANTING PITS SHALL BE DUG OR TILLED AND LOOSENED TO A MINIMUM OF 2X THE DIAMETER OF THE ROOTBALL.

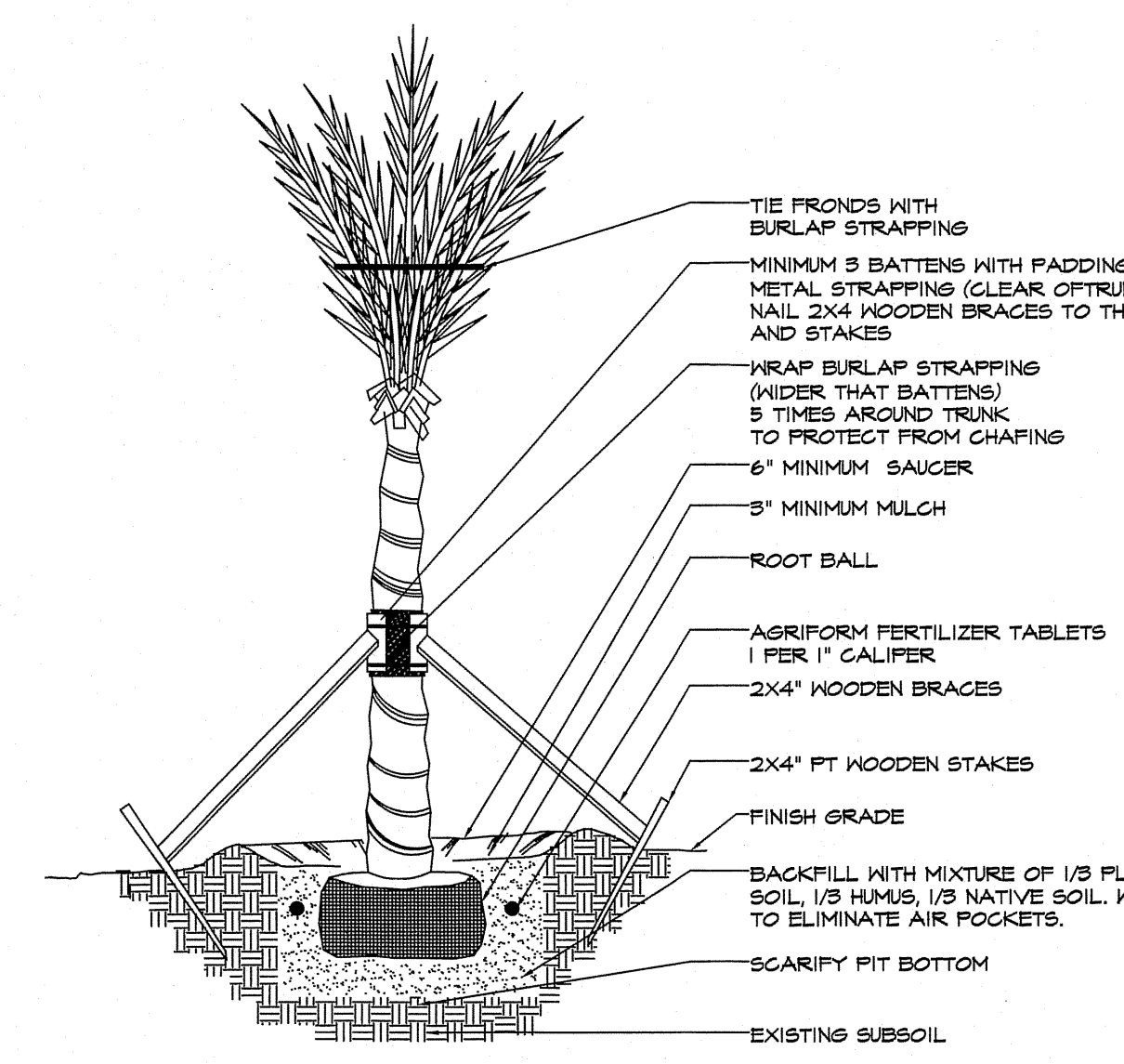

PALM PLANTING DETAIL

NOTE:  
1. SEE LANDSCAPE NOTES FOR THE TYPE OF MULCH MATERIAL TO USE.  
2. ALL PLANTING PITS SHALL BE DUG OR TILLED AND LOOSENED TO A MINIMUM OF 2X THE DIAMETER OF THE ROOTBALL.

CITY OF SUNRISE  
PLANNING & DEVELOPMENT DEPT.

**FINAL PLANS**  
APPROVED FOR INSTALLATION  
EXCEPT AS NOTED  
MAR 28 2007

DATE:  
ADDITIONAL REQUIREMENTS PRIOR TO CONSTRUCTION:  
• PRE-CONSTRUCTION MEETING WITH CITY  
• PERMITS FROM APPLICABLE REGULATORY AUTHORITIES AND THE CITY

COMPLETE SET OF APPROVED PLANS MUST BE ON WORK SITE AT ALL TIMES.

C:\Users\jgarcia\Desktop\05-0344\05-0344-000\_0502\_Spec\_Swagras\_Mills\_MultiTrunkStaking\_Prelim\SUBMITTALS\05b\_50\_LandscapeDetails.dwg 2/26/2007 10:41:22 AM jgarcia