

SHRUB SPACING DETAIL

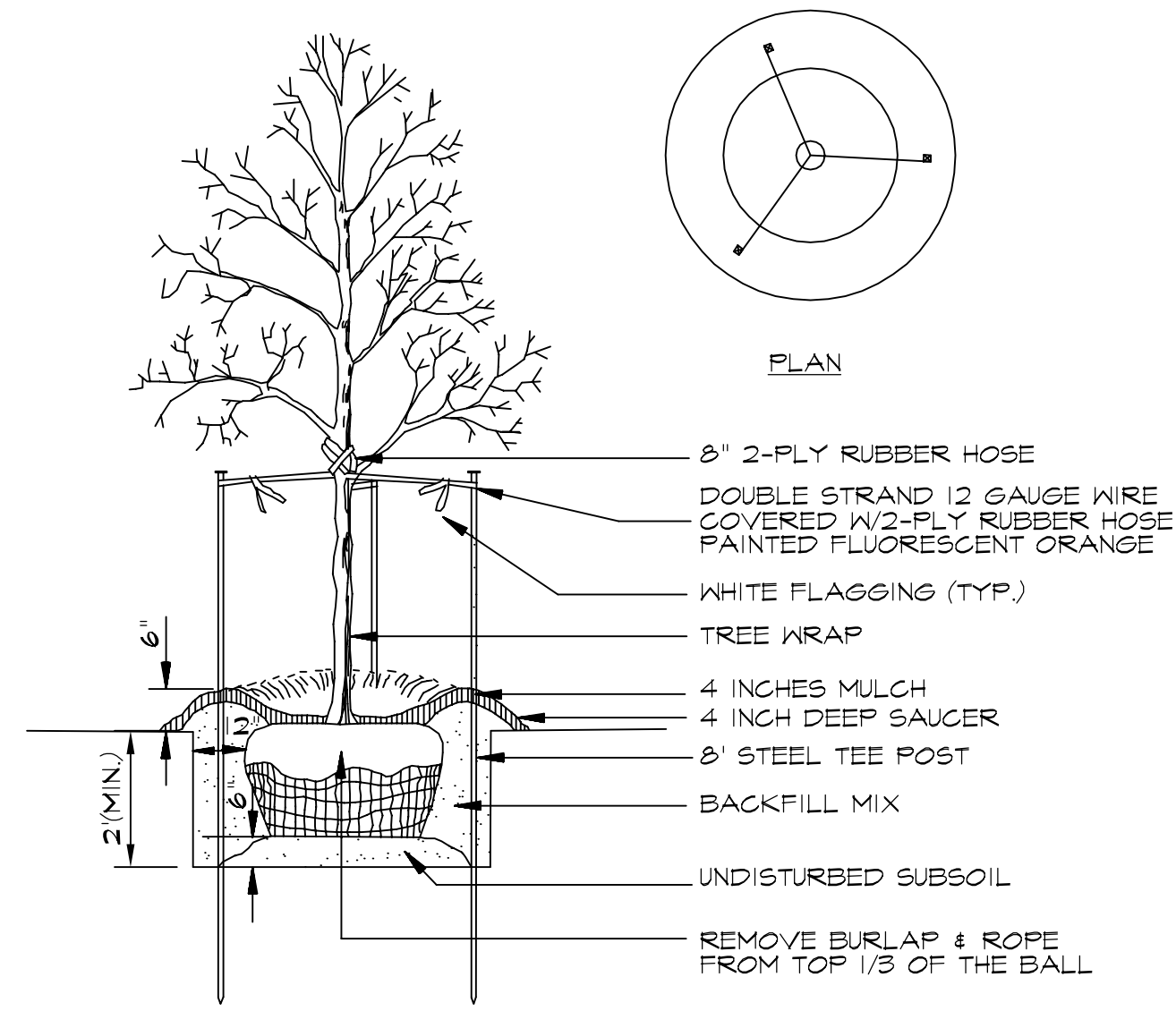

NOTE: SEE LANDSCAPE NOTES FOR THE TYPE OF MULCH MATERIAL TO USE.

TREE PLANTING DETAIL
N.T.S.

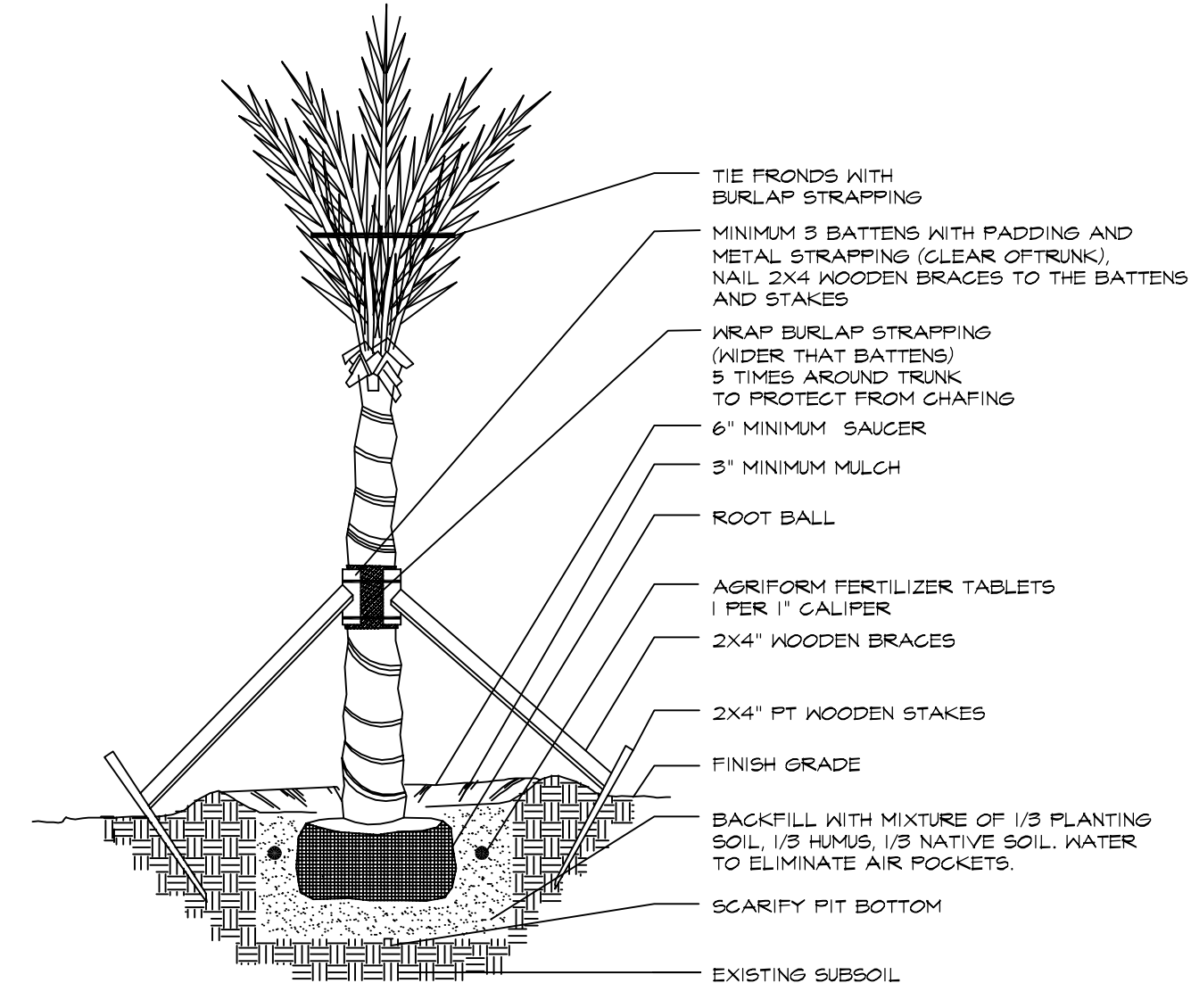

PALM PLANTING DETAIL

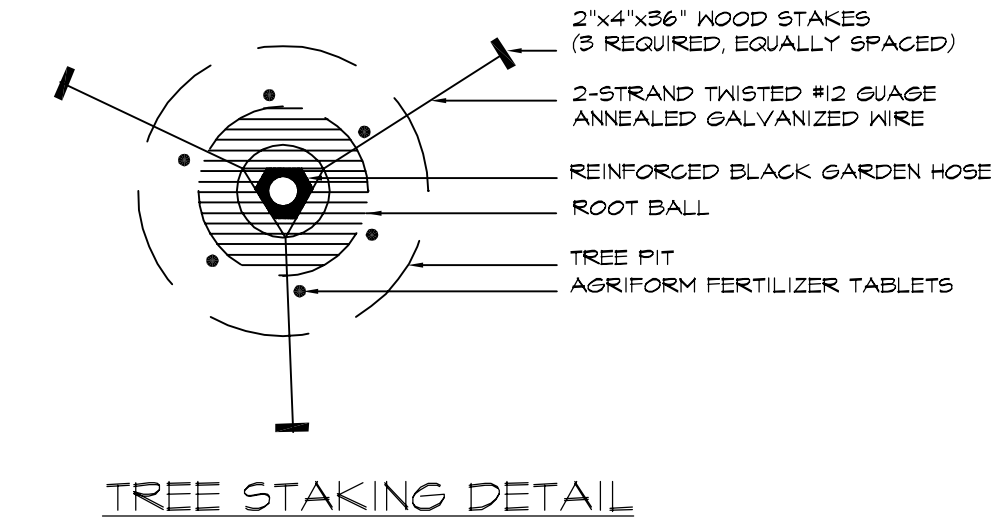

TREE STAKING DETAIL

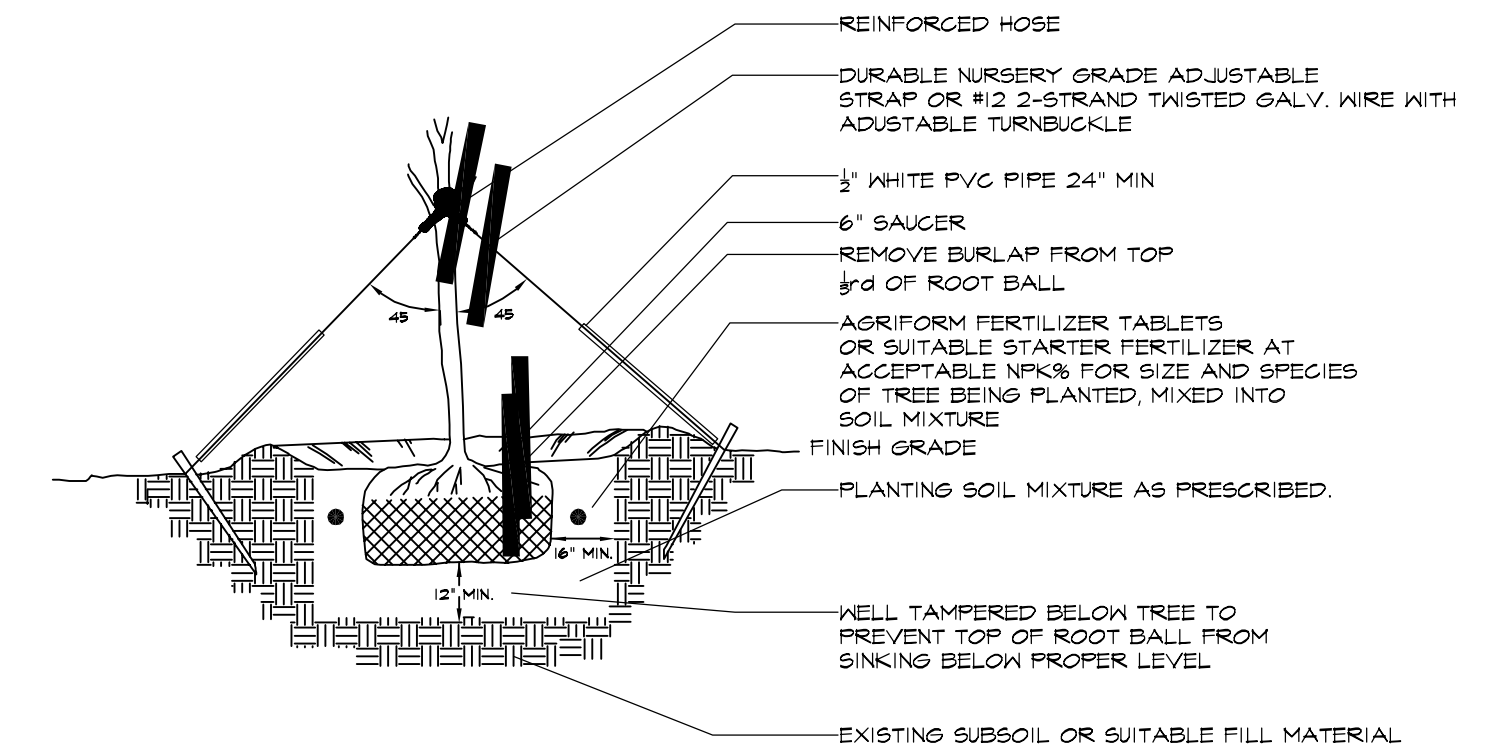

TREE PLANTING DETAIL

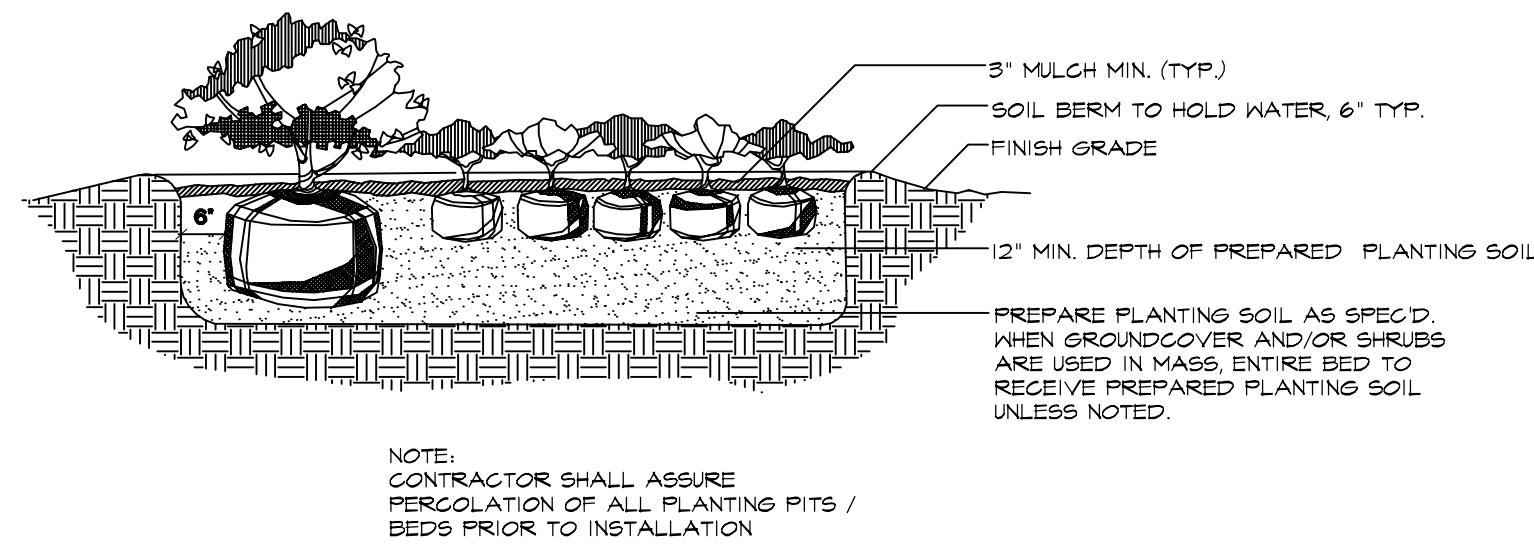

SHRUB AND GROUND COVER DETAIL

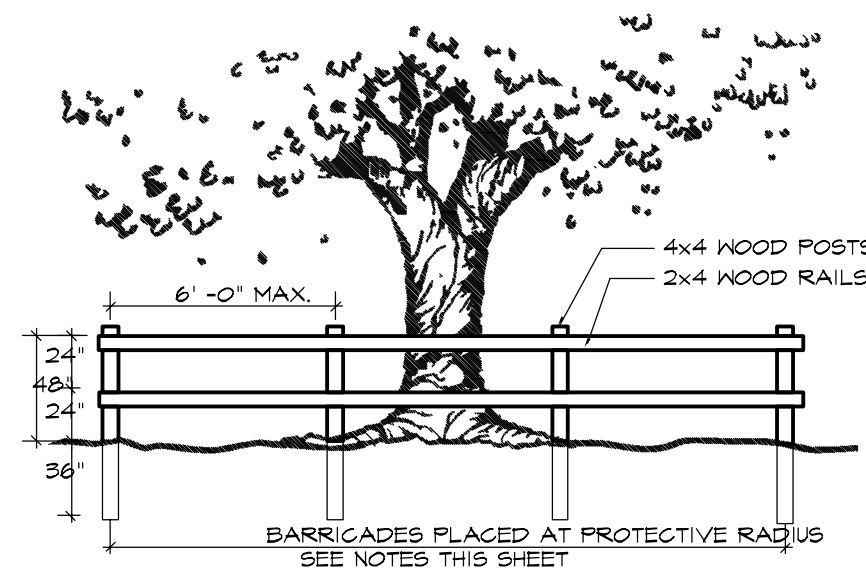

TREE PROTECTION BARRICADE DETAIL

TREE PROTECTION REQUIREMENTS

- PROTECT DESIGNATED EXISTING TREES SCHEDULED TO REMAIN AGAINST:
 - UNNECESSARY CUTTING, BREAKING, OR SKINNING OF ROOTS
 - SKINNING AND BRUISING OF BARK
 - SMOTHERING OF TREES BY STOCKPILING CONSTRUCTION OR EXCAVATION MATERIALS WITHIN DRIP-LINE
 - EXCESS FOOT OR VEHICULAR TRAFFIC
 - PARKING VEHICLES WITHIN DRIP-LINE
- ERECT TEMPORARY WOODEN BARRICADES AS SHOWN ON THIS SHEET (PLAN & DETAIL), BEFORE COMMENCEMENT OF ANY SITE CLEARING OR GRADING. FENCE TO BE 4' HIGH MINIMUM WITH 4 X 4 POSTS AND 2-2X4 RAILS AT 2' AND 4' ABOVE GRADE AND SHALL BE SET DEEP ENOUGH IN THE GROUND TO BE STABLE WITHOUT ADDITIONAL SUPPORT. ALL FENCING SHOULD BE A MINIMUM CLEAR DISTANCE OF 6' FROM THE FACE OF ANY TREES 12" DBH AND UNDER AND SHALL FULLY ENCLOSE ALL TREES SCHEDULED TO REMAIN. NOTHING SHALL BE PLACED INSIDE OF PROTECTIVE BARRICADES, INCLUDING BUT NOT LIMITED TO CONSTRUCTION MATERIAL, MACHINERY, CHEMICALS, OR TEMPORARY SOIL DEPOSITS. ON TREES LARGER THAN 12" DBH, BARRICADES SHALL BE NO CLOSER THAN 10' FROM FACE OF TREE. WHEN PAVING, EXCAVATION, OR HARDSCAPE MUST BE DONE WITHIN BARRICADES. BARRICADES SHALL BE MOVED BACK TO A SECONDARY LOCATION AT EDGE OF WORK. EXTRA CARE MUST BE TAKEN AT THIS TIME BY THE CONTRACTOR TO INSURE THAT NO DAMAGE TO THE TREE OCCURS.
- PROVIDE WATER TO TREES AS REQUIRED TO MAINTAIN THEIR HEALTH DURING CONSTRUCTION WORK.
- WHEN NECESSARY TO CUT ROOT OVER 1-1/2" DIAMETER OF TREES TO REMAIN, CUT MUST BE A CLEAN CUT. COAT CUT FACES OF ROOTS WITH AN EMULSIFIED ASPHALT OR OTHER ACCEPTABLE COATING FORMULATED FOR USE ON DAMAGED PLANT TISSUE. TEMPORARILY COVER EXPOSED ROOTS WITH NET BURLAP TO PREVENT DRYING AND COVER WITH EARTH AS SOON AS POSSIBLE.
- NO GRADE CHANGES ARE TO BE MADE WITHIN THE BARRICADES WITHOUT PRIOR APPROVAL OF THE OWNER OR HIS DESIGNATED REPRESENTATIVE.
- INTERFERING BRANCHES MAY BE REMOVED AT THE DIRECTION OF THE OWNER OR HIS DESIGNATED REPRESENTATIVE, BY A QUALIFIED TREE SURGEON.
- REPAIR OR REPLACE TREES INDICATED TO REMAIN WHICH ARE DAMAGED IN THE CONSTRUCTION OPERATIONS, IN A MANNER ACCEPTABLE TO THE OWNER. EMPLOY A QUALIFIED TREE SURGEON TO REPAIR MAJOR DAMAGES TO TREES AND SHRUBS, PROMPTLY, TO PREVENT PROGRESSIVE DETERIORATION CAUSED BY THE DAMAGE.
- GENERAL CONTRACTOR SHALL BE RESPONSIBLE FOR THE REPLACEMENT OF TREES DAMAGED BEYOND REPAIR WITH 3 TREES OF SIMILAR QUALITY AND SPECIES, SIZED TO MATCH THE LARGEST TREES OF THAT SPECIES BEING PLANTED AS PER THE LANDSCAPE PLANS. IF TREES ARE HARMED THROUGH LACK OF PROTECTION OR THROUGH NEGLIGENCE ON THE PART OF THE CONTRACTOR, THE CONTRACTOR SHALL BEAR THE BURDEN OF THE COST OF REPAIR OR REPLACEMENT.

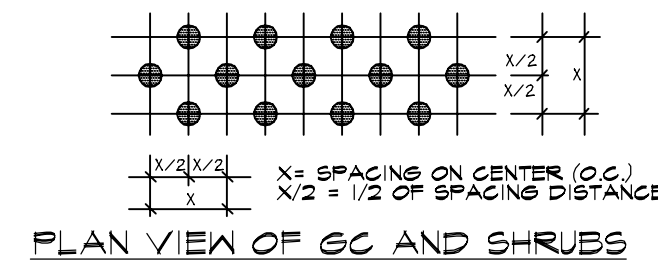

PLAN VIEW OF GC AND SHRUBS

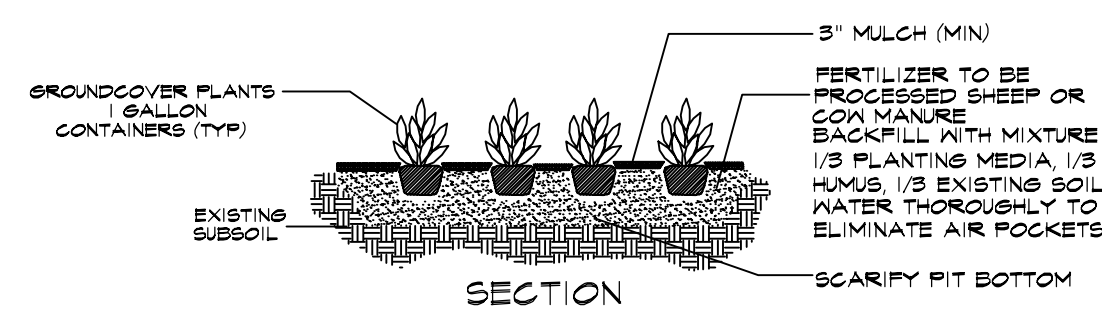

GROUND COVER PLANTING DETAIL

REVISIONS	BY
Δ CITY COMMENTS	

DRMP
ENGINEERS • SURVEYORS • PLANNERS • SCIENTISTS
941 Lake Baldwin Lane - Orlando, Florida 32814
Phone: 407.896.0594 Fax: 407.896.4836
Florida Certificate of Authorization No. 2648

Dyer, Riddle, Mills, & Precourt, Inc.

WARNING
IF THIS BAR DOES NOT MEASURE, IT IS NOT TO SCALE

SCOTT V. MOORE
FLORIDA R.L.A. #1020

ABC LIQUORS, INC.
8889 S. ORANGE AVE. - ORLANDO, FLA. 32824
ABC FINE WINE & SPIRITS STORE NO. 59
U.S. HIGHWAY 27, LAKE WALES, FLORIDA 33888

DRAWN:	RAG
CHECKED:	SVM
DATE:	DEC. 2008
SCALE:	1" = 20'
JOB No:	08-0606.000
SHEET:	19 OF 25

L2

Reynolds Planning & Design
703 GREENS AVENUE
WINTER PARK, FLORIDA 32789
PHONE: 407-647-1213

LANDSCAPE DETAILS

I:\2_58_LANDSCAPE-DET_130.dwg

I:\schematic\Project08\0806\000_abc_lmq_n\mss\landscapedetails\080606000_abc_lmq_n\landscapedetail_130.dwg, 12/27/2008 4:53:52 PM, Admin PPT 24x36.plt