

LUMINAIRE SCHEDULE								
SYMBOL	LABEL	QTY	CATALOG NUMBER	DESCRIPTION	LAMP	LUMENS	LLF	NOTES
	KVF	6	KVF 400M SR4SCFL	SQUARE AREA LIGHT, SR4SC DISTRIBUTION, FLAT LENS, MEETS 'NIGHTTIME FRIENDLY' CRITERIA	ONE 400-WATT CLEAR ED-28 METAL HALIDE, HORIZONTAL POSITION.	32000	0.91	LIGHT AND POLE TO MATCH EXISTING SITE LIGHTING FINISH. PROVIDE W/ HOUSE SIDE SHIELD. TO MINIMIZE OVERFLOW OF LIGHT AT PROPERTY LINES.
	EXIST KVF	EXIST	KVF 400M	SQUARE AREA LIGHT	ONE 400-WATT METAL HALIDE			

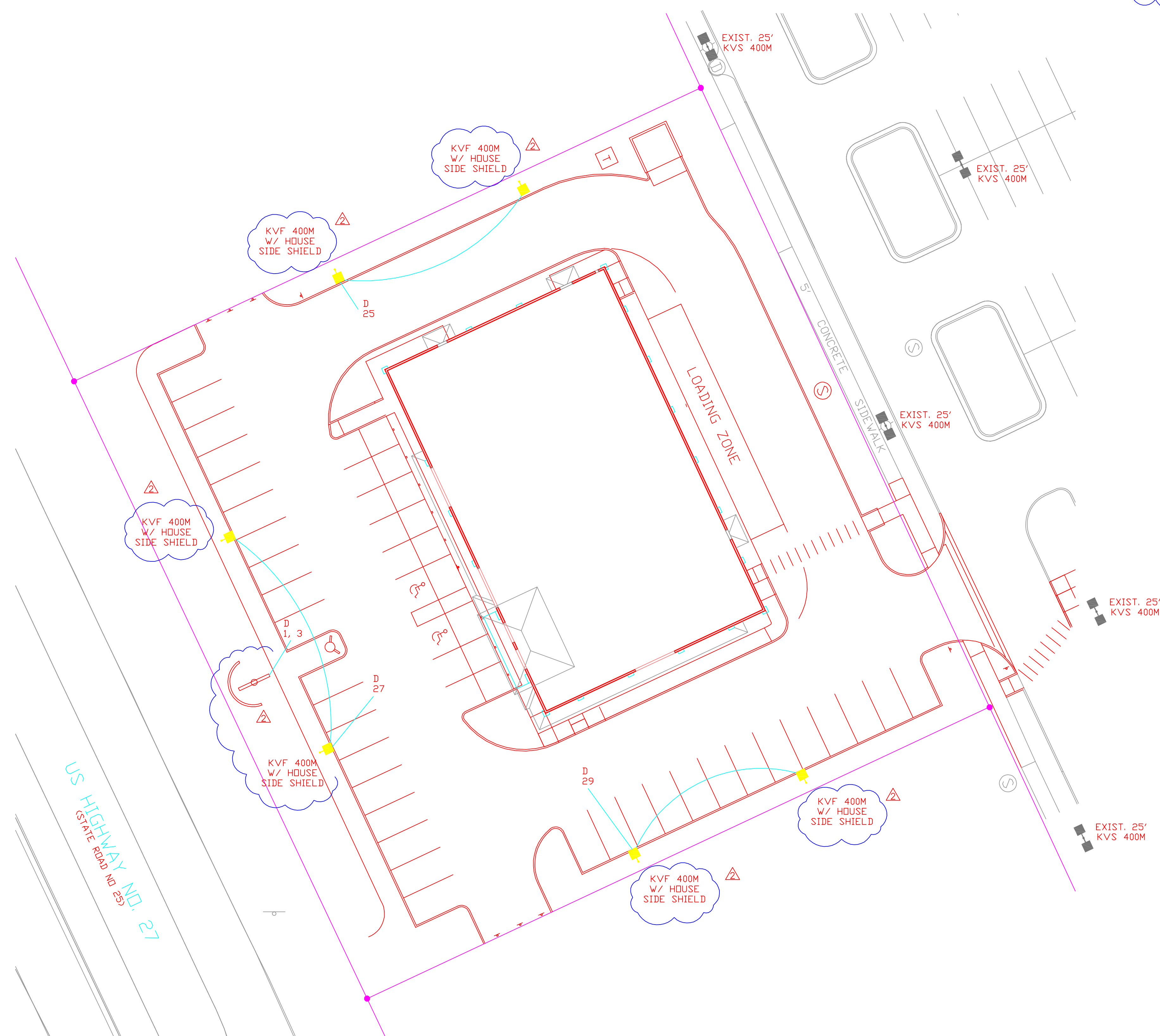

LITHONIA LIGHTING

### Architectural Vertical Cutoff

# KVF

Dimensions are shown in inches (centimeters) unless otherwise noted.

- EPA: 2.8ft<sup>2</sup> (.25m<sup>2</sup>)
- Square: 21-1/2(54.6)
- Height: 17(43.2)
- Max. weight: 53 lbs (24kg)

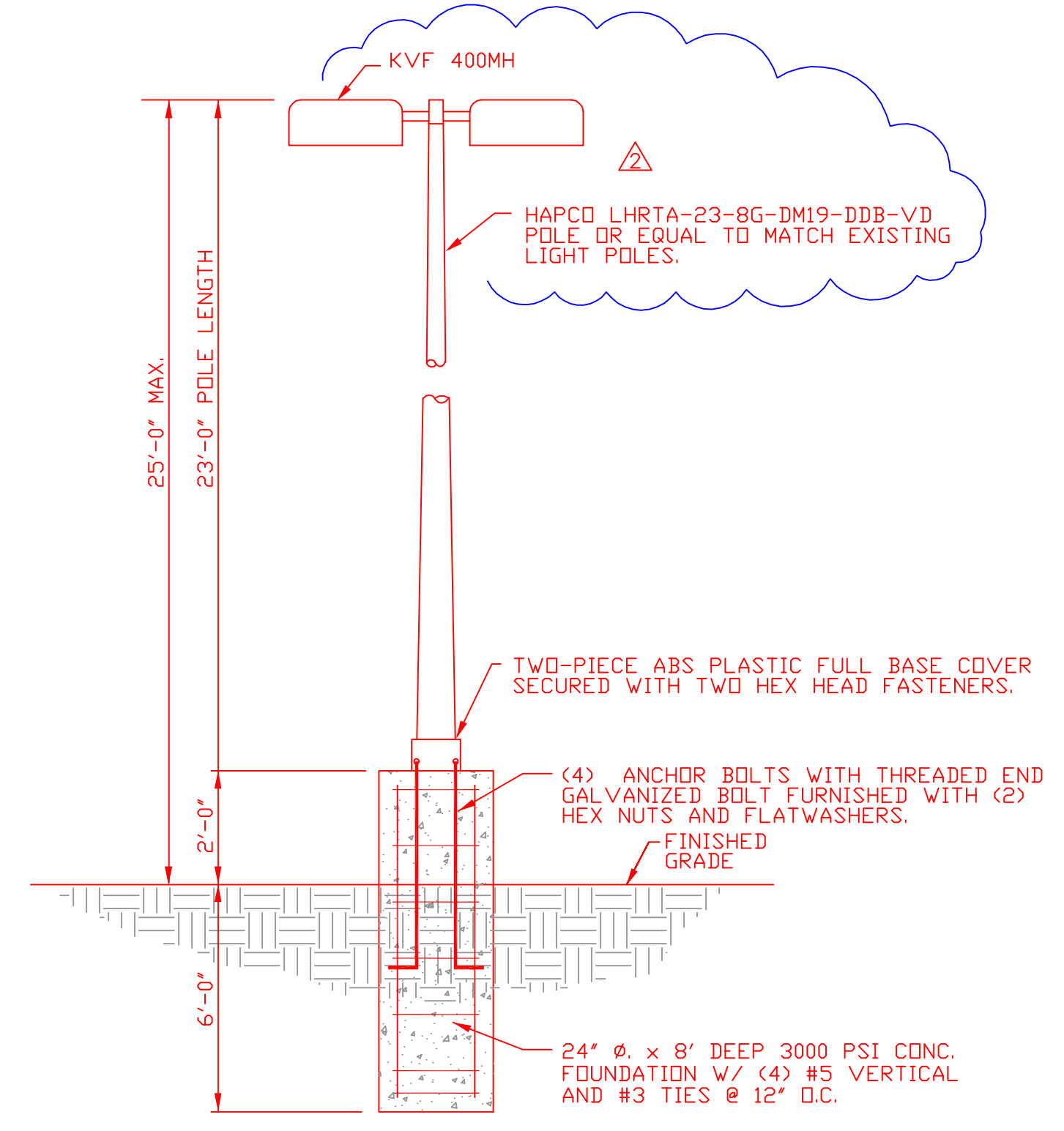

NOTE:  
POLE WITH LIGHT FIXTURE SHALL COMPLY WITH 110 M.P.H. WIND LOAD REQUIREMENT

**PARKING LOT POLE DETAIL** 6 REQUIRED

**SITE LIGHTING PLAN**  
SCALE: 1" = 20'-0"

REVISIONS	BY
	CITY COMMENTS
	CITY COMMENTS

**DRMP**  
ENGINEERS • SURVEYORS • PLANNERS • SCIENTISTS

941 Lake Baldwin Lane - Orlando, Florida 32814  
Phone: 407.896.0594 Fax: 407.896.4836  
Florida Certificate of Authorization No. 2648

Dyer, Riddle, Mills, & Precourt, Inc.

WARNING  
IF THIS BAR DOES NOT MEASURE UP THIS DOCUMENT IS NOT TO SCALE

JOHN C. KELLY, P.E.  
FLORIDA P.E. #44011

**ABC LIQUORS, INC.**  
8888 S. ORANGE AVE. - ORLANDO, FLA. 32824

**ABC FINE WINE & SPIRITS STORE NO. 59**  
U.S. HIGHWAY 27, LAKE WALES, FLORIDA 33888

DRAWN:	M. MAISCO
CHECKED:	S. RIVERA
DATE:	DEC. 2008
SCALE:	1" = 20'
JOB No.	08-0606.000
SHEET:	25 OF 25

SL-1

SITE LIGHTING PLAN

S:\1\_59\_Site\_Lighting.dwg