

LIST OF ABBREVIATIONS

A A/C	AIR CONDITION	E EL	ELEVATION	L LAV	LAVATORY	S SC	SOLID CORE
AB	ANCHOR BOLT	ELEC	ELECTRICAL	LBL	LABEL	SCHED	SCHEDULE
ACT	ADJUSTABLE CEILING TILE	ELEV	ELEVATOR	LBS	POUNDS	SCUPPER	SCUPPER
AD	ADJUSTABLE, ADJACENT	EMER	EMERGENCY	LF	LINEAR FEET	SD	SOAP DISPENSER
AFF	ABOVE REF FINISHED FLOOR (SLAB)	EQ	EQUAL	LT WT	LIGHT WEIGHT	SEAL	SEALANT
AHU	AIR HANDLER UNIT	EQUIP	EQUIPMENT	M MAS	MASONRY	SECT	SECTION
ALT	ALTERNATE	ESC	ESCALATOR	MAX	MAXIMUM	SF	SQUARE FEET
ALUM	ALUMINUM	EWC	ELECTRIC	MECH	MECHANICAL	SHT	SHEET
ANOD	ANODIZED	EXIST	EXISTING	MFR	MANUFACTURER	SIM	SIMILAR
APPROX	APPROXIMATE	EXP	EXPANSION	MH	MANHOLE	SPEC	SPECIFICATION
ARCH	ARCHITECT	EXT	EXTERIOR	MIN	MINIMUM	SS	STAINLESS STEEL
AUTO	AUTOMATIC	FR-S	FIRE-RETARDANT	MIN	MINIMUM	STD	STANDARD
		FR-S	FIRE-RETARDANT WOOD TREATMENT	MISC	MISCELLANEOUS	STL	STEEL
B O	BOTTOM OF BOARD	FACP	FIRE ALARM CONTROL PANEL	MLDG	MOLDING	STOR	STORAGE
BD	BOARD	FD	FLOOR DRAIN	MO	MASONRY OPENING	STRUC	STRUCTURAL
BLDG	BUILDING	FDN	FOUNDATION	MR	MOISTURE RESISTANT	SUSP	SUSPENDED
BM	BEAM	FIN	FINISHED	MTD	MOUNTED	SY	SQUARE YARD
BRG	BEARING	FLR	FLOOR	MTL	METAL	T	TREAD
BTM	BOTTOM	FR	FIRE RESISTANT	MUL	MULLION	T&G	TONGUE & GROOVE
BUR	BUILT UP ROOF	FR-S	FIRE-RETARDANT WOOD TREATMENT	MBSD	METAL BLDG. SHOP DWG.	TBL	TABLE
CB	CATCH BASIN	FT	FEET, FOOT	N NIC	NOT IN CONTRACT	TELE	TELEPHONE
CG	CORNER GUARD	FTG	FOOTING	NOM	NOMINAL	TEMP	TEMPERED
CI	CAST IRON	FURR	FURRING	NTS	NOT TO SCALE	THK	THICK
CJ	CONTROL JOINT	FUT	FUTURE	O OC	ON CENTER	TLT	TOILET
CL	CENTER LINE	GA	GAUGE	OD	OUTSIDE DIAMETER	TPD	TOILET PAPER DISPENSER
CLG	CEILING	GAL	GALLON	OPP	OPPOSITE	TST	TUBE STEEL
CLO	CLOSET	GALV	GALVANIZED	OVFL	OVERFLOW	TV	TELEVISION
CLR	CLEAR	GC	GENERAL CONTRACTOR	P PL	PLATE	TYP	TYPICAL
CMU	CONCRETE MASONRY UNIT	GYP	GYPSUM	PLAM	PLASTIC LAMINATE	U UON	UNLESS OTHERWISE NOTED
CO	CLEAN OUT	H HB	HOSE BIBB	PLAS	PLASTER	UTIL	UTILITY
COL	COLUMN	HC	HOLLOW CORE	PLBG	PLUMBING	V VB	VINYL BASE
CONC	CONCRETE	HDW	HARDWARE	PLWD	PLYWOOD	VCT	VINYL COMPOSITE TILE
CONST	CONSTRUCTION	HM	HOLLOW METAL	PNL	PANEL	VERT	VERTICAL
CONT	CONTINUOUS	HORIZ	HORIZONTAL	PR	PREFABRICATED	VEST	VESTIBULE
CONTR	CONTRACTOR	HR	HOUR	PT	POINT	VIF	VERIFY IN FIELD
CORR	CORRIDOR	HT	HEIGHT	PT	PRESSURE TREATED	VTR	VERIFY THRU ROOF
CT	CERAMIC TILE	HTG	HEATING	PTD	PAPER TOWEL DISPENSER	VVC	VINYL WALL COVERING
CTR	CENTER	HVAC	HEATING, VENTILATING & AIR CONDITIONING	PVC	POLY VINYL CHLORIDE	VMSD	VERIFY W/ METAL BLDG SHOP DWGS
CJ	CONDENSING UNIT	HW	HOT WATER	Q QT	QUARRY TILE	W	WIDTH
CW	COLD WATER	ID	INSIDE DIAMETER	R R	RADIUS, RISER, THERMAL RESISTANCE	W/	WITH
D DBL	DOUBLE DEPARTMENT	IN	INCH	RD	ROOF DRAIN	W/O	WITHOUT
DEPT	DEPARTMENT	INCL	INCLUDING	RECP	RECEPTACLE	WC	WATER CLOSET
DET	DETAIL	INSUL	INSULATION	REF	REFERENCE	WD	WOOD
DF	DRINKING FOUNTAIN	INT	INTERIOR	REFR	REFRIGERATOR	WH	WATER HEATER
DIA	DIAMETER	INV	INVERT	REG	REGLET	WP	WATERPROOF
DM	DIMENSION	J JAN	JANITOR	REIN	REINFORCEMENT	WT	WEIGHT
DISP	DISPENSER	JB	JUNCTION BOX	REQ	REQUIRED	WWF	WELDED WIRE FABRIC
DN	DOWN	JT	JOINT	REV	REVISION	WMM	WELDED WIRE METAL
DS	DOWNSPOUT	L L	LENGTH	RND	ROUND	Y	YARD
DWG	DRAWING	LAM	LAMINATE	RO	ROUGH OPENING	YD	YARD
E EA	EACH			RTU	ROOF TOP UNIT		
EB	EXPANSION BOLT						
EIFS	EXTERIOR INSULATING FINISH SYSTEM						
EJ	EXPANSION JOINT						

VECNINITY MAP

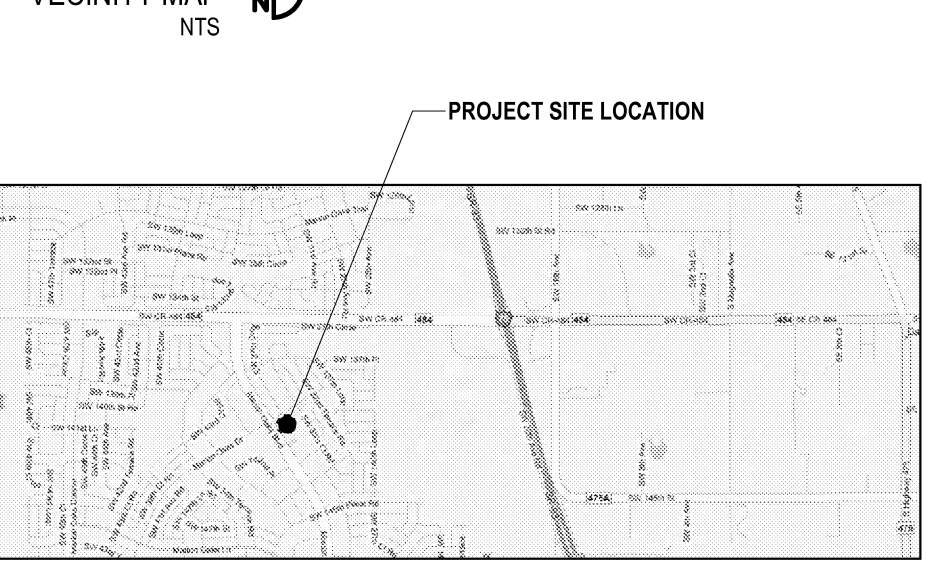

PROJECT NAME
FAMILY DOLLAR STORE
MARION OAKS BLVD

BELLEVIEW, MARION COUNTY, FLORIDA

PROJECT STRUCTURAL DESIGN NOTES

THE PLANS INDICATE THOSE PARTS OF THE ENCLOSED BUILDING STRUCTURE THAT ARE TO BE MANUFACTURED AND DESIGNED BY A SEPARATE METAL BUILDING MANUFACTURER. SEPARATE SHOP DRAWINGS PREPARED BY THE METAL BUILDING MANUFACTURER'S STRUCTURAL ENGINEER AND ARE TO BE UTILIZED ALONG WITH THESE PLANS TO FORM A COMPLETE DESIGN PACKAGE. THE CONTRACTOR IS TO CAREFULLY EXAMINE THE BUILDING STRUCTURE PLANS AND VERIFY THE SCOPE OF WORK TO BE PERFORMED BY THE METAL BUILDING MANUFACTURER AND PROVIDE COMPLETE COORDINATION PROVIDING SEAMLESS INTEGRATION OF ALL ITEMS AS REQUIRED FOR A COMPLETE FACILITY.

LEGAL DESCRIPTION

LOTS 1 & 2, BLOCK '254', 'MARION OAKS UNIT ONE' AS PER PLAT THEREOF, RECORDED IN PLAT BOOK '0', PAGES 1 THROUGH 18 OF THE PUBLIC RECORDS OF MARION COUNTY, FL.

CLOSED SPECS PROVIDERS

ENERGY MANAGEMENT SYSTEM:
VENTSAR (818) 341-8760
EXT. 205 ERIK DE LAS CASAS

HVAC UNITS:
CARRIER (877) 501-4482 TERRIE TRULL
TERRIE.TRULL@CARRIERUTC.COM

EXTERIOR MOTION SENSOR SYSTEM:
E.D.J. (ELECTRICAL DISTRIBUTORS, INC.)
(704) 372-3040 CHRIS STUDNEY

SALES FLOOR DOOR:
ARM-A-DOR (407) 828-3655

SECURITY DOOR HARDWARE:
ARM-A-DOR (407) 472-2741
MILLS AND NEBRASKA

FLOOR PRODUCT FIXTURES:
LOZIER BY FDS

CHECK OUT FIXTURES:
LYONS BY FDS

BOWER POLE CONNECTIONS:
D & P CUSTOM LIGHTS (800)251-2200 OR (615) 350-7800

INTERIOR LIGHTS:
LITHONIA, THRU E.D.J. (ELECTRICAL DISTRIBUTORS, INC.)
(704) 372-3040 CHRIS STUDNEY

VINYL COMP. TILE IN RESTROOMS
(800) 233-8222 ARMSTRONGS (SEE SCHED. FOR ALTS)

TOILET FIXTURES AND RESTROOM SINK FAUCETS:
AMERICAN STANDARD (800) 442-1902

CONCRETE POLISHED FLOORS:
QUESTMARK FLOORING (404) 915-8663 GEORGE PAXINOS
PERFECT POLISH (865) 494-7257 DAVE COOKE
TITUS RESTORATION SERVICES, INC. (678) 494-6893 PHIL EVANS

CODE INFORMATION

JURISDICTION AUTHORITY
MARION COUNTY
BUILDING DIVISION
2710 EAST SILVER SPRINGS BLVD
OCALA, FL 34470
PHONES: (352)438-2400
FAX: (352) 438-2401

ADOPTED CODES

BUILDING: FLORIDA BUILDING CODE, BUILDING - 2007 W/ 2009 AMENDMENT
FLORIDA FIRE PREVENTION CODE - 2007
CHAPTER 38 - (NFPA 101 W/ STATE FIRE MARSHAL AMENDMENTS)

PLUMBING: FLORIDA BUILDING CODE, PLUMBING - 2007 W/ 2009 AMENDMENT
MECHANICAL: FLORIDA BUILDING CODE, MECHANICAL - 2007 W/ 2009 AMENDMENT
ELECTRICAL: FLORIDA BUILDING CODE, ELECTRICAL - 2007 W/ 2009 AMENDMENT
CHAPTER 27 - (NFPA 70, NATIONAL ELECTRIC CODE) 2005 EDITION

FUEL/GAS: FLORIDA BUILDING CODE, FUEL/GAS - 2007
ACCESSIBILITY: FLORIDA BUILDING CODE, BUILDING - 2007
CHAPTER 11 - (FLORIDA ACCESSIBILITY CODE FOR BUILDING CONSTRUCTION)

ENERGY: FLORIDA BUILDING CODE, BUILDING - 2007
CHAPTER 13 - (FLORIDA ENERGY EFFICIENCY FOR BUILDING CONSTRUCTION)

NEW BUILDING AND CONSTRUCTION DATA

OCCUPANCY CLASSIFICATION: GROUP M - MERCANTILE
CONSTRUCTION TYPE (FBC TABLE 600): TYPE IIB, NON-SPRINKLERED
MAX HEIGHT AND AREA ALLOWABLE (FBC TABLE 500): HEIGHT - 55'-0" TOTAL AREA - 12,500 SQ FT
ACTUAL HEIGHT AND AREA: HEIGHT - 20'-6" TOTAL AREA - 8,174 SQ FT

EXTERIOR AREA UNDER CANOPY: 211 SQ FT
EXTERIOR AREA UNDER CANOPY & MAIN AREA: 8,385 SQ FT

DRAWING INDEX

SHEET #	TITLE	PERMIT SUBMISSION DATE	
		MAY 24th 2010	
GENERAL			
CS	COVER SHEET	X	
ARCHITECTURAL			
A101	ARCHITECTURAL FLOOR PLAN	X	
A102	FINISH, FIXTURE & LIFE SAFETY FLOOR PLAN	X	
A103	FLOOR SPECS, DOOR & STOREFRONT DETAILS	X	
A201	EXTERIOR ELEVATIONS	X	
A301	BUILDING SECTIONS	X	
A302	WALL SECTIONS & WALL TYPES	X	
STRUCTURAL			
S101	FOUNDATION PLAN	X	
S102	STRUCTURAL NOTES	X	
S103	STRUCTURAL DETAILS	X	
S104	STRUCTURAL DETAILS	X	
MECHANICAL / PLUMBING			
M101	MECHANICAL / PLUMBING FLOOR PLAN AND NOTES	X	
M102	MECHANICAL / PLUMBING DETAILS		
ELECTRICAL			
E101	ELECTRICAL LIGHTING AND POWER PLAN	X	
E102	ELECTRICAL SCHEDULE AND DETAILS	X	
V1	VENSTAR SYSTEM PLAN AND DETAILS	X	

LIS EXPRESSLY RESERVES ITS COPYRIGHT AND ALL OTHER PROPERTY RIGHTS TO THESE DOCUMENTS AND THEIR DESIGN, HENCE, THEY ARE NOT TO BE REPRODUCED.

ARCHITECT

LIS ARCHITECTURE
ENGINEERING
LAND SURVEYING
AA 26002040 CA NO.: 6853 LB1057

2572 West State Road 426 Suite 2064, Oviedo, FL 32765
Phone: (321) 244-0402 facsimile: (321) 244-9419

21430 Palm Beach Blvd. Alva, Fla. 33920
Phone: (239) 693-9244 facsimile: (239) 693-9828

DRAWING SYMBOLS

Grid Designation: X

Room Number: 102

Door Number: 4

Window Type: [Symbol]

Storefront Type: 102A

Wall Type: 3

Key Note: 5

Revision Number: [Symbol]

Elevations Tags: [Symbol]

Spot Elevation Tag: [Symbol]

North Arrow: [Symbol]

Brick, Concrete, Plywood, Gypsum Board, Drainage Fill, Masonry, Compacted Earth, Steel, Rigid Insulation, MR Board

PREFERRED PROVIDERS

METAL BUILDING
VP METAL BUILDING (901) 748-61-05
DAVID ENGLISH

STOREFRONT WALL SYSTEM: KAWNEER OR VISTAWALL
(877)787-9107 OR (800) 859-4567

EXTERIOR BUILDING LIGHTS:
LITHONIA, THRU E.D.J. (ELECTRICAL DISTRIBUTORS, INC.)
(704) 372-3040 CHRIS STUDNEY

SITE LIGHTS:
LUMINAIRE (305) 437-7975

TOILET ACCESSORIES:
BRADLEY ACCESSORIES (800) 272-3539

LOCKS:
SCHLAGE (800)847-1864

ROLL DOWN GATES (IF REQ. BY FDS)
METRO DOOR (800) 559-3661 EXT.640

CONTACT INFORMATION

CLIENT:
CHRIS STEPHENS
1231 N. ORANGE AVE
SUITE B
(407) 6286-2610 PHONE

MECHANICAL / ELECTRICAL ENGINEER:
LIS ENGINEERING
2572 W STATE ROAD 426
SUITE 2064
OVIEDO, FL 32765
(321) 244-0402 PHONE
(321) 244-9419 FAX
CONTACT: ROBERT CASE

ARCHITECT:
LIS ENGINEERING
2572 W STATE ROAD 426
SUITE 2064
OVIEDO, FL 32765
(321) 244-0402 PHONE
(321) 244-9419 FAX
CONTACT: CARLOS SOBRIN

CIVIL ENGINEER:
1231 N. ORANGE AVE.
SUITE B
ORLANDO, FL 32804
(407) 286-2610

STRUCTURAL ENGINEER:
LIS ENGINEERING
2572 W STATE ROAD 426
SUITE 2064
OVIEDO, FL 32765
(321) 244-0402 PHONE
(321) 244-9419 FAX
CONTACT: ROBERT CASE

SIGNAGE SUPPLIER:
ALLEN INDUSTRIES, INC.
6434 BURNT POPLAR ROAD
GREENSBORO, NC 27409
(877) 994-2791 PHONE
(410) 643-754 FAX
CONTACT: BETSY SWAN

METAL BUILDING DESIGNER:
VP BUILDING SYSTEMS
3200 PLAYERS CLUB CIRCLE
MEMPHIS, TN 38125
(901) 748-5107 PHONE
(901) 748-9200 FAX
CONTACT: JONATHAN COWLES

GENERAL NOTES

- ALL WORK WILL COMPLY WITH LOCAL, STATE, AND NATIONAL CODES RELATED TO THIS PROJECT.
- THE WRITTEN DIMENSIONS PREVAIL ON THE CONSTRUCTION DOCUMENTS. DO NOT SCALE THESE DRAWINGS. CONTRACTOR TO VERIFY ALL DIMENSIONS AND CONDITIONS IN THE FIELD. IF ANY DISCREPANCY OCCURS, THE CONTRACTOR IS REQUIRED TO NOTIFY THE ARCHITECT IN WRITING BEFORE PROCEEDING WITH ANY WORK AFFECTED BY THE DISCREPANCY.
- CONTRACTORS TO SECURE ALL PERMITS AND REQUIRED INSPECTIONS NECESSARY TO OBTAIN A CERTIFICATE OF OCCUPANCY.
- CONTRACTORS ARE TO PROVIDE ALL TEMPORARY UTILITIES AND INFRASTRUCTURE REQUIRED TO PERFORM THE WORK, INCLUDING FIRE PROTECTION AS REQUIRED DURING CONSTRUCTION.
- EACH CONTRACTOR AND SUBCONTRACTOR IS EXPECTED TO REVIEW ALL CONTRACT DOCUMENTS AND SITE CONDITIONS PRIOR TO ISSUED BID. CHANGE ORDERS WILL NOT BE APPROVED FOR FAILURE TO DO SO.
- PRODUCTS SPECIFIED OR OTHERWISE INDICATED IN THE CONTRACT DOCUMENTS SHALL NOT BE SUBSTITUTED WITHOUT PRIOR WRITTEN APPROVAL FROM THE ARCHITECT.
- THIS CONTRACTOR SHALL COORDINATE ALL TRADES REQUIRED TO COMPLETE THIS PROJECT AS REQUIRED TO ACTIVATE THE USE OF THE FACILITY AS PLANNED.
- THE CONTRACTOR SHALL HAVE INSTALLATION INSTRUCTIONS FOR ALL EQUIPMENT AND APPLIANCES ON SITE AT TIME OF INSPECTION.
- ALL PENETRATIONS THAT OCCUR WHERE FIRE RATINGS ARE REQUIRED SHALL BE APPROPRIATELY SEALED WITH FIRE STOP SEALANT TO MAINTAIN THE INTEGRITY OF THE WALL TO THE COMPLETE REQUIREMENTS OF THE UNDERWRITER'S LABORATORY OR GYPSUM ASSOCIATION ASSEMBLY IDENTIFIED.
- ALL STEEL PENETRATIONS THAT OCCUR WHERE FIRE RATINGS ARE REQUIRED SHALL BE APPROPRIATELY SEALED WITH FIRE STOP SEALANT TO MAINTAIN THE INTEGRITY OF THE WALL TO THE COMPLETE REQUIREMENTS OF THE UNDERWRITER'S LABORATORY OR GYPSUM ASSOCIATION ASSEMBLY IDENTIFIED.
- WHERE WALLS ARE INDICATED TO BE EXTENDED FROM FLOOR TO ROOF DECK WHERE FIRE RATINGS ARE REQUIRED SHALL BE APPROPRIATELY SEALED WITH FIRE STOP SEALANT TO MAINTAIN THE INTEGRITY OF THE WALL TO THE COMPLETE REQUIREMENTS OF THE UNDERWRITER'S LABORATORY OR GYPSUM ASSOCIATION ASSEMBLY IDENTIFIED.
- ALL DIMENSIONS ARE TO FACE OR CENTERLINE IF STUD. FACE OF MASONRY AND CENTERLINE OF COLUMNS UNLESS OTHERWISE NOTED.

ROLAND ABOUCHACRA
AR 83723