

DRAINAGE STRUCTURES (INLET LOCATION X,Y)

- (S1) FOOT TYPE D DBI GRATE EL.- 83.50 INVERT EL.- 80.50 PIPE SIZE - 24" RCP (W) FDOT STANDARD INDEX 232 W/ STEEL GRATE (56891,485346)
- (S2) FOOT TYPE D DBI GRATE EL.- 81.65 INVERT EL.- 76.86 (E & W) FDOT STANDARD INDEX 232 W/ STEEL GRATE (525715,4890334)
- (S3) FOOT TYPE D DBI GRATE EL.- 78.50 INVERT EL.- 75.50 FDOT STANDARD INDEX 232 W/ STEEL GRATE (525715,4890334)

- (S4) FOOT TYPE D DBI GRATE EL.- 79.00 INVERT EL.- 74.00 PIPE SIZE - 24" RCP (W & E) FDOT STANDARD INDEX 232 W/ STEEL GRATE (522180,474202)

- (S5) DRY RETENTION POND OUTFALL BROADCASTED WEIR W/SKIMMER INVERT EL.- 77.50 SKIMMER BOTTOM - 76.50

- (S6) STORM SEWER MANHOLE MANHOLE TOP EL.- 64.00 PIPE SIZE - 24" RCP (W & S) (530592,46263)

- (S7) 30" MES (14) INVERT EL.- 73.25

POND OUTFALL STRUCTURE DETAIL SECTION A-A

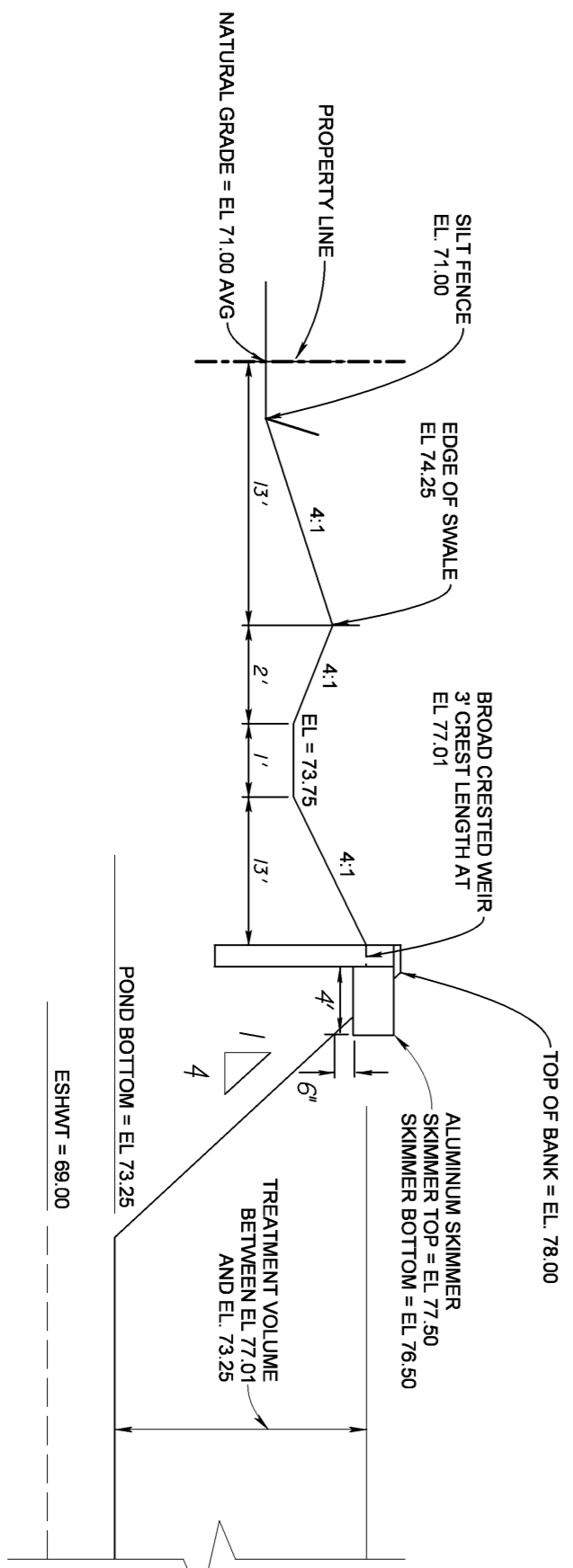

THE EXISTING ARCHWAY BRICK AND METAL FENCE WILL MODIFIED TO ACCOMMODATE THE REVISED CURB CUT DRIVEWAY

DRY RETENTION POND DETAIL SECTION B-B

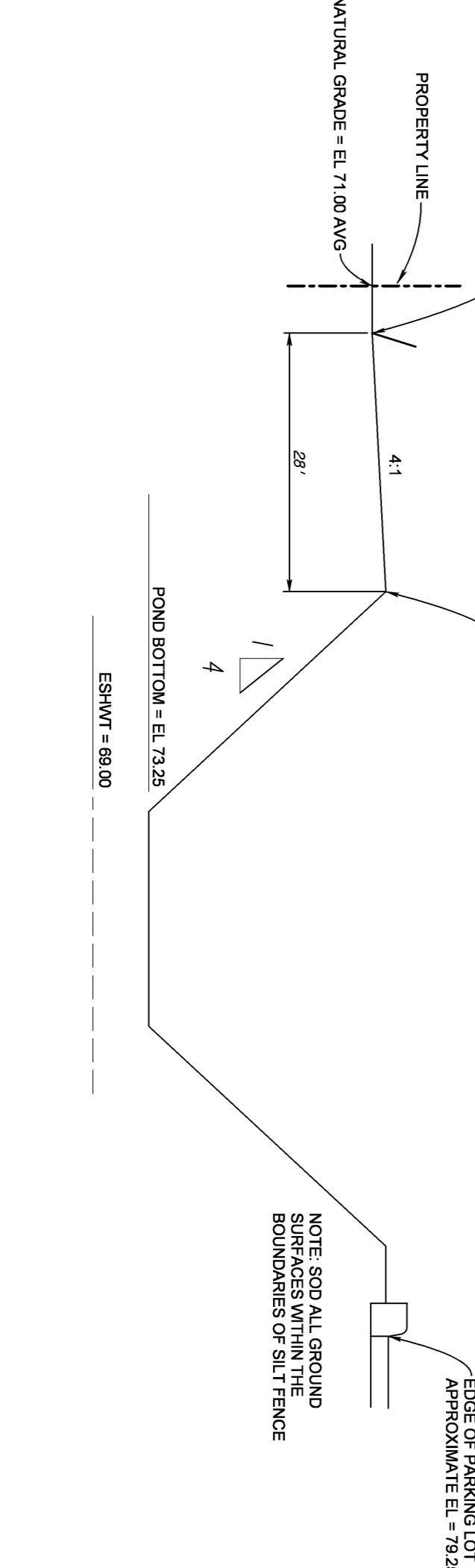

NOTE: SPALL GROUND SURFACES WITHIN THE BOUNDARIES OF SILT FENCE