

1 SITE LIGHTING PHOTOMETRIC PLAN

SeqNo	Label	Z	Orient
1	EX2	30	0
2	EX2	30	0
3	EX	15	0
4	L	30	270
5	EX	15	0
6	L	30	180
7	EX	15	0
8	L	30	0
9	L	30	180
10	EX	15	0
11	L	30	90

Statistical Area Summary					
Label	Avg	Max	Min	Avg/Min	Max/Min
Dunkin Donuts General Parking	5.08	7.3	3.0	1.69	2.43

Luminaire Schedule						
Symbol	Qty	Label	Arrangement	Lumens	LLF	Description
☉	4	EX	SINGLE	18000	0.810	EXISTING FIXTURE TO REMAIN - SHOWN FOR REFERENCE ONLY
☉☉	2	EX2	BACK-BACK	110000	0.750	EXISTING FIXTURE TO BE RELOCATED
☉	5	L	SINGLE	110000	0.750	Visionaire #ODN-3 T3-1000MH-VLFG - Pole #RTSP27

**General Notes**  
 A. Perimeter, type III, fixture optics are to be directed into the site.

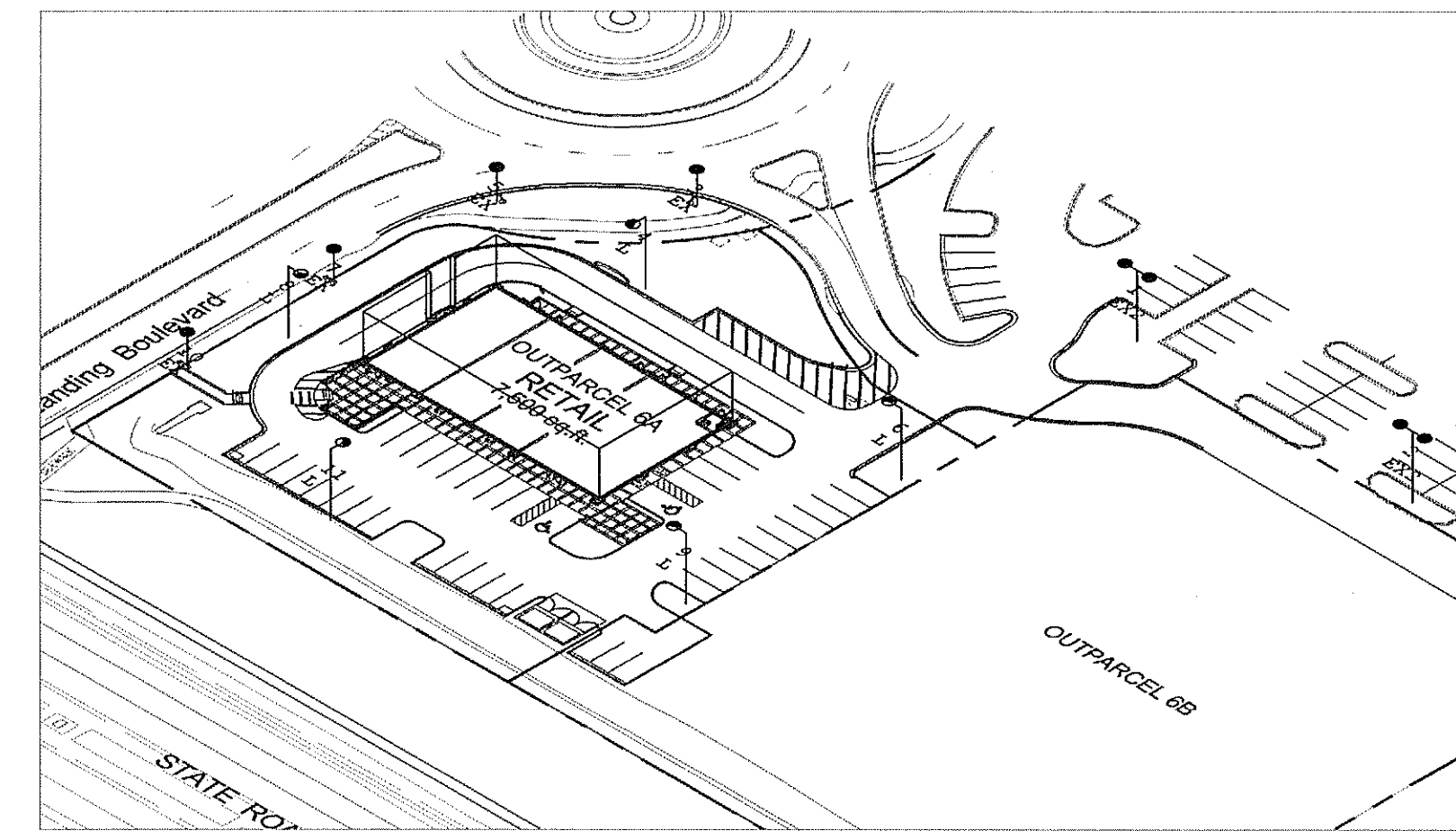
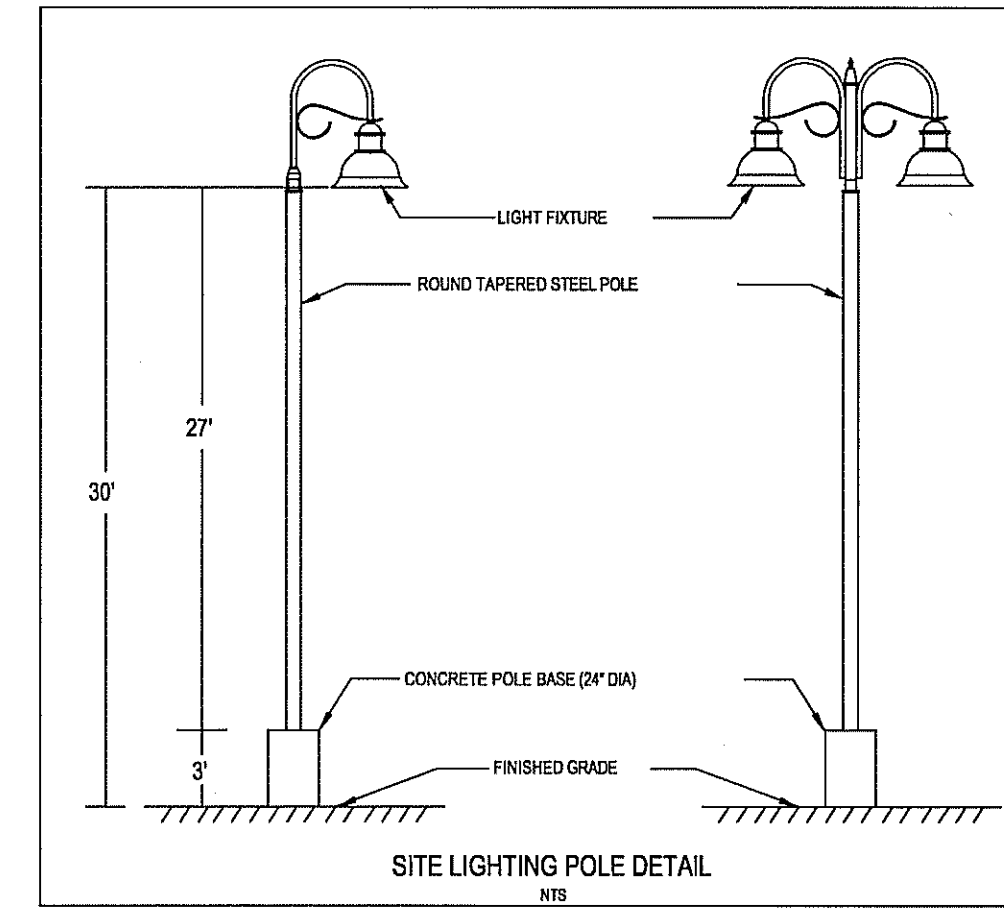

ISOMETRIC VIEW

For Additional Lighting Information and Pricing Contact:  
**On-Site Lighting & Survey, LLC**  
 PH: 763-684-1548

Project No. 7080913

SITE LIGHTING SCOPE NOTES			
Fixture Manufacturer:	Visionaire	Fixture Side Skirts:	None
Lamp Type:	Metal Halide	Pole Material:	Steel
Lamp Wattage:	1000W	Mounting Height:	27' Pole + 3' Base
Lamp Orientation:	Vertical	Concrete Base:	3' High & 24" Dia.
Fixture Type:	Decorative	Pole & Fixture Color:	Bronze

Based on the information provided, all dimensions and luminaire locations shown represent recommended positions. The engineer and/or architect must determine applicability of the layout to existing or future field conditions.  
 This lighting pattern represents illustration levels calculated from laboratory data taken under controlled conditions utilizing current industry standard lamp ratings in accordance with Illuminating Engineering Society approved methods. Actual performance of any manufacturer's luminaire may vary due to variation in electrical voltage, tolerance in lampS And other variable field conditions.

**Cuhaci & Peterson**  
 Architects Engineers Planners  
 Florida Corporate Certificate #AA C000526  
 9922 Project Avenue, Orlando, FL 32814  
 Phone: 407.681.1910 - Fax: 407.681.1911  
 www.c&p.com

**Weingarten Realty Investors, Inc.**  
 CLIENT NAME  
 2720 E. Colonial Drive  
 Orlando, FL 32803

**Outparcel 5 @ Palm Coast Landing**  
 PROJECT NAME  
 N.E.C. SR 100 and Belle Terre Parkway  
 Palm Coast, Florida

**Electrical - Site Lighting Photometric Plan**  
 SHEET TITLE

EUGENIO E. DE ALBA  
 FILE #64611

RELEASE

PROJECT NO.	208050
DATE	08/20/08
DRAWN	LF
CHECKED	EDA

**E001**