

Luminaire Location Summary			
SeqNo	Label	Z	Orient
1	EX2	30	0
2	EX2	30	0
3	EX	15	0
4	L	30	270
5	EX	15	0
6	L	30	180
7	EX	15	0
8	L	30	0
9	L	30	180
10	EX	15	0
11	L	30	90

Statistical Area Summary					
Label	Avg	Max	Min	Avg/Min	Max/Min
Dunkin Donuts General Parking	5.08	7.3	3.0	1.69	2.43

Luminaire Schedule						
Symbol	Qty	Label	Arrangement	Lumens	LLF	Description
	4	EX	SINGLE	16000	0.810	EXISTING FIXTURE TO REMAIN - SHOWN FOR REFERENCE ONLY
	2	EX2	BACK-BACK	110000	0.750	EXISTING FIXTURE TO BE RELOCATED
	5	L	SINGLE	110000	0.750	Visionaire #ODN-3 T3-1000MH-VLFG - Pole #RTSP27

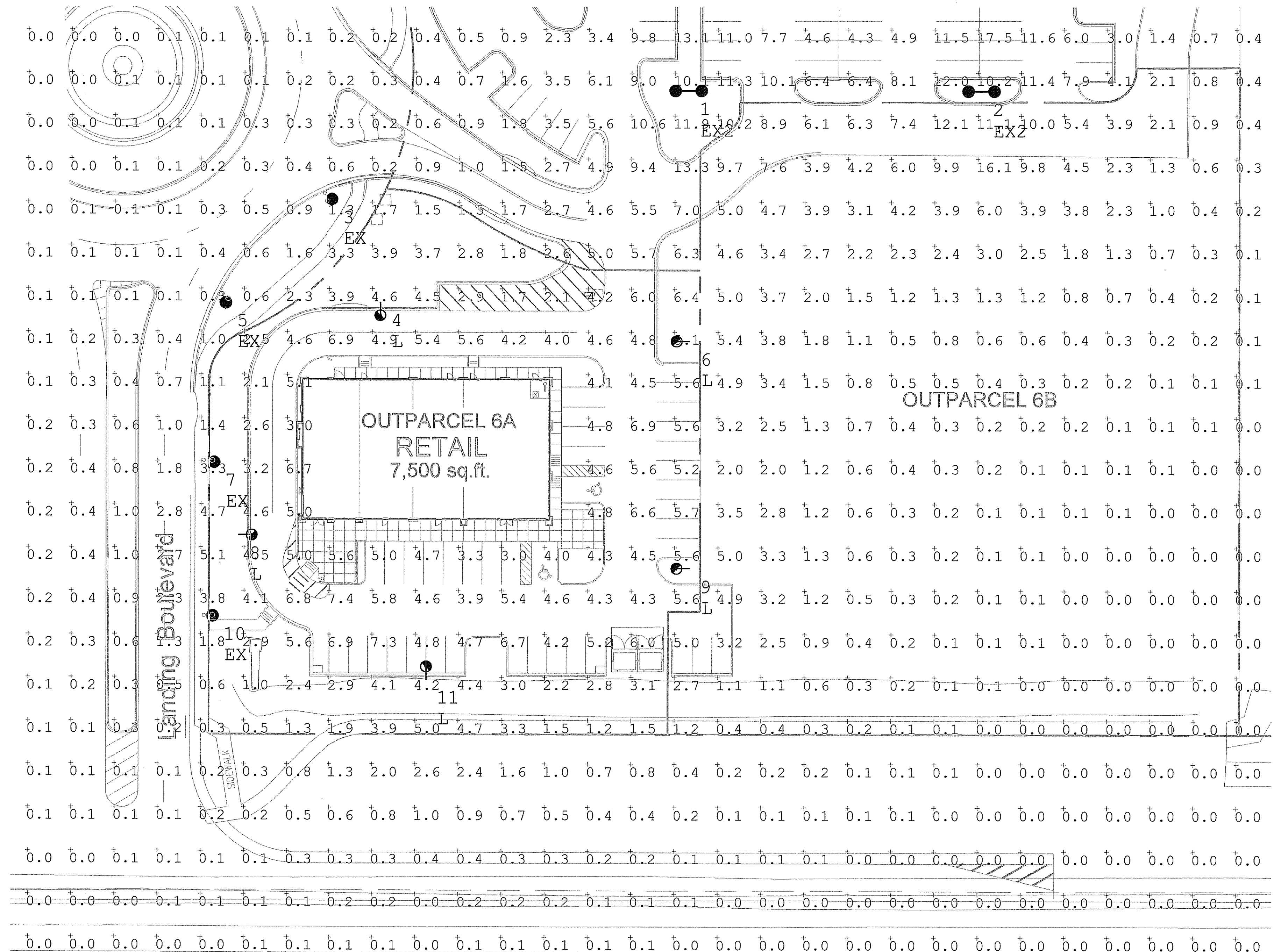

1 SITE LIGHTING PHOTOMETRIC PLAN
SCALE: 1" = 30'

General Notes
A. Perimeter, type III, fixture optics are to be directed into the site.

For Additional Lighting Information and Pricing Contact:
On-Site Lighting & Survey, LLC
PH: 763-684-1548

Project No. 7080813

SITE LIGHTING SCOPE NOTES			
Fixture Manufacturer:	Visionaire	Fixture Side Skirts:	None
Lamp Type:	Metal Halide	Pole Material:	Steel
Lamp Wattage:	1000W	Mounting Height:	27' Pole + 3' Base
Lamp Orientation:	Vertical	Concrete Base:	3' High & 24" Dia.
Fixture Type:	Decorative	Pole & Fixture Color:	Bronze

Based on the information provided, all dimensions and luminaire locations shown represent recommended positions. The engineer and/or architect must determine applicability of the layout to existing or future field conditions.
This lighting pattern represents illumination levels calculated from laboratory data taken under controlled conditions utilizing current industry standard lamp ratings in accordance with Illuminating Engineering Society approved methods. Actual performance of any manufacturer's luminaire may vary due to variation in electrical voltage, tolerance in lamp, and other variable field conditions.

Revision:	Date:
A	9/18/2008
B	9/14/2009

PHOTOMETRIC PLAN

Project: **DUNKIN DONUTS PALM COAST TOWNE CENTER FLORIDA**
Project #: **7080813**

Contract #:

Issue Date: **8/13/2008**

Scale: **AS NOTED**

Drawn/Checked: **SAS/SAZ**

Sheet #: **SL1** Rev. #: **B**