

CONTRACTOR(S) SHALL VERIFY EXISTING CONDITIONS AND CORRELATE DIMENSIONS PRIOR TO PROVIDING THE WORK DETAILED IN THESE DRAWINGS. AND SHALL PROMPTLY NOTIFY THE ARCHITECT OF ANY DISCREPANCIES.  
 © COPYRIGHT SBLM ARCHITECTS PC. UNAUTHORIZED REPRODUCTION OR OTHER USE OF THIS DRAWING IS PROHIBITED.

**STORE FIXTURE PLAN NOTES, GENERAL:**

1. STORE FIXTURES, FURNISHINGS AND EQUIPMENT SHALL BE INSTALLED AND LOCATED IN ACCORDANCE WITH A STORE FIXTURE LAYOUT PLAN PROVIDED TO THE CONTRACTOR BY A PETCO REPRESENTATIVE AT THE TIME OF STORE FIXTURES. FURNISHINGS AND EQUIPMENT DELIVERIES TO THE JOBSITE. FINAL LOCATIONS MAY VARY FROM AS SHOWN ON THIS FLOOR PLAN.
2. REFER TO PROJECT MANUAL SECTION 10300 FOR PETCO STORE FIXTURE/ FURNISHINGS/ EQUIPMENT KEYCODES.
3. FIRE EXTINGUISHERS (10300) SHALL BE PROVIDED AS SPEC'D AND IN ACCORDANCE WITH APPLICABLE CODES. FIRE EXTINGUISHERS SHOWN (TOTAL 8) BASED ON 1 PER 2,000 S.F.
4. SYMBOL KEY:  
 ☉ 3A-40B: C FIRE EXTINGUISHER W/ WALL BRACKET & SIGN (10300)

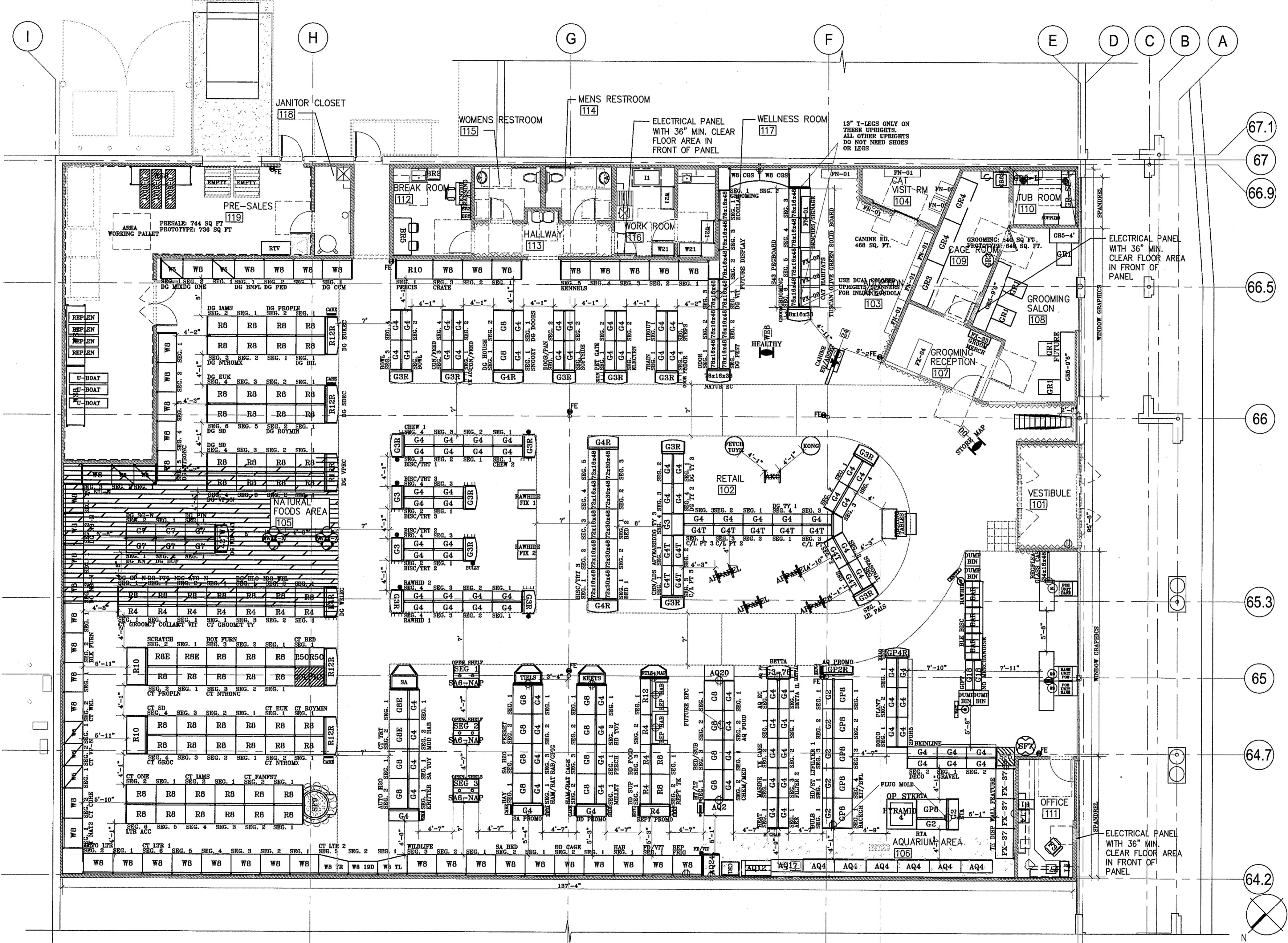

STORE FIXTURE PLAN RECORD		
SFP DESIGN	SFP TO BRICSNET	VERSION
BY: DEANNE TINEO	DATE POSTED: 01-07-10	-
REV. BY:	DATE POSTED:	-
REV. BY:	DATE POSTED:	-
REV. BY:	DATE POSTED:	-
REV. BY:	DATE POSTED:	-
REV. BY:	DATE POSTED:	-
REV. BY:	DATE POSTED:	-

**STORE FIXTURE PLAN**  
 REF.: A2.3 SOURCE: 01  
 1/8" = 1'-0"

DISTRIBUTION:	DATE:
25% SUBMISSION	01-15-10
75% SUBMISSION	01-29-10
98% SUBMISSION	02-25-10
ISSUED FOR CONSTRUCTION	02-26-10

SBLM JOB#	PETCO P.M. JOB#
09147	09277
DRAWN:	CHECKED:
FR	DF

DRAWING TITLE:  
**STORE FIXTURE PLAN**  
**A2.3**

**PETCO ANIMAL SUPPLIES STORES, INC.**  
 PETCO "CARY, NC"  
 213 CROSSROADS BOULEVARD  
 CARY, NC 27518



**SBLM Architects**  
 151 West 26th Street  
 New York, New York 10001  
 Telephone 212 995 5600  
 Fax 212 675 4228  
 www.sblm.com