

REVISION	COMMENTS

**UNIVERSITY OF SOUTH FLORIDA
 SOUTH EAST CHILLER PLANT
 BR-590 COMPONENT #6**

12225 USF MAPLE DRIVE
 TAMPA, FLORIDA 33620

DRAWING TITLE :
**MECHANICAL CHILLER
 PLANT LAYOUT - OVERALL**

FILE NAME: 081106_M-4-53MG
 DATE: 03-31-2009
 PLOT SIZE: AS NOTED
 CADD: BR: SM
 DESIGNED BY: TSH
 CHECKED BY: TSH

PROJECT NO.
 0811106

SHEET NO.
 M-4

Drawing Progress: 100% CONSTRUCTION DOCUMENTS

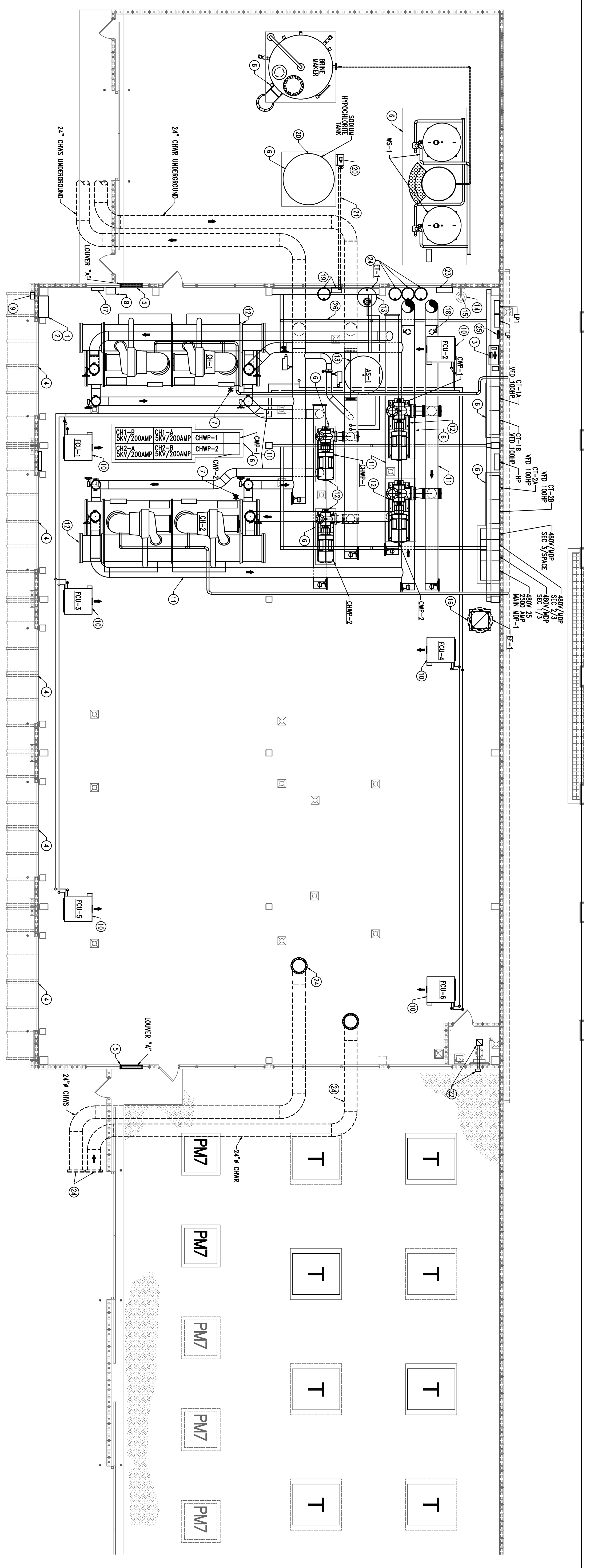

MECHANICAL CHILLER PLANT LAYOUT - OVERALL

SCALE: 1/8"=1'-0"

- MECHANICAL NOTES:**
1. CONTROL CONTRACTOR TO PROVIDE NEW 42"Wx27"H CONTROL CABINET. CONTROL CABINET SHALL BE MOUNTED FROM THE FLOOR. ALL CONTROL BOARDS SHALL BE MOUNTED INSIDE THE CONTROL CABINET.
 2. CONTROL CONTRACTOR TO PROVIDE CONTROL COMPONENTS AND PUMP COMPONENTS. SEE ONE-LINE DIAGRAM DRAWINGS.
 3. CONSTRUCTION MANAGER TO PROVIDE NEW DESK TO PLACE THE CONTROL COMPUTER AND MONITOR.
 4. CONSTRUCTION MANAGER TO PROVIDE NEW ROLL UP DOORS. OPERATOR SHALL BE CHAIN WHEEL AND CHAIN.
 5. MECHANICAL CONTRACTOR TO PROVIDE NEW 42" X 42" WALL MOUNTED HANGAR LOUVER FOR REFRIGERANT REMOVAL. BOTTOM OF LOUVER SHALL BE INSTALLED 12" A.F.F. LOUVER SHALL HAVE A COUNTER WEIGHT, COUNTER BALANCE AND BACK DRAFT DAMPER.
 6. CONSTRUCTION MANAGER TO PROVIDE 6" HOUSEKEEPING PAD UNDER ALL PUMPS AND ALL ELECTRICAL EQUIPMENT.
 7. MECHANICAL CONTRACTOR TO PROVIDE REFRIGERANT SENSORS FOR REFRIGERANT 123. SENSORS SHALL BE INSTALLED PER MANUFACTURERS RECOMMENDATIONS.
 8. MECHANICAL CONTRACTOR TO PROVIDE NEW REFRIGERANT MONITORING SYSTEM. SEE SPECIFICATION FOR REQUIREMENTS.
 9. MECHANICAL CONTRACTOR TO PROVIDE AN AUDIBLE ALARM KIT AND FLASHING STROBE. THIS AUDIBLE ALARM SHALL BE CAPABLE OF 90 DBA AT 2 FEET.
 10. MECHANICAL CONTRACTOR TO PROVIDE NEW FAN COIL UNIT HUNG FROM ABOVE.
 11. MECHANICAL CONTRACTOR TO PROVIDE STEEL PIPING HANGERS FROM STEEL SUPPORT STRUCTURE FOR PIPING SUPPORT. COORDINATE WITH TRUSS AND EQUIPMENT.
 12. MECHANICAL CONTRACTOR TO INSTALL OWNER FINISHED CHILLERS AND PUMPS.
 13. MECHANICAL CONTRACTOR TO PROVIDE NEW AIR SEPARATOR AND EXPANSION TANK.
 14. PLUMBING CONTRACTOR TO PROVIDE NEW STAINLESS STEEL SINK FOR CHEMICAL TESTING. SEE PLUMBING DRAWINGS FOR DETAILS AND SPECIFICATIONS.
 15. PLUMBING CONTRACTOR TO PROVIDE NEW EMERGENCY EYE WASH AND SHOWER NEXT TO NEW STAINLESS STEEL SINKS. SEE PLUMBING DRAWINGS FOR DETAILS AND SPECIFICATIONS.
 16. TERMINATE 32"x32" EXHAUST DUCTING 12" ABOVE FINISHED FLOOR. PROVIDE 4 24"x24" OPENINGS IN EACH SIDE OF DUCT LOCATED 4" ABOVE BOTTOM OF DUCT. PROVIDE CURB DRILL AT EACH OPENING.
 17. SYSTEM 10 FLOW METER CONTROL PANEL.
 18. MECHANICAL CONTRACTOR PROVIDE 8" PPE TAPS AND VALVES FOR SIDE STREAM FILTER.
 19. PROVIDE INJECTION THE CHEMICAL TREATMENT WITH PUMP, BARREL AND ASSOCIATED PIPING FOR THE CLOSED LOOP CHILLED WATER.
 20. MECHANICAL CONTRACTOR TO INSTALL CHLORINE TANK, SUPPLY PUMP AND PIPING TO WATER TREATMENT SYSTEM. UNDERGROUND PPE DUCTING FOR CHLORINE INJECTION TUBING TO WADING STATION.
 21. MECHANICAL CONTRACTOR TO PROVIDE 70 CFM BATH FAN, 4" GALVANIZED STEEL DUCTING AND WALL CAP.
 22. MECHANICAL CONTRACTOR TO PROVIDE TO CHL BATH FAN, 4" GALVANIZED STEEL DUCTING AND WALL CAP.
 23. CHEMICAL CONTRACTOR TO PROVIDE CONDENSER WATER CHEMICAL TREATMENT FOR COOLING TOWERS. PROVIDE MAINTENANCE BEAMER CONDUIT FOR CONDENSER WATER SYSTEM. SEE CHEMICAL TREATMENT ARRANGEMENT DETAIL FOR MORE INFORMATION. MOUNT CONTROLLER AT EYE LEVEL ON WALL.
 24. CHEMICAL CONTRACTOR TO PROVIDE REQUIRED WATER TREATMENT CHEMICALS FOR COOLING TOWERS. AND CLOSED WATER SYSTEM PER MACHO REQUIREMENTS.
 25. MECHANICAL CONTRACTOR TO PROVIDE PREINSULATED UNDERGROUND PPE STUBS SIZED AS SHOWN. TERMINATE STUBS AT EACH END WITH BLIND FLANGES. LOCATE INTERIOR FLANGES 10" A.F.F.
 26. CONSTRUCTION MANAGER TO PROVIDE TRUSS BUILDING CONTROL UNIT (BUI) TO ALLOW CONTROLS CONTRACTOR A BUCKET PICK-UP POINT FOR THE INTO BANE CONTROLS SYSTEM.
 27. PPE SUPPORT STRUCTURE. SEE STRUCTURAL DRAWING FOR DETAILS.